

Assessment of application against relevant Development Codes

APPLICATION DETAILS

APPLICATION		PREMISES	
FILE NO:	RAL/18/0018	ADDRESS:	Moondani Avenue & Allara Street, Mareeba
APPLICANT:	BTM & S Stankovich Pty Ltd	RPD:	Lot 200 on SP292105
LODGED BY:	Freshwater Planning Pty Ltd	AREA:	9.19 hectares
DATE LODGED:	18 May 2018	OWNER :	BTM & S Stankovich Pty Ltd
TYPE OF APPROVAL:	Development Permit		
PROPOSED DEVELOPMENT:	Reconfiguring a Lot - Subdivision (1 into 25 lots and balance area)		
PLANNING SCHEME:	Mareeba Shire Council Planning Scheme 2016		
ZONE:	Low Density Residential zone		
LEVEL OF ASSESSMENT:	Code Assessment		
SUBMISSIONS:	n/a		

Relevant Development Codes

The following Development Codes are considered to be applicable to the assessment of the application:

- 6.2.6 Low density residential zone code
- 7.2.2 Mareeba local plan code
- 8.2.2 Airport environs overlay code
- 8.2.12 Transport infrastructure overlay code
- 9.4.2 Landscaping code
- 9.4.3 Parking and access code
- 9.4.4 Reconfiguring a lot code
- 9.4.5 Works, services and infrastructure code

6.2.6 Low density residential zone code

6.2.6.1 Application

- (1) This code applies to assessing development where:
 - (a) located in the Low density residential zone; and
 - (b) it is identified in the assessment benchmarks for assessable development and requirements for accepted development column of an assessment table in Part 5 of the planning scheme.

6.2.6.2 Purpose

- (1) The purpose of the Low density residential zone code is to provide for predominantly dwelling houses supported by community uses and small-scale services and facilities that cater for local residents.
- (2) Mareeba Shire Council's purpose of the Low density residential zone code is to:
 - (a) maintain the integrity of established residential areas, which are characterised primarily by Dwelling houses and Dual occupancy development;
 - (b) provide opportunities for other forms of residential development where existing character and amenity will not be compromised; and
 - (c) facilitate non-residential development that directly supports the day to day needs of the immediate residential community, in new residential areas.
- (3) The purpose of the code will be achieved through the following overall outcomes:
 - (a) The dominant form of development is detached dwelling houses, on a range of lot sizes;
 - (b) In greenfield areas, in proximity to activity centres, a wider range of higher density residential development may occur where existing low density residential amenity is not compromised;
 - (c) High quality Residential care facilities and Retirement facilities are located on larger sites;
 - (d) Development provides for an efficient land use pattern and is well connected to other developments;
 - (e) Development is designed to provide safe and walkable neighbourhoods that connect residents to desirable destinations including schools, parks, shops and community facilities;
 - (f) Development facilitates other small-scale uses that integrate personal employment and residential activities, provided they complement local residential amenity;
 - (g) Development maintains a high level of residential amenity avoiding uses that introduce impacts associated with noise, hours of operation, traffic, advertising devices, visual amenity, privacy, lighting, odour and emissions;
 - (h) Development reflects and enhances the existing low density scale and character of the area;
 - (i) Development is supported by necessary transport infrastructure which is designed to provide and promote safe and efficient public transport use, walking and cycling;
 - (j) Development is supported by necessary community facilities, open space and recreational areas and appropriate infrastructure to meet the needs of the local community;
 - (k) Non-residential development may be supported in new residential areas where such uses directly support the day to day needs of the immediate residential community;
 - (l) Development takes account of the environmental constraints of the land; and

- (m) Any unavoidable impacts are minimised through location, design, operation and management requirements.

6.2.6.3 Criteria for assessment

Table 6.2.6.3A—Low density residential zone code - For accepted development subject to requirements and assessable development

Performance outcomes	Acceptable outcomes	Complies	Comments
For accepted development subject to requirements and assessable development			
Height			
<p>PO1 Building height takes into consideration and respects the following:</p> <ul style="list-style-type: none"> (a) the height of existing buildings on adjoining premises; (b) the development potential, with respect to height, on adjoining premises; (c) the height of buildings in the vicinity of the site; (d) access to sunlight and daylight for the site and adjoining sites; (e) privacy and overlooking; and (f) site area and street frontage length. 	<p>AO1 Development has a maximum building height of:</p> <ul style="list-style-type: none"> (a) 8.5 metres; and (b) 2 storeys above ground level. 	n/a	Not applicable - The proposed development is for reconfiguring a lot only. No new buildings or structures are proposed.
Outbuildings and residential scale			
<p>PO2 Domestic outbuildings:</p> <ul style="list-style-type: none"> (a) do not dominate the lot on which they are located; and (b) are consistent with the scale and character of development in the Low-density residential zone. 	<p>AO2 Domestic outbuildings do not exceed:</p> <ul style="list-style-type: none"> (a) 100m² in gross floor area; and (b) 5.5 metres in height above natural ground level. 	n/a	Not applicable - The proposed development is for reconfiguring a lot only. No new buildings or structures are proposed.
Siting			

Performance outcomes	Acceptable outcomes	Complies	Comments
<p>PO3 Development is sited in a manner that considers and respects:</p> <p>(a) the siting and use of adjoining premises;</p> <p>(b) access to sunlight and daylight for the site and adjoining sites;</p> <p>(c) privacy and overlooking;</p> <p>(d) opportunities for casual surveillance of adjoining public spaces;</p> <p>(e) air circulation and access to natural breezes; and</p> <p>(f) appearance of building bulk; and</p> <p>(g) relationship with road corridors.</p>	<p>AO3.1 Buildings and structures include a minimum setback of:</p> <p>(a) 6 metres from the primary road frontage; and</p> <p>(b) 3 metres from any secondary road frontage.</p>	n/a	Not applicable - The proposed development is for reconfiguring a lot only. No new buildings or structures are proposed.
	<p>AO3.2 Buildings and structures include a minimum setback of 2 metres from side and rear boundaries.</p>	n/a	Not applicable - The proposed development is for reconfiguring a lot only. No new buildings or structures are proposed.
Accommodation density			
<p>PO4 The density of Accommodation activities:</p> <p>(a) contributes to housing choice and affordability;</p> <p>(b) respects the nature and density of surrounding land use;</p> <p>(c) does not cause amenity impacts beyond the reasonable expectation of accommodation density for the zone; and</p> <p>(d) is commensurate to the scale and frontage of the site.</p>	<p>AO4 Development provides a maximum density for Accommodation activities in compliance with Table 6.2.6.3B.</p>	n/a	Not applicable - The proposed development is for reconfiguring a lot only. No new buildings or structures are proposed.
Gross floor area			

Performance outcomes	Acceptable outcomes	Complies	Comments
<p>PO5 Buildings and structures occupy the site in a manner that:</p> <ul style="list-style-type: none"> (a) makes efficient use of land; (b) is consistent with the bulk and scale of surrounding buildings; and (c) appropriately balances built and natural features. 	<p>AO5 Gross floor area does not exceed 600m².</p>	n/a	Not applicable - The proposed development is for reconfiguring a lot only. No new buildings or structures are proposed.
For assessable development			
Building design			
<p>PO6 Building facades are appropriately designed to:</p> <ul style="list-style-type: none"> (a) include visual interest and architectural variation; (b) maintain and enhance the character of the surrounds; (c) provide opportunities for casual surveillance; (d) include a human scale; and (e) encourage occupation of outdoor space. 	<p>AO6 Buildings include habitable space, pedestrian entrances and recreation space facing the primary road frontage.</p>	n/a	Not applicable - The proposed development is for reconfiguring a lot only. No new buildings or structures are proposed.
<p>PO7 Development complements and integrates with the established built character of the Low density residential zone, having regard to:</p> <ul style="list-style-type: none"> (a) roof form and pitch; (b) eaves and awnings; (c) building materials, colours and textures; and 	<p>AO7 No acceptable outcome is provided.</p>	n/a	Not applicable - The proposed development is for reconfiguring a lot only. No new buildings or structures are proposed.

Performance outcomes	Acceptable outcomes	Complies	Comments
(d) window and door size and location.			
Non-residential development			
<p>PO8 Non-residential development is only located in new residential areas and:</p> <ul style="list-style-type: none"> (a) is consistent with the scale of existing development; (b) does not detract from the amenity of nearby residential uses; (c) directly supports the day to day needs of the immediate residential community; and (d) does not impact on the orderly provision of non-residential development in other locations in the shire. 	<p>AO8 No acceptable outcome is provided.</p>	n/a	Not applicable - The proposed development is for reconfiguring a lot only. No new buildings or structures are proposed.
Amenity			
<p>PO9 Development must not detract from the amenity of the local area, having regard to:</p> <ul style="list-style-type: none"> (a) noise; (b) hours of operation; (c) traffic; (d) advertising devices; (e) visual amenity; (f) privacy; (g) lighting; (h) odour; and (i) emissions. 	<p>AO9 No acceptable outcome is provided.</p>	n/a	Not applicable - The proposed development is for reconfiguring a lot only. No new buildings or structures are proposed.

Performance outcomes	Acceptable outcomes	Complies	Comments
<p>PO10 Development must take into account and seek to ameliorate any existing negative environmental impacts, having regard to:</p> <ul style="list-style-type: none"> (a) noise; (b) hours of operation; (c) traffic; (d) advertising devices; (e) visual amenity; (f) privacy; (g) lighting; (h) odour; and (i) emissions. 	<p>AO10 No acceptable outcome is provided.</p>	n/a	Not applicable - The proposed development is for reconfiguring a lot only. No new buildings or structures are proposed.

Table 6.2.6.3B—Maximum densities for Accommodation activities

Use	Maximum density
Dual occupancy	1 dwelling per 400m ² of site area
Multiple dwelling	(a) 1 dwelling per 400m ² of site area; and (b) 1 bedroom per 200m ² of site area.
Residential care facility	1 dwelling or accommodation unit per 250m ² of site area.
Retirement facility	1 dwelling or accommodation unit per 400m ² of site area

8.2.2 Airport environs overlay code

8.2.2.1 Application

- (1) This code applies to assessing development where:
 - (a) land the subject of development is affected by a constraint category identified on the **Airport environs overlay maps (OM-002a-f)**; and
 - (b) it is identified in the assessment benchmarks for assessable development and requirements for accepted development column of an assessment table in Part 5 of the planning scheme.

Note—Strategic airports and aviation facilities are appropriately reflected in Overlay Map 2 and is required to be mapped by State Government in response to Infrastructure State Interests.

8.2.2.2 Purpose

- (1) The purpose of the Airport environs overlay code is to protect the current and ongoing operations of established airports, aerodromes and aviation infrastructure in Mareeba Shire.
- (2) The purpose of the code will be achieved through the following overall outcomes:
 - (a) The ongoing operation of Mareeba Airport and its associated infrastructure are protected from incompatible development;
 - (b) Aerodromes in Chillagoe and Dimbulah are maintained to support recreation, mining and rural uses;
 - (c) Operational airspace is protected;
 - (d) Threats to aviation safety such as bird and bat strike and distraction or blinding of pilots are avoided or minimised;
 - (e) State significant aviation facilities associated with the Mareeba Airport are protected from encroachment by sensitive land uses; and
 - (f) Development in the vicinity of airports, aerodromes and aviation infrastructure does not compromise public safety.

8.2.2.3 Criteria for assessment

Table 8.2.2.3 - Airport environs overlay code - For accepted development subject to requirements and assessable development

Performance outcomes	Acceptable outcomes	Complies	Comments
For accepted development subject to requirements and assessable development			
Protection of operational airspace			
PO1 Development does not interfere with movement of aircraft or the safe operation of an airport or aerodrome where within the: (a) Airport environs: OLS area of Mareeba Airport identified on Airport environs overlay map (OM-002c) ; or (b) Airport environs: OLS area of Cairns Airport identified on Airport environs overlay map (OM-002c.1) ; or (c) 'Airport environs: Airport buffer - 1 kilometre' of an aerodrome identified on Airport environs overlay map (OM-002f) ; or (d) 'Airport environs: Airport buffer - 3 kilometres' of an aerodrome identified on Airport environs overlay map (OM-002f) .	AO1.1 Development does not exceed the height of the Obstacle Limitation Surface (OLS) where located within the Airport environs: OLS area of: (a) Mareeba Airport identified on Airport environs overlay map (OM-002c) ; or (b) Cairns Airport identified on Airport environs overlay map (OM-002c.1) .	n/a	Not applicable
	AO1.2 Development has a maximum height of 10 metres where within the 'Airport environs: Airport buffer - 1 kilometre' of an aerodrome identified on Airport environs overlay map (OM-002f) .	n/a	Not applicable
	AO1.3 Development has a maximum height of 15 metres where within the 'Airport environs: Airport buffer - 3 kilometres' of an aerodrome identified on Airport environs overlay map (OM-002f) .	n/a	Not applicable
	Lighting		

Performance outcomes	Acceptable outcomes	Complies	Comments
<p>PO2 Development does not include lighting that:</p> <p>(a) has the potential to impact on the efficient and safe operation of Mareeba Airport or an aerodrome; or</p> <p>(b) could distract or confuse pilots.</p>	<p>AO2 Development within the 'Airport environs: Distance from airport - 6 kilometres' area for Mareeba Airport identified on Airport environs overlay map (OM-002b) or the 'Airport environs: Airport buffer - 3 kilometres' of an aerodrome identified on Airport environs overlay map (OM-002f) does not:</p> <p>(a) involve external lighting, including street lighting, that creates straight parallel lines of lighting that are more than 500 metres long; and</p> <p>(b) does not contain reflective cladding upwards shining lights, flashing lights or sodium lights.</p>	n/a	Not applicable
Noise exposure			
<p>PO3 Development not directly associated with Mareeba Airport is protected from aircraft noise levels that may cause harm or undue interference.</p>	<p>AO3 Sensitive land uses are acoustically insulated to at least the minimum standards specified by AS2021 Acoustics - Aircraft Noise Intrusion - Building Siting and Construction where located within the 'Airport environs: 20-25 ANEF' area identified on Airport environs overlay map (OM-002d).</p>	n/a	Not applicable
Public safety			
<p>PO4 Development does not compromise public safety or risk to property.</p>	<p>AO4 Development is not located within the 'Airport environs: Mareeba Airport public safety area' identified on Airport environs overlay map (OM-002e).</p>	n/a	Not applicable
State significant aviation facilities associated with Mareeba Airport			

Performance outcomes	Acceptable outcomes	Complies	Comments
<p>PO5 Development does not impair the function of state significant aviation facilities by creating:</p> <p>(a) physical obstructions; or</p> <p>(b) electrical or electro-magnetic interference; or</p> <p>(c) deflection of signals.</p>	<p>AO5.1 Development within 'Airport environs: Zone B (600 metre buffer)' for the 'Saddle Mountain VHF' facility identified on Airport environs overlay map (OM-002a.1) does not exceed a height of 640 metres AHD.</p>	n/a	Not applicable
	<p>AO5.2 Development within 'Airport environs: Zone B (4,000 metre buffer)' for the 'Hahn Tableland Radar (RSR)' facility identified on Airport environs overlay map (OM-002a) does not exceed a height of 950 metres AHD, unless associated with Hann Tableland Radar facility.</p>	n/a	Not applicable
	<p>AO5.3 Building work does not occur within 'Airport environs: Zone A (200 metre buffer)' of the 'Biboohra CVOR' facility identified on Airport environs overlay map (OM-002a) unless associated with the Biboohra CVOR facility.</p>	n/a	Not applicable

Performance outcomes	Acceptable outcomes	Complies	Comments
	<p>AO5.4 Development within 'Airport environs: Zone B (1,500 metre buffer)' of the 'Biboohra CVOR' facility identified on Airport environs overlay map (OM-002a), but outside 'Zone A (200 metre buffer)' identified on Airport environs overlay map (OM-002a), does not include:</p> <ul style="list-style-type: none"> (a) the creation of a permanent or temporary physical line of sight obstruction above 13 metres in height; or (b) overhead power lines exceeding 5 metres in height; or (c) metallic structures exceeding 7.5 metres in height; or (d) trees and open lattice towers exceeding 10 metres in height; or (e) wooden structures exceeding 13 metres in height. 	n/a	Not applicable
For assessable development			
Mareeba Airport			
Protection of operational airspace			
<p>PO6 Development within the vicinity of Mareeba Airport or an aerodrome does not interfere with the:</p> <ul style="list-style-type: none"> (a) movement of aircraft; or (b) safe operation of the airport or facility. 	<p>AO6.1 Development involving sporting and recreational aviation activities such as parachuting, hot air ballooning or hang gliding, does not occur within the Airport environs: OLS area of:</p> <ul style="list-style-type: none"> (a) Mareeba Airport identified on Airport environs overlay map (OM-002c); or (b) Cairns Airport identified on Airport environs overlay map (OM-002c.1). 	n/a	Not applicable

Performance outcomes	Acceptable outcomes	Complies	Comments
	<p>AO6.2 Development involving temporary or permanent aviation activities does not occur within the 'Airport environs: Airport buffer - 3 kilometres' of an aerodrome identified on Airport environs overlay map (OM-002f).</p>	n/a	Not applicable
<p>PO7 Development does not affect air turbulence, visibility or engine operation in the operational airspace of Mareeba Airport or regional aerodromes.</p>	<p>A07 Development does not result in the emission of a gaseous plume, at a velocity exceeding 4.3 metres per second, or smoke, dust, ash or steam within:</p> <ul style="list-style-type: none"> (a) the Airport environs: OLS area of Mareeba Airport identified on Airport environs overlay map (OM-002c); or (b) the Airport environs: OLS area of Cairns Airport identified on Airport environs overlay map (OM-002c.1); or (c) the 'Airport environs: Airport buffer - 1 kilometre' of a regional aerodrome identified on Airport environs overlay map (OM-002f). 	n/a	Not applicable

Performance outcomes	Acceptable outcomes	Complies	Comments
Managing bird and bat strike hazard to aircraft			
PO8 Development in the environs of Mareeba Airport or an aerodrome does not contribute to the potentially serious hazard from wildlife (bird or bat) strike.	AO8.1 Development within the 'Airport environs: Distance from airport - 8 kilometres' Bird and bat strike zone of Mareeba Airport identified on Airport environs overlay map (OM-002b) or the 'Airport environs: Airport buffer - 3 kilometres' of an aerodrome identified on Airport environs overlay map (OM-002f) provides that potential food and waste sources are covered and collected so that they are not accessible to wildlife.	n/a	Not applicable
	AO8.2 Development within the 'Airport environs: Distance from airport - 3 kilometres' Bird and bat strike zone of Mareeba Airport identified on Airport environs overlay map (OM-002b) or the 'Airport environs: Airport buffer - 1 kilometre' of an aerodrome identified on Airport environs overlay map (OM-002f) does not include: (a) food processing; or (b) abattoir; or (c) intensive horticulture; or (d) intensive animal husbandry; or (e) garden centre; or (f) aquaculture.	n/a	Not applicable

Performance outcomes	Acceptable outcomes	Complies	Comments
	<p>AO8.3 Putrescible waste disposal sites do not occur within the 'Airport environs: Distance from airport - 13 kilometres' Bird and bat strike zone of:</p> <p>(a) Mareeba Airport identified on Airport environs overlay map (OM-002b); or</p> <p>(b) Cairns Airport identified on Airport environs overlay map (OM-002b.1).</p>	✓	<p>Complies - Development is for residential subdivision only and does not propose any use that would create putrescible waste.</p>

9.4.2 Landscaping code

9.4.2.1 Application

This code applies where it is identified in the assessment benchmarks for assessable development and requirements for accepted development column of an assessment table in Part 5 of the planning scheme.

9.4.2.2 Purpose

- (1) The purpose of the Landscaping code is to ensure all development is landscaped to a standard that:
 - (a) complements the scale and appearance of the development;
 - (b) protects and enhances the amenity and environmental values of the site;
 - (c) complements and enhances the streetscape and local landscape character; and
 - (d) ensures effective buffering of incompatible land uses to protect local amenity.
- (2) The purpose of the code will be achieved through the following overall outcomes:
 - (a) Landscaping is a functional part of development design and is commensurate with the intended use;
 - (b) Landscaping accommodates the retention of existing significant on site vegetation where appropriate and practical;
 - (c) Landscaping treatments complement the scale, appearance and function of the development;
 - (d) Landscaping contributes to an attractive streetscape;
 - (e) Landscaping enhances the amenity and character of the local area;
 - (f) Landscaping enhances natural environmental values of the site and the locality;
 - (g) Landscaping provides effective screening both on site, if required, and between incompatible land uses;
 - (h) Landscaping provides shade in appropriate circumstances;
 - (i) Landscape design enhances personal safety and reduces the potential for crime and vandalism; and
 - (j) Intensive land uses incorporate vegetated buffers to provide effective screening of buildings, structures and machinery associated with the use.

9.4.2.3 Criteria for assessment

Table 9.4.2.3A—Landscaping code - For accepted development subject to requirements and assessable development

Performance outcomes	Acceptable outcomes	Complies	Comments
For accepted development subject to requirements and assessable development			
<p>PO1 Development, other than in the Rural zone, includes landscaping that:</p> <ul style="list-style-type: none"> (a) contributes to the landscape character of the Shire; (b) compliments the character of the immediate surrounds; (c) provides an appropriate balance between built and natural elements; and (d) provides a source of visual interest. 	<p>AO1 Development, other than in the Rural zone, provides:</p> <ul style="list-style-type: none"> (a) a minimum of 10% of the site as landscaping; (b) planting in accordance with Planning Scheme Policy 6 - Landscaping and preferred plant species; (c) for the integration of retained significant vegetation into landscaping areas; (d) on-street landscaping works in accordance with the Design Guidelines set out in Section D9 Landscaping, of the Planning Scheme Policy 4 - FNQROC Regional Development Manual. <p>Note—Where development exceeds a site cover of 90%, areas of landscaping may be provided above ground level to achieve a total supply of landscaping equivalent to 10% of the site area.</p>	✓	<p>Not applicable - The proposed development is for reconfiguring a lot only creating 25 new vacant residential lots and 1 balance lot. Landscaping is not considered necessary in this instance.</p>

Performance outcomes	Acceptable outcomes	Complies	Comments
<p>PO2 Development, other than in the Rural zone, includes landscaping along site frontages that:</p> <ul style="list-style-type: none"> (a) creates an attractive streetscape; (b) compliments the character of the immediate surrounds; (c) assists to break up and soften elements of built form; (d) screen areas of limited visual interest or servicing; (e) provide shade for pedestrians; and (f) includes a range and variety of planting. 	<p>AO2 Development, other than in the Rural zone, includes a landscape strip along any site frontage:</p> <ul style="list-style-type: none"> (a) with a minimum width of 2 metres where adjoining a car parking area; (b) with a minimum width of 1.5 metres in all other locations; and (c) in accordance with Planning Scheme Policy 6 - Landscaping and preferred plant species. <p>Note—Where development is setback from a frontage less than 1.5 metres, the setback area is provided as a landscape strip</p>	n/a	Not applicable - See comment for AO1 above.
<p>PO3 Development includes landscaping and fencing along side and rear boundaries that:</p> <ul style="list-style-type: none"> (a) screens and buffer land uses; (b) assists to break up and soften elements of built form; (c) screens areas of limited visual interest; (d) preserves the amenity of sensitive land uses; and (e) includes a range and variety of planting. 	<p>AO3.1 Development provides landscape treatments along side and rear boundaries in accordance with Table 9.4.2.3B.</p>	n/a	Not applicable - See comment for AO1 above.
	<p>AO3.2 Shrubs and trees provided in landscape strips along side and rear boundaries:</p> <ul style="list-style-type: none"> (a) are planted at a maximum spacing of 1 metre; (b) will grow to a height of at least 2 metres; (c) will grow to form a screen of no less than 2 metres in height; and (d) are mulched to a minimum depth of 0.1 metres with organic mulch. 	n/a	Not applicable - See comment for AO1 above.

Performance outcomes	Acceptable outcomes	Complies	Comments
	<p>AO3.3 Any landscape strip provided along a side or rear boundary is designed in accordance with Planning Scheme Policy 6 - Landscaping and preferred plant species.</p>	n/a	Not applicable - See comment for AO1 above.
<p>PO4 Car parking areas are improved with a variety of landscaping that:</p> <p>(a) provides visual interest;</p> <p>(b) provides a source of shade for pedestrians;</p> <p>(c) assists to break up and soften elements; and</p> <p>(d) improves legibility.</p>	<p>AO4.1 Landscaping is provided in car parking areas which provides:</p> <p>(a) a minimum of 1 shade tree for every 4 parking spaces, or part thereof, where the car parking area includes 12 or more spaces;</p> <p>(b) a minimum of 1 shade tree for every 6 parking spaces, or part thereof, otherwise; and</p> <p>(c) where involving a car parking area in excess of 500m²:</p> <p>(i) shade structures are provided for 50% of parking spaces; and</p> <p>(ii) a minimum of 10% of the parking area as landscaping.</p> <p>Note—Where a shade structure is provided over part of a car parking area, shade tree planting is not required in this area of the car parking area.</p>	n/a	Not applicable - See comment for AO1 above.
	<p>AO4.2 Landscaping in car parking areas is designed in accordance with Planning Scheme Policy 6 - Landscaping and preferred plant species.</p>	n/a	Not applicable - See comment for AO1 above.
<p>PO5 Landscaping areas include a range and variety of planting that:</p> <p>(a) is suitable for the intended purpose</p>	<p>AO5.1 Plant species are selected from the Plant Schedule in Planning Scheme Policy 6 - Landscaping and preferred plant species.</p>	n/a	Not applicable - See comment for AO1 above.

Performance outcomes	Acceptable outcomes	Complies	Comments
and local conditions; (b) contributes to the natural character of the Shire; (c) includes native species; (d) includes locally endemic species, where practical; and (e) does not include invasive plants or weeds.	AO5.2 A minimum of 25% of (new and existing) plants is provided as larger, advanced stock with a minimum plant height of 0.7 metres and mulched to a minimum depth of 0.1 metres with organic mulch.	n/a	Not applicable - See comment for AO1 above.
PO6 Landscaping does not impact on the ongoing provision of infrastructure and services to the Shire.	AO6.1 Tree planting is a minimum of (a) 2 metres from any underground water, sewer, gas, electricity or telecommunications infrastructure; and (b) 4 metres from any inspection chamber.	n/a	Not applicable - See comment for AO1 above.
	AO6.2 Vegetation below or within 4 metres of overhead electricity lines and power poles has a maximum height of 3.5 metres at maturity.	n/a	Not applicable - See comment for AO1 above.
	AO6.3 Vegetation adjoining an electricity substation boundary, at maturity, will have: (a) a height of less than 4 metres; and (b) no foliage within 3 metres of the substation boundary, unless the substation has a solid wall along any boundary.	n/a	Not applicable - See comment for AO1 above.
For assessable development			

Performance outcomes	Acceptable outcomes	Complies	Comments
<p>PO7 Landscaping areas are designed to:</p> <ul style="list-style-type: none"> (a) be easily maintained throughout the ongoing use of the site; (b) allow sufficient area and access to sunlight and water for plant growth; (c) not cause a nuisance to occupants of the site or members of the public; and (d) maintain or enhance the safety of pedestrians through the use of Crime Prevention Through Environmental Design principles. 	<p>AO7 No acceptable outcome is provided.</p>	<p>n/a</p>	<p>Not applicable - See comment for AO1 above.</p>

Table 9.4.2.3B—Side and rear boundary landscape treatments

Location or use	Landscape Strip Minimum Width	Screen Fencing Minimum Height	Extent of treatment
Where car parking, servicing or manoeuvring areas adjoin a side or rear boundary	1 metre	Not applicable	To the extent these areas adjoin the boundary
Where involving a use other than a dwelling house on a site with a common boundary with land in the Low density residential zone, the Medium density residential zone or the Rural residential zone:	1.5 metres	1.8 metres	Along the common boundary.
Development for an industrial activity which has a common boundary with land not within the Industry zone	2 metres	1.8 metres	Along the common boundary
Development involving (a) Tourist park not in the Rural zone (b) Sales office (c) Multiple dwelling (d) Residential care facility; or (e) Dual occupancy	Not applicable	1.8 metres	Along all side and rear boundaries and between dwellings for a Dual occupancy.
Development involving (a) Tourist park in the Rural zone (b) Service station (c) Car wash; or (d) Utility installation	2 metres	Not applicable	Along all side and rear boundaries
For: (a) waste storage; (b) equipment; (c) servicing areas; and (d) private open space and site facilities associated with Caretaker's accommodation.	Not applicable	1.8 metres	To prevent visibility

Note—Where more than one landscape treatment is applicable to a development in the above table, the development is to provide a landscape treatment that satisfies all applicable minimum specifications.

9.4.3 Parking and access code

9.4.3.1 Application

This code applies to assessing development where it is identified in the assessment benchmarks for assessable development and requirements for accepted development column of an assessment table in Part 5 of the planning scheme.

9.4.3.2 Purpose

- (1) The purpose of the Parking and access code is to ensure:
 - (a) parking areas are appropriately designed, constructed and maintained;
 - (b) the efficient functioning of the development and the local road network; and
 - (c) all development provides sufficient parking, loading/service and manoeuvring areas to meet the demand generated by the use.

- (2) The purpose of the code will be achieved through the following overall outcomes:
 - (a) Land uses have a sufficient number of parking and bicycle spaces designed in a manner to meet the requirements of the user;
 - (b) Parking spaces and associated manoeuvring areas are safe, functional and provide equitable access;
 - (c) Suitable access for all types of vehicles likely to utilise a parking area is provided in a way that does not compromise the safety and efficiency of the surrounding road network;
 - (d) Premises are adequately serviced to meet the reasonable requirements of the development; and
 - (e) End of trip facilities are provided by new major developments to facilitate alternative travel modes.

9.4.3.3 Criteria for assessment

Table 9.4.3.3A—Parking and access code – For accepted development subject to requirements and assessable development

Performance outcomes	Acceptable outcomes	Complies	Comments
For accepted development subject to requirements and assessable development			
Car parking spaces			

Performance outcomes	Acceptable outcomes	Complies	Comments
<p>PO1 Development provides sufficient car parking to accommodate the demand likely to be generated by the use, having regard to the:</p> <ul style="list-style-type: none"> (a) nature of the use; (b) location of the site; (c) proximity of the use to public transport services; (d) availability of active transport infrastructure; and (e) accessibility of the use to all members of the community. 	<p>AO1 The number of car parking spaces provided for the use is in accordance with Table 9.4.3.3B.</p> <p>Note—Car parking spaces provided for persons with a disability are to be considered in determining compliance with AO1.</p>	n/a	Not applicable - The development is for reconfiguring a lot only and does not propose any new uses.
Vehicle crossovers			
<p>PO2 Vehicle crossovers are provided to::</p> <ul style="list-style-type: none"> (a) ensure safe and efficient access between the road and premises; (b) minimize interference with the function and operation of roads; and (c) minimise pedestrian to vehicle conflict. 	<p>AO2.1 Vehicular access to/from Council roads is designed and constructed in accordance with the Standard drawings in Planning Scheme Policy 4 - FNQROC Regional Development Manual.</p>	✓	Access roads will include layback kerbing to negate need for crossovers.
	<p>AO2.2 Development on a site with two or more road frontages provides vehicular access from:</p> <ul style="list-style-type: none"> (a) the primary frontage where involving Community activities or Sport and recreation activities, unless the primary road frontage is a State-controlled road; or (b) from the lowest order road in all other instances. 	✓	Future development on lots with dual frontage will have to comply.

Performance outcomes	Acceptable outcomes	Complies	Comments
	AO2.3 Vehicular access for particular uses is provided in accordance with Table 9.4.3.3E .	n/a	Not applicable
PO3 Access, manoeuvring and car parking areas include appropriate pavement treatments having regard to: (a) the intensity of anticipated vehicle movements; (b) the nature of the use that they service; and (c) the character of the surrounding locality.	AO3 Access, manoeuvring and car parking areas include pavements that are constructed in accordance with Table 9.4.3.3C .	n/a	Not applicable
For assessable development			
Parking area location and design			
PO4 Car parking areas are located and designed to: (a) ensure safety and efficiency in operation; and (b) be consistent with the character of the surrounding locality.	AO4.1 Car parking spaces, access and circulation areas have dimensions in accordance with AS/NZS 2890.1 Off-street car parking.	n/a	Not applicable
	AO4.2 Disabled access and car parking spaces are located and designed in accordance with AS/NZS 2890.6 Parking facilities - Off-street parking for people with disabilities.	n/a	Not applicable
	AO4.3 The car parking area includes designated pedestrian routes that provide connections to building entrances.	n/a	Not applicable

Performance outcomes	Acceptable outcomes	Complies	Comments
	<p>AO4.4 Parking and any set down areas are:</p> <ul style="list-style-type: none"> (a) wholly contained within the site; (b) visible from the street where involving Commercial activities, Community activities, Industrial activities or a use in the Recreation and open space zone; (c) are set back behind the main building line where involving a Dual occupancy, Multiple dwelling, Residential care facility or Retirement facility; and (d) provided at the side or rear of a building in all other instances. 	n/a	Not applicable
Site access and manoeuvring			
<p>PO5 Access to, and manoeuvring within, the site is designed and located to:</p> <ul style="list-style-type: none"> (a) ensure the safety and efficiency of the external road network; (b) ensure the safety of pedestrians; (c) provide a functional and convenient layout; and (d) accommodate all vehicles intended to use the site. 	<p>AO5.1 Access and manoeuvrability is in accordance with :</p> <ul style="list-style-type: none"> (a) AS28901 – Car Parking Facilities (Off Street Parking); and (b) AS2890.2 – Parking Facilities (Off-street Parking) Commercial Vehicle Facilities. <p>Note—Proposal plans should include turning circles designed in accordance with AP34/95 (Austroads 1995) Design Vehicles and Turning Path Templates.</p>	n/a	Not applicable

Performance outcomes	Acceptable outcomes	Complies	Comments
	<p>AO5.2 Vehicular access has a minimum sight distance in accordance with Part 5 of AUSTRROADS.</p>	n/a	Not applicable
	<p>AO5.3 Vehicular access is located and designed so that all vehicles enter and exit the site in a forward gear.</p>	n/a	Not applicable
	<p>AO5.4 Pedestrian and cyclist access to the site: (a) is clearly defined; (b) easily identifiable; and (c) provides a connection between the site frontage and the entrance to buildings and end of trip facilities (where provided).</p>	n/a	Not applicable
<p>PO6 Development that involves an internal road network ensures that it's design: (a) ensure safety and efficiency in operation; (b) does not impact on the amenity of residential uses on the site and on adjoining sites, having regard to matters of: (i) hours of operation; (ii) noise (iii) light; and (iv) odour; (c) accommodates the nature and volume of vehicle movements anticipated to be generated by the use; (d) allows for convenient access to key on-site</p>	<p>AO6.1 Internal roads for a Tourist park have a minimum width of: (a) 4 metres if one way; or (b) 6 metres if two way.</p>	n/a	Not applicable

Performance outcomes	Acceptable outcomes	Complies	Comments
(e) features by pedestrians, cyclists and motor vehicles; and in the Rural zone, avoids environmental degradation.	AO6.2 For a Tourist park, internal road design avoids the use of cul-de-sacs in favour of circulating roads, where unavoidable, cul-de-sacs provide a full turning circle for vehicles towing caravans having: (a) a minimum approach and departure curve radius of 12 metres; and (b) a minimum turning circle radius of 8 metres.	n/a	Not applicable
	AO6.3 Internal roads are imperviously sealed and drained, apart from those for an Energy and infrastructure activity or Rural activity.	✓	Will comply for new roads within the estate.
	AO6.4 Speed control devices are installed along all internal roads, apart from those for an Energy and infrastructure activity or Rural activity, in accordance with Complete Streets.	✓	Can be conditioned to comply where relevant.
	AO6.5 Internal roads, apart from those for an Energy and infrastructure activity or Rural activity, are illuminated in accordance with AS 4282 (as amended) - Control of Obtrusive effects of outdoor lighting.	✓	Can be conditioned to comply where relevant.

Performance outcomes	Acceptable outcomes	Complies	Comments
	<p>AO6.6 Where involving an accommodation activity, internal roads facilitate unobstructed access to every dwelling, accommodation unit, accommodation site and building by emergency services vehicles.</p>	n/a	Not applicable
	<p>AO6.7 For an Energy and infrastructure activity or Rural activity, internal road gradients: (a) are no steeper than 1:5; or (b) are steeper than 1:5 and are sealed.</p>	n/a	Not applicable
Servicing			
<p>PO7 Development provides access, maneuvering and servicing areas on site that: (a) accommodate a service vehicle commensurate with the likely demand generated by the use; (b) do not impact on the safety or efficiency of internal car parking or maneuvering areas; (c) do not adversely impact on the safety or efficiency of the road network; (d) provide for all servicing functions associated with the use; and (e) are located and designed to minimise their impacts on adjoining sensitive land</p>	<p>AO7.1 All unloading, loading, service and waste disposal areas are located: (a) on the site; (b) to the side or rear of the building, behind the main building line; (c) not adjacent to a site boundary where the adjoining property is used for a sensitive use.</p>	n/a	Not applicable
	<p>AO7.2 Unloading, loading, service and waste disposal areas allow service vehicles to enter and exit the site in a forward gear.</p>	n/a	Not applicable

Performance outcomes	Acceptable outcomes	Complies	Comments
uses and streetscape quality.	A07.3 Development provides a servicing area, site access and maneuvering areas to accommodate the applicable minimum servicing vehicle specified in Table 9.4.3.3B .	n/a	Not applicable
Maintenance			
PO8 Parking areas are used and maintained for their intended purpose.	A08.1 Parking areas are kept and used exclusively for parking and are maintained in a suitable condition for parking and circulation of vehicles.	n/a	Not applicable
	A08.2 All parking areas will be compacted, sealed, drained, line marked and maintained until such time as the development ceases.	n/a	Not applicable
End of trip facilities			
PO9 Development within the Centre zone; Industry zone or Emerging community zone provides facilities for active transport users that: (a) meet the anticipated demand generated from the use; (b) comprise secure and convenient bicycle parking and storage; and (c) provide end of trip facilities for all active transport users.	A09.1 The number of bicycle parking spaces provided for the use is in accordance with Table 9.4.3.3D .	n/a	Not applicable
	A09.2 End of trip facilities are provided in accordance with Table 9.4.3.3D .	n/a	Not applicable
If for Educational establishment or Child care centre where involving more than 100 vehicle movements per day or Renewable energy facility, Sport and recreation activities or Tourist park			

Performance outcomes	Acceptable outcomes	Complies	Comments
<p>PO10 The level of traffic generated by the development on the surrounding local road network must not result in unacceptable impacts on adjacent land and local road users.</p>	<p>AO10 A traffic impact report is prepared by a suitably qualified person that identifies:</p> <ul style="list-style-type: none"> (a) the expected traffic movements to be generated by the facility; (b) any associated impacts on the road network; and (c) any works that will be required to address the identified impacts. 	n/a	Not applicable
<p>If for Educational establishment or Child care centre where involving more than 100 vehicle movements per day or Renewable energy facility, Sport and recreation activities or Tourist park</p>			
<p>PO11 The level of traffic generated by the development on the surrounding local road network must not result in unacceptable impacts on adjacent land and local road users.</p>	<p>AO11 A traffic impact report is prepared by a suitably qualified person that identifies:</p> <ul style="list-style-type: none"> (d) the expected traffic movements to be generated by the facility; (e) any associated impacts on the road network; and (f) any works that will be required to address the identified impacts. 	n/a	Not applicable

Table 9.4.3.3B—Vehicle Parking and Service Vehicle Space Requirements

Definition	Minimum number of Car parking spaces	Minimum Service Vehicle Space Provision
Adult store	<p><u>Inside the Centre zone:</u> One space per 50m² or part thereof of GFA up to 400m² GFA, and one space per 20m² or part thereof of GFA above 400m².</p> <p><u>Outside the Centre zone:</u> One space per 25m² or part thereof of GFA up to 400m² GFA, and one space per 10m² or part thereof of GFA above 400m².</p>	One SRV space.
Agricultural supplies store	<p><u>Inside the Centre zone:</u> One space per 50m² or part thereof of GFA up to 400m² GFA, and one space per 15m² or part thereof of GFA above 400m².</p> <p><u>Outside the Centre zone:</u> One space per 30m² or part thereof of GFA up to 400m² GFA, and one space per 10m² or part thereof of GFA above 400m².</p> <p>Queuing for 3 vehicles should be supplied where a GFA is greater than 600m².</p>	One HRV space.
Air services	<p><u>If accepted development subject to requirements development:</u> One space per 90m² or part thereof of net lettable area; or</p> <p><u>If Assessable development:</u> As determined by Council.</p>	<p><u>If accepted development subject to requirements:</u> One space per 200m² or part thereof of net lettable area.</p> <p><u>If assessable development:</u> As determined by Council.</p>

Definition	Minimum number of Car parking spaces	Minimum Service Vehicle Space Provision
Animal husbandry	<p><u>If accepted development subject to requirements :</u> One space.</p> <p><u>If assessable development:</u> As determined by Council.</p>	<p><u>If accepted development subject to requirements:</u> Nil.</p> <p><u>If assessable development:</u> As determined by Council.</p>
Animal keeping	Minimum of three spaces or one space per 200m ² of use area, whichever is greater.	One SRV space.
Aquaculture	<p><u>If accepted development subject to requirements:</u></p> <ul style="list-style-type: none"> • In the rural or rural residential zones - two spaces; or • Enclosed within a building - one space per 90m² of net lettable area. <p><u>If assessable development:</u> As determined by Council.</p>	<p><u>If accepted development subject to requirements:</u> Nil.</p> <p><u>If assessable development:</u> As determined by Council.</p>
Brothel	As determined by Council.	As determined by Council.
Bulk landscape supplies	Minimum of five spaces or one space per 250m ² of use area, whichever is greater.	One AV if the site has an area of greater than 2,000m ² ; or One HRV space.
Car wash	Minimum of two parking spaces plus 1 car queuing space for each car wash or service bay and parking at rates applicable to ancillary use/s.	One AV space.
Caretaker's accommodation	One space per dwelling unit.	Nil.
Cemetery	As determined by Council.	As determined by Council.
Child care centre	A minimum of 3 spaces will be required to be used for setting down and picking up of children, plus one space per 10 children for staff parking.	One SRV space.

Definition	Minimum number of Car parking spaces	Minimum Service Vehicle Space Provision
Club	Minimum of 5 spaces per use or one space per 25m ² or part thereof of GFA, whichever is greater.	One SRV space; and One HRV space if greater than 500m ² .
Community care centre	Minimum of 5 spaces per use or one space per 25m ² or part thereof of GFA, whichever is greater.	One SRV space.
Community residence	Three spaces.	Nil.
Community use	Minimum of 5 spaces per use or one space per 50m ² or part thereof of GFA, whichever is greater.	One SRV space if greater than 500m ² GFA.
Crematorium	One space per 30m ² GFA or part thereof.	As determined by Council.
Cropping	<p><u>If accepted development subject to requirements:</u> Two spaces.</p> <p><u>If assessable development:</u> As determined by Council.</p>	<p><u>If accepted development subject to requirements:</u> Nil.</p> <p><u>If assessable development:</u> As determined by Council.</p>
Detention facility	As determined by Council.	As determined by Council.
Dual occupancy	One covered space per dwelling; and One visitor space.	Nil.
Dwelling house	One covered space per dwelling house. One space per secondary dwelling.	Nil.
Dwelling unit	<p>One covered space per dwelling unit.</p> <p>A minimum of 0.25 spaces per dwelling is to remain in common property for visitor use.</p>	Nil

Definition	Minimum number of Car parking spaces	Minimum Service Vehicle Space Provision
Educational establishment	<p>For all establishments: 1 space per every 10 students plus 1 space per employee, and</p> <p>Provision for 3 vehicles for loading and unloading of passengers in addition to the requirements above.</p>	<p>For <u>accepted development subject to requirements:</u> One HRV space; and One SRV space; and A minimum of 3 Bus / coach parking / set down areas.</p> <p>For <u>assessable development:</u> As determined by Council.</p>
Emergency services	Minimum of 5 spaces per use or one space per 25m ² or part thereof of GFA, whichever is greater.	As determined by Council.
Environment facility	As determined by Council.	As determined by Council.
Extractive industry	As determined by Council.	As determined by Council.
Food and drink outlet	<p>Accepted in an existing building within the Centre zone.</p> <p><u>Inside the Centre zone:</u> One space per 50m² or part thereof of GFA up to 400m² GFA and one space per 15m² or part thereof of GFA above 400m².</p> <p><u>Outside the Centre zone:</u> One space per 25m² or part thereof of GFA up to 400m² GFA and one space per 10m² or part thereof of GFA above 400m².</p> <p><u>Drive-through:</u> Queuing spaces for 6 passenger vehicles within the site boundaries.</p> <p>One service vehicle space per use or one service vehicle space per 1,000m² GFA, whichever is greater.</p>	One HRV space.

Definition	Minimum number of Car parking spaces	Minimum Service Vehicle Space Provision
Function facility	One space per 30m ² or part thereof of GFA.	One SRV space.
Funeral parlour	<p>Accepted in an existing building within the Centre zone.</p> <p><u>Inside the Centre zone:</u> One space per 20m² or part thereof of GFA up to 400m² GFA, and one space per 10m² or part thereof of GFA above 400m².</p> <p><u>Outside the Centre zone:</u> One space per 25m² or part thereof of GFA up to 400m² GFA, and one space per 15m² or part thereof of GFA above 400m².</p>	One SRV space.
Garden centre	<p>A minimum of 5 spaces for customer parking or one space per 150m² or part thereof of use area, whichever is greater.</p> <p>One service vehicle space per use or one service vehicle space per 800m² use area, whichever is greater.</p>	One AV if the site has an area of greater than 2,000m ² , otherwise One HRV space.
Hardware and trade supplies	<p>Accepted in an existing building within the Centre zone.</p> <p><u>Inside the Centre zone:</u> One space per 50m² or part thereof of GFA up to 400m² GFA, and one space per or part thereof of GFA above 400m².</p> <p><u>Outside the Centre zone:</u> One space per or part thereof of GFA up to 400m² GFA, and one space per 15m² or part thereof of GFA above 400m².</p>	One AV if the site has an area of greater than 2,000m ² , otherwise One HRV space.
Health care services	<p>Accepted in an existing building within the Centre zone.</p> <p><u>Inside the Centre zone:</u> One space per 40m² or part thereof of net lettable area.</p> <p><u>Outside the Centre zone:</u> One space per 20m² of or part thereof of net lettable area.</p>	One SRV space per 500m ² GFA.

Definition	Minimum number of Car parking spaces	Minimum Service Vehicle Space Provision
High industry impact	One space per 90m ² GFA or part thereof.	One AV space if the site has an area greater than 2,000m ² , otherwise One HRV.
Home business based	<u>Bed and breakfasts:</u> One space per guest room. <u>Other home based business:</u> One space for home based business and one covered space for the dwelling.	Nil.
Hospital	One space per 6 residential care beds. One space per 4 hostel unit beds. Visitor parking at 30% of resident parking requirements.	One HRV space. One SRV for every 800m ² of GFA and part thereof; and One space for an emergency vehicle.
Hotel	One space per 10m ² or part thereof of GFA per bar, beer garden and other public area. One space per 50m ² or part thereof of GFA per bulk liquor sales area. One space per guest room.	One HRV space.
Indoor sport and recreation	<u>If accepted development subject to requirements:</u> One space per 25m ² of net lettable area. <u>If assessable development:</u> As determined by Council.	An internal bus set down and pick up area that enables the bus to be in a forward motion at all times whilst onsite Internal dedicated taxi bays provided within 200 metres of the site entrance.

Definition	Minimum number of Car parking spaces	Minimum Service Vehicle Space Provision
Intensive animal industries	<p><u>If accepted development subject to requirements:</u> Two spaces.</p> <p><u>If assessable development:</u> As determined by Council.</p>	One SRV space.
Intensive horticulture	<p><u>If accepted development subject to requirements:</u> Two spaces.</p> <p><u>If assessable development:</u> As determined by Council.</p>	<p><u>If accepted development subject to requirements:</u> Nil.</p> <p><u>If assessable development:</u> As determined by Council.</p>
Landing	As determined by Council.	As determined by Council.
Low impact industry	One space per 90m ² GFA or part thereof.	One AV space if the site has an area greater than 2,000m ² , otherwise One HRV.
Major electricity infrastructure	As determined by Council.	As determined by Council.
Major sport, recreation and entertainment facility	As determined by Council.	As determined by Council.
Marine industry	One space per 90m ² GFA or part thereof.	One HRV space if the site has an area greater than 1,000m ² , otherwise One SRV space.
Market	As determined by Council.	As determined by Council.
Medium impact industry	One space per 90m ² GFA or part thereof.	One AV space if the site has an area greater than 2,000m ² , otherwise One HRV.

Definition	Minimum number of Car parking spaces	Minimum Service Vehicle Space Provision
Motor sport facility	As determined by Council.	As determined by Council.
Multiple dwelling	<p>One covered space per dwelling.</p> <p>One dedicated vehicle wash-down bay for premises containing 5 or more dwellings.</p> <p>A minimum of 0.25 spaces per dwelling is to remain in common property for visitor use.</p>	Nil.
Nature-based tourism	One space per dwelling; or 0.75 spaces per guest room if in dormitory or shared facilities.	As determined by Council.
Nightclub entertainment facility	One space per 60m ² GFA or part thereof.	Nil.
Non-resident workforce accommodation	One space per dwelling unit.	Nil.
Office	<p>Accepted in an existing building within the Centre zone.</p> <p><u>Inside the Centre zone:</u> One space per 20m² or part thereof of GFA up to 400m² GFA, and one space per 10m² or part thereof of GFA above 400m².</p> <p><u>Outside the Centre zone:</u> One space per 25m² or part thereof of GFA up to 400m² GFA, and one space per 15m² or part thereof of GFA above 400m².</p>	One SRV space.
Outdoor sales	<p>A minimum of 5 spaces for customer parking or one space per 150m² of use area, whichever is greater.</p> <p>One service vehicle space per use or one service vehicle space per 800m², whichever is greater.</p>	One AV if the site has an area of greater than 2,000m ² , otherwise One HRV space.

Definition	Minimum number of Car parking spaces	Minimum Service Vehicle Space Provision
Outdoor sport and recreation	Coursing, horse racing, pacing or trotting: <ul style="list-style-type: none"> • One space per five seated spectators; plus • One space per 5m² of other spectator areas. Football: <ul style="list-style-type: none"> • 50 spaces per field. Lawn bowls: <ul style="list-style-type: none"> • 30 spaces per green. Swimming pool: <ul style="list-style-type: none"> • 15 spaces; plus • One space per 100m² of useable site area. Tennis or other Court: <ul style="list-style-type: none"> • Four spaces per court. Golf Course: <ul style="list-style-type: none"> • Four spaces per tee on the course; plus • One space per 50m² of net lettable area. <u>Any other use:</u> As determined by council.	An internal bus set down and pick up area that enables the bus to be in a forward motion at all times whilst onsite Internal dedicated taxi bays provided within 200 metres of the site entrance.
Park	As determined by Council.	As determined by Council.
Parking station	Not applicable	Nil.
Permanent plantation	<u>If accepted development subject to requirements:</u> Two spaces. <u>If assessable development:</u> As determined by Council.	<u>If accepted development subject to requirements:</u> Nil. <u>If assessable development:</u> As determined by Council.
Place of worship	Minimum of 5 spaces per use or one space per 25m ² or part thereof of GFA, whichever is greater.	One SRV space.
Port services	As determined by Council.	As determined by Council.
Relocatable home park	One space for each home site plus 1 space for each 5 home sites or part thereof for visitors.	One HRV space.

Definition	Minimum number of Car parking spaces	Minimum Service Vehicle Space Provision
Renewable energy facility	As determined by Council.	As determined by Council.
Research and technology industry	One space per 90m ² GFA or part thereof.	One HRV space if the site has an area greater than 1,000m ² , otherwise One SRV space.
Residential care facility	One space per 4 hostel unit beds. Visitor parking at 30% of resident parking requirements.	One SRV space; and One space for an emergency vehicle.
Resort complex	As determined by Council.	As determined by Council.
Retirement facility	One covered space per unit and 0.5 spaces for visitors parking.	One SRV space; and One space for an emergency vehicle.
Roadside stall	One space per stall.	Nil.
Rooming accommodation	<u>Inside the Centre zone:</u> One space per 15 beds. <u>Outside the Centre zone:</u> One space per 8 beds.	One SRV space. One space for a 20 seater bus.
Rural industry	One space per 90m ² GFA or part thereof.	One AV space.
Rural workers' accommodation	<u>If accepted development subject to requirements:</u> Nil <u>If Assessable development:</u> As determined by Council.	<u>If accepted development subject to requirements:</u> Nil <u>If Assessable development:</u> As determined by Council.
Sales office	One space per 25m ² GFA or part thereof.	Nil.

Definition	Minimum number of Car parking spaces	Minimum Service Vehicle Space Provision
Service industry	<p>Accepted where in an existing building within the Centre zone.</p> <p><u>Inside the Centre zone:</u> One space per 50m² or part thereof of GFA up to 400m² GFA, and one space per 10m² or part thereof of GFA above 400m².</p> <p><u>Outside the Centre zone:</u> One space per 25m² or part thereof of GFA up to 400m² GFA, and one space per 15m² or part thereof of GFA above 400m².</p>	One HRV space if the site is greater than 2,000m ² , otherwise One SRV space.
Service station	Minimum of four spaces plus car parking at rates applicable to ancillary use/s.	One AV space.
Shop	<p>Accepted where in an existing building within the Centre zone.</p> <p><u>Inside the Centre zone:</u> One space per 50m² or part thereof of GFA up to 400m² GFA, and one space per 10m² or part thereof of GFA above 400m².</p> <p><u>Outside the Centre zone:</u> One space per 25m² or part thereof of GFA up to 400m² GFA, and one space per 15m² or part thereof of GFA above 400m².</p>	One HRV space if the site is greater than 2,000m ² , otherwise One SRV space.
Shopping centre	<p><u>Inside the Centre zone:</u> One space per 50m² or part thereof of GFA up to 400m² GFA and one space per 25m² or part thereof of GFA above 400m².</p> <p><u>Outside the Centre zone:</u> One space per 25m² or part thereof of GFA up to 400m² GFA and one space per 15m² or part thereof of GFA above 400m².</p>	One AV space per 1,000m ² ; and One SRV space per 500m ² ; or One SRV space per every 2 specialty uses, whichever the greater.
Short-term accommodation	One space per unit.	One HRV space if involves the serving of food or beverage; otherwise One SRV space.

Definition	Minimum number of Car parking spaces	Minimum Service Vehicle Space Provision
Showroom	<p>Accepted in an existing building within the Centre zone.</p> <p><u>Inside the Centre zone:</u> One space per 25m² or part thereof of GFA up to 400m² GFA, and one space per 10m² or part thereof of GFA above 400m².</p> <p><u>Outside the Centre zone:</u> One space per 50m² or part thereof of GFA up to 400m² GFA, and one space per 15m² or part thereof of GFA above 400m².</p>	One AV space and One SRV space if the site is greater than 2,000m ² ; or One HRV space; and One SRV Space.
Special industry	One space per 90m ² GFA or part thereof.	One AV space if the site has an area greater than 2,000m ² , otherwise One HRV.
Substation	<u>If assessable development:</u> As determined by Council.	As determined by Council.
Telecommunication s facility	<p><u>If accepted development subject to requirements:</u> Nil.</p> <p><u>If assessable development:</u> As determined by Council.</p>	<p><u>If accepted development subject to requirements:</u> Nil.</p> <p><u>If assessable development:</u> As determined by Council.</p>
Theatre	One space per 15m ² or part thereof of net lettable area, or one space per 5 seated spectators whichever is the greater.	One SRV space.
Tourist attraction	As determined by Council.	As determined by Council.

Definition	Minimum number of Car parking spaces	Minimum Service Vehicle Space Provision
Tourist park	<p>One space within each accommodation site plus 1 additional visitor space per 10 accommodation sites.</p> <p>Queuing for 2 vehicles towing caravans and 1 holding bay for a vehicle towing a caravan plus additional queuing for 1 vehicle towing a caravan per 40 accommodation sites.</p>	One HRV space.
Transport depot	One space per 125m ² GFA or part thereof.	One AV space if the site has an area greater than 2,000m ² , otherwise One HRV.
Utility installation	<p><u>If accepted development subject to requirements:</u> Nil.</p> <p><u>If assessable development:</u> As determined by Council.</p>	<p><u>If accepted development subject to requirements:</u> Nil.</p> <p><u>If assessable development:</u> As determined by Council.</p>
Veterinary services	<p>Accepted in an existing building within the Centre zone.</p> <p><u>Inside Centre zone:</u> One space per 40m² or part thereof of net lettable area.</p> <p><u>Outside Centre zone:</u> One space per 20m² or part thereof of net lettable area.</p>	One HRV space if greater than 500m ² GFA; and One SRV space per 500m ² GFA.
Warehouse	One space per 90m ² GFA or part thereof.	One AV space if the site has an area greater than 2,000m ² , otherwise One HRV.
Wholesale nursery	As determined by Council.	As determined by Council.
Winery	As determined by Council.	As determined by Council.

Note—Any use not herein defined - as determined by Council.

Table 9.4.3.3C—Pavement Standards for Access, Manoeuvring and Car Parking areas

Zone	Compacted Gravel Base (minimum thickness)	Surfacing Options
All development other than dwelling house		
All zones other than the Conservation zone or the Rural zone	75mm	Reinforced concrete with a minimum thickness of: <ul style="list-style-type: none"> • 100mm for parking areas; and • 150mm for access ways.
	150mm	Asphalt with a minimum thickness of 25mm
	150mm	Two coat sprayed bitumen seal
	150mm	Concrete pavers
Conservation zone or Rural zone	Not applicable	Minimum 150mm thickness compacted gravel suitable for all weather and dust free
Dwelling house		
All zones	75mm	Reinforced concrete with a minimum thickness of: <ul style="list-style-type: none"> • 100mm for parking areas; and • 150mm for access ways.
	150mm	Asphalt with a minimum thickness of 25mm
	150mm	Two coat sprayed bitumen seal
	150mm	Concrete pavers
	Not applicable	Minimum 150mm thickness compacted gravel suitable for all weather and dust free

Note—Where more than one surfacing option is listed, any one of the treatments listed may be provided.

Table 9.4.3.3D—Bicycle Parking and End of Trip Facility Requirements

Definition	Minimum number of bicycle parking spaces	Minimum end of trip facilities
Commercial activities	<p>New or redeveloped commercial activities buildings (other than a shopping centre), provide:</p> <ul style="list-style-type: none"> • For employees - secure bicycle storage for 8% of building staff (based on one person per 60m² Gross leasable area). Secure bicycle parking involves a bicycle locker or bicycle rail in a locked compound/cage; and • visitor facilities: <ul style="list-style-type: none"> - one bicycle rack space per 750m² NLA or part thereof; and - bicycle parking, signposted; and adjacent to a major public entrance to the building. 	<p>New or redeveloped commercial activities buildings (other than a shopping centre), provide the following employee facilities, which are continually accessible to employees:</p> <ul style="list-style-type: none"> • accessible showers at the rate of one shower per 10 bicycle spaces provided or part thereof; • changing facilities adjacent to showers; and • secure lockers in the changing facilities for 20% of building staff (based on one person per 60m² GLA to cater for walkers, cyclists and other active users.
Community use	Four spaces per 1,500m ² GFA.	As determined by Council.

Definition	Minimum number of bicycle parking spaces	Minimum end of trip facilities
Educational establishment	<p>New or redeveloped education facilities, provide:</p> <ul style="list-style-type: none"> • For employees - secure bicycle storage for 8% of building staff (based on one person per 75m² GLA). Secure bicycle parking involves a bicycle locker or bicycle rail in a locked compound/cage; and • For students: <ul style="list-style-type: none"> - minimum of 8% of the peak number of students using the building at any one time (with 75% occupancy); and - bicycle storage within 100m of the building front entrance(s); or added to the campus central bicycle storage area. 	<p>New or redeveloped education facilities, provide the following employee facilities, which are continually accessible to employees:</p> <ul style="list-style-type: none"> • accessible showers at the rate of one per 10 bicycle spaces provided or part thereof; • changing facilities adjacent to showers; and • secure lockers in changing facilities for 20% of building staff (based on one person per 75m² GLA) to cater for cyclists, walkers and other active users.
Food & drink outlet	One space per 100m ² GFA.	As determined by Council.
Function facility	One space per 300m ² GFA.	As determined by Council.

Definition	Minimum number of bicycle parking spaces	Minimum end of trip facilities
Health care services	<p>New or redeveloped healthcare facilities, provide the following facilities:</p> <ul style="list-style-type: none"> • For employees - secure bicycle storage for 5% of building staff (based on one person per 75m² GLA). Secure bicycle parking involves a bicycle locker or bicycle rail in a locked compound/cage; and • For visitors: <ul style="list-style-type: none"> - facilities with in-patient accommodation provide one space per each 30 beds; - facilities without in-patient accommodation provide one space per each 4 practitioners; - aged care facilities provide one space per each 60 beds; - In every instance above, provide a minimum of 5 bicycle parking spaces; and - bicycle parking provided: in an accessible location, signposted and within 10m a major public entrance to the building. 	<p>New or redeveloped healthcare facilities, provide the following employee facilities, which are continually accessible to employees:</p> <ul style="list-style-type: none"> • accessible showers at the rate of one per 10 bicycle spaces provided or part thereof; • changing facilities adjacent to showers; and • secure lockers in changing facilities for 20% of building staff (based on one person per 75m² GLA) to cater for cyclists, walkers and other active users.
Hospital	As determined by Council.	As determined by Council.
Indoor sport and recreation	One space per employee plus 1 space per 200m ² GFA	As determined by Council.
Park	As determined by Council.	As determined by Council.
Rooming accommodation	One space per 4 letting rooms.	As determined by Council.

Definition	Minimum number of bicycle parking spaces	Minimum end of trip facilities
Short accommodation term	One space per 4 letting rooms.	As determined by Council.
Shop or Shopping centre	<p>New or redeveloped shopping centres, provide:</p> <ul style="list-style-type: none"> • For employees - secure bicycle storage for 8% of building staff (based on one person per 60m² Gross leasable area). Secure bicycle parking involves a bicycle locker or bicycle rail in a locked compound/cage; and • visitor facilities: <ul style="list-style-type: none"> - one space per 500m² GLA or part thereof for centres under 30,000m²; or - one space per 750m² GLA or part thereof for centres between 30,000m² and 50,000m²; and - bicycle parking is signposted and within 10m of a major public entrance to the building. 	<p>New or redeveloped shopping centres, provide the following employee facilities, which are continually accessible to employees:</p> <ul style="list-style-type: none"> • accessible showers at the rate of one shower per 10 bicycle spaces provided or part thereof; • changing facilities adjacent to showers; and • secure lockers in the changing facilities for 20% of building staff (based on one person per 60m² GLA to cater for walkers, cyclists and other active users.
Theatre	One space per 100m ² GFA.	As determined by Council.

Table 9.4.3.3E—Vehicular Access for Specific Uses

Use	Design
Dwelling house	A secondary dwelling shares a vehicle crossover with the Dwelling house.
Car wash	Site access involves:
Service station	<ul style="list-style-type: none"> (a) a maximum width of 9 metres of any vehicle crossover across a footpath; (b) a minimum separation of 12 metres between any vehicle crossover and a road intersection; (c) a separate entrance and exit; and (d) a minimum separation between vehicle crossovers of 14 metres.

Industrial activities	Each lot is provided with no more than one access point every 15 metres.
Roadside stall	A single vehicular access point is provided to the site.
Tourist park	(a) a single vehicular access point is provided to the site; and (b) no accommodation site has individual vehicular access.

9.4.4 Reconfiguring a lot code

9.4.4.1 Application

- (1) This code applies to assessing development where:
 - (a) for Reconfiguring a lot; and
 - (b) it is identified in the assessment benchmarks for assessable development and requirements for accepted development column of an assessment table in Part 5 of the planning scheme.

9.4.4.2 Purpose

- (1) The purpose of the Reconfiguring a lot code is to ensure that land is:
 - (a) arranged in a manner which is consistent with the intended scale and intensity of development within the area;
 - (b) provided with access to appropriate movement and open space networks; and
 - (c) contributes to housing diversity and accommodates a range of land uses.
- (2) The purpose of the code will be achieved through the following overall outcomes:
 - (a) Subdivision of land achieves the efficient use of land and the efficient provision of infrastructure and transport services;
 - (b) Lots are of a suitable size and shape for the intended or potential use having regard to the purpose and overall outcomes of the relevant zone or precinct.
 - (c) Subdivision of land creates lots with sufficient area and dimensions to accommodate the ultimate use, meet user requirements, protect environmental features and account for site constraints;
 - (d) A range and mix of lot sizes is provided to facilitate a variety of industry and housing types;
 - (e) Subdivision design incorporates a road network that provides connectivity and circulation for vehicles and provide safe and efficient access for pedestrians, cyclists and public transport;
 - (f) Subdivision design provides opportunities for walking and cycling for recreation and as alternative methods of travel;
 - (g) Subdivision of land provides and integrates a range of functional parkland, including local and district parks and open space links for the use and enjoyment of the residents of the locality and the shire;
 - (h) Subdivision of land contributes to an open space network that achieves connectivity along riparian corridors and between areas with conservation values;
 - (i) Subdivision within the Rural zone maintains rural landholdings in viable parcels;
 - (j) Land in historical townships is not reconfigured to be used for urban purposes; and
 - (k) Residential subdivision and greenfield development is designed to consider and respect:
 - i. topography;
 - ii. climate responsive design and solar orientation;
 - iii. efficient and sustainable infrastructure provision;
 - iv. environmental values;
 - v. water sensitive urban design;
 - vi. good quality agricultural land; and
 - vii. the character and scale of surrounding development.

9.4.4.3 Criteria for assessment

Table 9.4.4.3A—Reconfiguring a lot code – For assessable development

Performance outcomes	Acceptable outcomes	Complies	Comments
Area and frontage of lots			
<p>PO1 Lots include an area and frontage that:</p> <ul style="list-style-type: none"> (a) is consistent with the design of lots in the surrounding area; (b) allows the desired amenity of the zone to be achieved; (c) is able to accommodate all buildings, structures and works associated with the intended land use; (d) allow the site to be provided with sufficient access; (e) considers the proximity of the land to: <ul style="list-style-type: none"> (i) centres; (ii) public transport services; and (iii) open space; and (f) allows for the protection of environmental features; and (g) accommodates site constraints. 	<p>AO1.1 Lots provide a minimum area and frontage in accordance with Table 9.4.4.3B.</p>	✓	Complies.
Existing buildings and easements			
<p>PO2 Reconfiguring a lot which contains existing land uses or existing buildings and structures ensures:</p> <ul style="list-style-type: none"> (a) new lots are of sufficient area and dimensions to accommodate existing land uses, buildings and structures; and (b) any continuing use is not compromised by the reconfiguration. 	<p>AO2.1 Each land use and associated infrastructure is contained within its individual lot.</p>	✓	Complies.
	<p>AO2.2 All lots containing existing buildings and structures achieve the setback requirements of the relevant zone.</p>	✓	Complies.

Performance outcomes	Acceptable outcomes	Complies	Comments
<p>PO3 Reconfiguring a lot which contains an existing easement ensures:</p> <p>(a) future buildings, structures and accessways are able to be sited to avoid the easement; and</p> <p>(b) the reconfiguration does not compromise the purpose of the easement or the continued operation of any infrastructure contained within the easement.</p>	<p>AO3 No acceptable outcome is provided.</p>	n/a	Not applicable.
Boundary realignment			
<p>PO4 The boundary realignment retains all attendant and existing infrastructure connections and potential connections.</p>	<p>AO4 No acceptable outcome is provided.</p>	n/a	Not applicable.
Access and road network			
<p>PO5 Access to a reconfigured lot (including driveways and paths) must not have an adverse impact on:</p> <p>(a) safety;</p> <p>(b) drainage;</p> <p>(c) visual amenity;</p> <p>(d) privacy of adjoining premises; and</p> <p>(e) service provision.</p>	<p>AO5 No acceptable outcome is provided.</p>	✓	Complies.

Performance outcomes	Acceptable outcomes	Complies	Comments
<p>PO6 Reconfiguring a lot ensures that access to a lot can be provided that:</p> <ul style="list-style-type: none"> (a) is consistent with that provided in the surrounding area; (b) maximises efficiency and safety; and (c) is consistent with the nature of the intended use of the lot. <p>Note—The Parking and access code should be considered in demonstrating compliance with PO6.</p>	<p>AO6 Vehicle crossover and access is provided in accordance with the design guidelines and specifications set out in Planning Scheme Policy 4 – FNQROC Regional Development Manual.</p>	✓	Complies.
<p>PO7 Roads in the Industry zone are designed having regard to:</p> <ul style="list-style-type: none"> (a) the intended use of the lots; (b) the existing use of surrounding land; (c) the vehicular servicing requirements of the intended use; (d) the movement and turning requirements of B-Double vehicles. <p>Note—The Parking and access code should be considered in demonstrating compliance with PO7.</p>	<p>AO7 No acceptable outcome is provided.</p>	n/a	Not applicable.
Rear lots			
<p>PO8 Rear lots are designed to:</p> <ul style="list-style-type: none"> (a) provide a high standard of amenity for residents and other users of the site; (b) provide a high standard of amenity for adjoining properties; and (c) not adversely affect the safety and efficiency of 	<p>AO8.1 Rear lots are designed to facilitate development that adjoins or overlooks a park or open space.</p>	n/a	Not applicable.
	<p>AO8.2 No more than two rear lots are created behind any lot with a road frontage.</p>	n/a	Not applicable.

Performance outcomes	Acceptable outcomes	Complies	Comments
the road from which access is gained.	<p>AO8.3 Access to lots is via an access strip with a minimum width of:</p> <p>(a) 4 metres where in the Low density residential zone or Medium density residential zone; or (b) 8 metres otherwise.</p>	n/a	Not applicable.
	<p>AO8.4 A single access strip is provided to a rear lot along one side of the lot with direct frontage to the street.</p> <p>Note—Figure A provides further guidance in relation to the desired outcome.</p>	n/a	Not applicable.
	<p>AO8.5 No more than 1 in 10 lots created in a new subdivision are rear lots.</p>	n/a	Not applicable.
	<p>AO8.6 Rear lots are not created in the Centre zone or the Industry zone.</p>	n/a	Not applicable.
Crime prevention and community safety			

Performance outcomes	Acceptable outcomes	Complies	Comments
<p>PO9 Development includes design features which enhance public safety and seek to prevent opportunities for crime, having regard to:</p> <ul style="list-style-type: none"> (a) sightlines; (b) the existing and intended pedestrian movement network; (c) the existing and intended land use pattern; and (d) potential entrapment locations. 	<p>AO9 No acceptable outcome is provided.</p>	✓	Complies.
Pedestrian and cycle movement network			
<p>PO10 Reconfiguring a lot must assist in the implementation of a Pedestrian and cycle movement network to achieve safe, attractive and efficient pedestrian and cycle networks.</p>	<p>AO10 No acceptable outcome is provided.</p>	✓	Complies.
Public transport network			
<p>PO11 Where a site includes or adjoins a future public transport corridor or future public transport site identified through a structure planning process, development:</p> <ul style="list-style-type: none"> (a) does not prejudice the future provision of the identified infrastructure; (b) appropriately treats the common boundary with the future corridor; and (c) provides opportunities to integrate with the adjoining corridor where a it will include an element which will attract pedestrian movement. 	<p>AO11 No acceptable outcome is provided.</p>	n/a	Not applicable.
Residential subdivision			

Performance outcomes	Acceptable outcomes	Complies	Comments
<p>PO12 Residential lots are:</p> <p>(a) provided in a variety of sizes to accommodate housing choice and diversity; and</p> <p>(b) located to increase variety and avoid large areas of similar lot sizes.</p>	<p>AO12 No acceptable outcome is provided.</p>	✓	Complies.
Rural residential zone			
<p>PO13 New lots are only created in the Rural residential zone where land is located within the 4,000m² precinct, the 1 hectare precinct or the 2 hectare precinct.</p>	<p>AO13 No acceptable outcome is provided.</p>	n/a	Not applicable.
Additional provisions for greenfield development only			
<p>PO14 The subdivision design provides the new community with a local identity by responding to:</p> <p>(a) site context</p> <p>(b) site characteristics</p> <p>(c) setting</p> <p>(d) landmarks</p> <p>(e) natural features; and</p> <p>(f) views.</p>	<p>AO14 No acceptable outcome provided.</p>	n/a	Not applicable.
<p>PO15 The road network is designed to provide a high level of connectivity, permeability and circulation for local vehicles, public transport, pedestrians and cyclists.</p>	<p>AO15 No acceptable outcome provided.</p>	n/a	Not applicable.

Performance outcomes	Acceptable outcomes	Complies	Comments
<p>PO16 The road network is designed to:</p> <ul style="list-style-type: none"> (a) minimise the number of cul-de-sacs; (b) provide walkable catchments for all residents in cul-de-sacs; and (c) include open cul-de-sacs heads. <p>Note—Figure B provides further guidance in relation to the desired outcome.</p>	<p>AO16 No acceptable outcome provided.</p>	n/a	Not applicable.
<p>PO17 Reconfiguring a lot provides safe and convenient access to the existing or future public transport network.</p>	<p>AO17 The subdivision locates 90% of lots within 400 metres walking distance of a future public transport route.</p>	n/a	Not applicable.
<p>PO18 The staging of the lot reconfiguration prioritises delivery of link roads to facilitate efficient bus routes.</p>	<p>AO18 No acceptable outcome provided.</p>	n/a	Not applicable.
<p>PO19 Provision is made for sufficient open space to:</p> <ul style="list-style-type: none"> (a) meet the needs of the occupiers of the lots and to ensure that the environmental and scenic values of the area are protected; (b) retain riparian corridors, significant vegetation and habitat areas and provides linkages between those areas; and (c) meet regional, district and neighbourhood open space requirements. 	<p>AO19.1 A minimum of 10% of the site area is dedicated as open space.</p>	n/a	Not applicable.
	<p>AO19.2 A maximum of 30% of the proposed open space can consist of land identified as significant vegetation or riparian corridor buffer.</p>	n/a	Not applicable.

Performance outcomes	Acceptable outcomes	Complies	Comments
<p>PO20 A network of parks and community land is provided:</p> <p>(a) to support a full range of recreational and sporting activities;</p> <p>(b) to ensure adequate pedestrian, cycle and vehicle access;</p> <p>(c) which is supported by appropriate infrastructure and embellishments;</p> <p>(d) to facilitate links between public open spaces;</p> <p>(e) which is co-located with other existing or proposed community infrastructure;</p> <p>(f) which is consistent with the preferred open space network; and</p> <p>(g) which includes a diversity of settings;</p>	<p>AO20 No acceptable outcome is provided.</p>	n/a	Not applicable.

Table 9.4.4.3B—Minimum area and dimensions for Reconfiguring a lot

Zone	Type	Minimum area	Minimum frontage
Centre	All lots	800m ²	20 metres
Community facilities	All lots	Not specified	Not specified
Conservation	All lots	Not specified	Not specified
Emerging community	All lots	10 hectares	100 metres
Low density residential	Where greenfield development and connected to reticulated water and sewerage		
	Rear lot	800m ²	5 metres
	All other lots	350m ²	10 metres
	Where connected to reticulated water and sewerage		
	Rear lot	800m ²	5 metres
	All other lots	600m ²	16 metres
	Where connected to reticulated water		
	Rear lot	1,000m ²	5 metres
	All other lots	800m ²	16 metres
Medium density residential	Rear lot	600m ²	5 metres
	All other lots	400m ²	10 metres
Industry	All lots	1,500m ²	45 metres

Zone	Type	Minimum area	Minimum frontage
Recreation and open space	All lots	Not specified	Not specified
Rural	All lots	60 hectares	400 metres
Rural residential	2 hectare precinct		
	All lots	2 hectares	60 metres
	1 hectare precinct		
	All lots	1 hectare	40 metres
	4,000m ² precinct		
	All lots	4,000m ²	40 metres

Figure A – Examples of access to rear lots

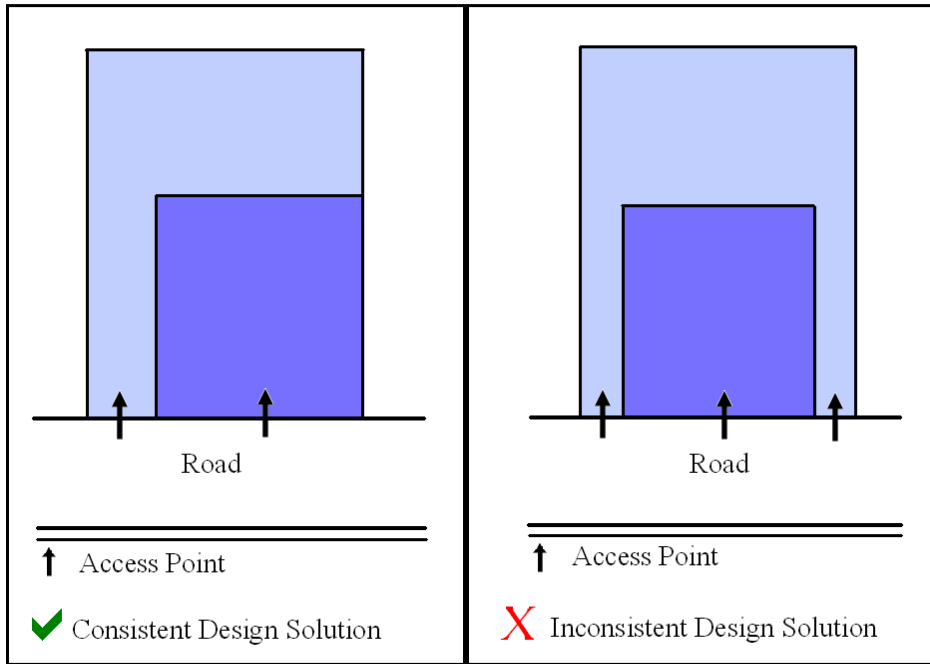
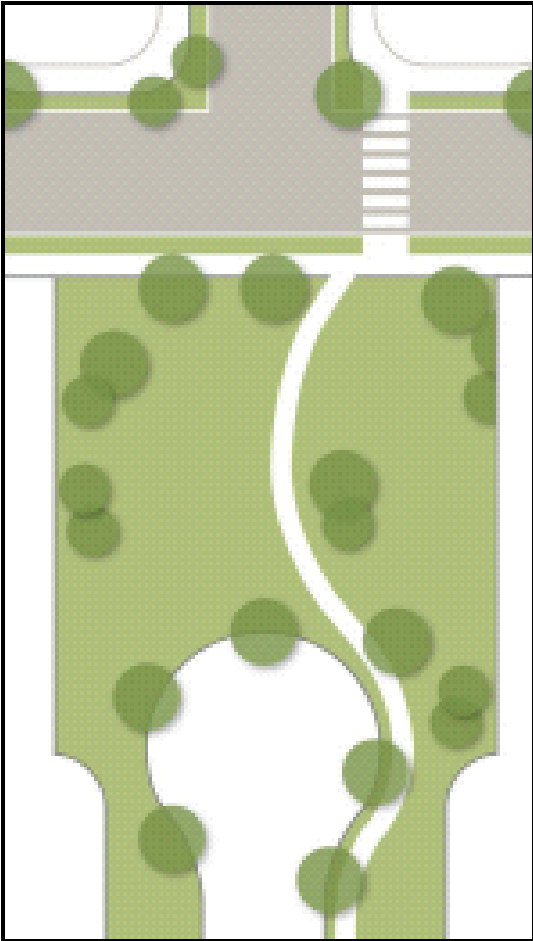

Figure B – Example of cul-de-sac design



9.4.5 Works, services and infrastructure code

9.4.5.1 Application

- (1) This code applies to assessing development where it is identified in the assessment benchmarks for assessable development and requirements for accepted development column of an assessment table in Part 5 of the planning scheme.

9.4.5.2 Purpose

- (1) The purpose of the Works, services and infrastructure code is to ensure that all development is appropriately serviced by physical infrastructure, public utilities and services and that work associated with development is carried out in a manner that does not adversely impact on the surrounding area.
- (2) The purpose of the code will be achieved through the following overall outcomes:
 - (a) Development provides an adequate, safe and reliable supply of potable, fire-fighting and general use water in accordance with relevant standards;
 - (b) Development provides for the treatment and disposal of wastewater and ensures there are no adverse impacts on water quality, public health, local amenity or ecological processes;
 - (c) Development provides for the disposal of stormwater and ensures that there are no adverse impacts on water quality or ecological processes;
 - (d) Development connects to the road network and any adjoining public transport, pedestrian and cycle networks while ensuring no adverse impacts on the safe, convenient and efficient operation of these networks;
 - (e) Development provides electricity and telecommunications services that meet its desired requirements;
 - (f) Development is connected to a nearby electricity network with adequate capacity without significant environment, social or amenity impact;
 - (g) Development does not affect the efficient functioning of public utility mains, services or installations;
 - (h) Infrastructure dedicated to Council is cost effective over its life cycle;
 - (i) Work associated with development does not cause adverse impacts on the surrounding area; and
 - (j) Development prevents the spread of weeds, seeds or other pests.

9.4.5.3 Criteria for assessment

Table 9.4.5.3 - Works, services and infrastructure code – For accepted development subject to requirements and assessable development

Performance outcomes	Acceptable outcomes	Complies	Comments
For accepted development subject to requirements and assessable development			
Water supply			

Performance outcomes	Acceptable outcomes	Complies	Comments
<p>PO1 Each lot has an adequate volume and supply of water that:</p> <ul style="list-style-type: none"> (a) meets the needs of users; (b) is adequate for fire-fighting purposes; (c) ensures the health, safety and convenience of the community; and (d) minimises adverse impacts on the receiving environment. 	<p>AO1.1 Development is connected to a reticulated water supply system in accordance with the Design Guidelines and Specifications set out in the Planning Scheme Policy 4 – FNQROC Regional Development Manual other than where located:</p> <ul style="list-style-type: none"> (a) in the Conservation zone, Rural zone or Rural residential zone; and (b) outside a reticulated water supply service area. 	✓	Will be conditioned to comply.
	<p>AO1.2 Development, where located outside a reticulated water supply service area and in the Conservation zone, Rural zone or Rural residential zone is provided with:</p> <ul style="list-style-type: none"> (a) a bore or bores are provided in accordance with the Design Guidelines set out in the Planning Scheme Policy 4 – FNQROC Regional Development Manual; or (b) on-site water storage tank/s: <ul style="list-style-type: none"> (i) with a minimum capacity of 90,000L; (ii) fitted with a 50mm ball valve with a camlock fitting; and (iii) which are installed and connected prior to the occupation or use of the development. 	n/a	Not applicable.
Wastewater disposal			

Performance outcomes	Acceptable outcomes	Complies	Comments
<p>PO2 Each lot provides for the treatment and disposal of effluent and other waste water that:</p> <ul style="list-style-type: none"> (a) meets the needs of users; (b) is adequate for fire-fighting purposes; (c) ensures the health, safety and convenience of the community; and (d) minimises adverse impacts on the receiving environment. 	<p>AO2.1 Development is connected to a reticulated sewerage system in accordance with the Design Guidelines and Specifications set out in the Planning Scheme Policy 4 – FNQROC Regional Development Manual other than where located:</p> <ul style="list-style-type: none"> (a) in the Conservation zone, Rural zone or Rural residential zone; and (b) outside a reticulated sewerage service area. 	✓	Will be conditioned to comply.
	<p>AO2.2 An effluent disposal system is provided in accordance with ASNZ 1547 On-Site Domestic Wastewater Management (as amended) where development is located:</p> <ul style="list-style-type: none"> (a) in the Conservation zone, Rural zone or Rural residential zone; and (b) outside a reticulated sewerage service area. 	n/a	Not applicable.
Stormwater infrastructure			
<p>PO3 Stormwater infrastructure is designed and constructed to collect and convey the design storm event to a lawful point of discharge in a manner that mitigates impacts on life and property.</p>	<p>AO3.1 Where located within a Priority infrastructure area or where stormwater infrastructure is available, development is connected to Council's stormwater network in accordance with the Design Guidelines and Specifications set out in the Planning Scheme Policy 4 – FNQROC Regional Development Manual.</p>	✓	Will be conditioned to comply.

Performance outcomes	Acceptable outcomes	Complies	Comments
	<p>AO3.2 On-site drainage systems are constructed:</p> <ul style="list-style-type: none"> (a) to convey stormwater from the premises to a lawful point of discharge; and (b) in accordance with the Design Guidelines and Specifications set out in the Planning Scheme Policy 4 – FNQROC Regional Development Manual. 	✓	Will be conditioned to comply at operational works stage.
Electricity supply			
<p>PO4 Each lot is provided with an adequate supply of electricity</p>	<p>AO4 The premises:</p> <ul style="list-style-type: none"> (a) is connected to the electricity supply network; or (b) has arranged a connection to the transmission grid; or (c) where not connected to the network, an independent energy system with sufficient capacity to service the development (at near average energy demands associated with the use) may be provided as an alternative to reticulated electricity where: <ul style="list-style-type: none"> (i) it is approved by the relevant regulatory authority; and (ii) it can be demonstrated that no air or noise emissions; and (iii) it can be demonstrated that no adverse impact on visual amenity will occur. 	✓	Will be conditioned to comply.
Telecommunications infrastructure			

Performance outcomes	Acceptable outcomes	Complies	Comments
PO5 Each lot is provided with an adequate supply of telecommunication infrastructure	A05 Development is provided with a connection to the national broadband network or telecommunication services.	✓	Will be conditioned to comply.
Existing public utility services			
PO6 Development and associated works do not affect the efficient functioning of public utility mains, services or installations.	A06 Public utility mains, services are relocated, altered or repaired in association with the works so that they continue to function and satisfy the relevant Design Guidelines and Specifications set out in the Planning Scheme Policy 4 – FNQROC Regional Development Manual.	✓	Will be conditioned to comply.
Excavation or filling			
PO7 Excavation or filling must not have an adverse impact on the: (a) streetscape; (b) scenic amenity; (c) environmental values; (d) slope stability; (e) accessibility; or (f) privacy of adjoining premises.	A07.1 Excavation or filling does not occur within 1.5 metres of any site boundary.	n/a	Not applicable. To be addressed at operational works stage.
	A07.2 Excavation or filling at any point on a lot is to be no greater than 1.5 metres above or below natural ground level.	n/a	Not applicable. To be addressed at operational works stage.
	A07.3 Earthworks batters: (a) are no greater than 1.5 metres in height; (b) are stepped with a minimum width 2 metre berm; (c) do not exceed a maximum of two batters and two berms (not greater than 3.6 metres in total height) on any one lot; (d) have a slope no greater than 1 in 4; and (e) are retained.	n/a	Not applicable. To be addressed at operational works stage.

Performance outcomes	Acceptable outcomes	Complies	Comments
	<p>A07.4 Soil used for filling or spoil from excavation is not stockpiled in locations that can be viewed from:</p> <p>(a) adjoining premises; or (b) a road frontage, for a period exceeding 1 month from the commencement of the filling or excavation.</p>	n/a	Not applicable. To be addressed at operational works stage.
	<p>A07.5 All batters and berms to be constructed in accordance with the Design Guidelines and Specifications set out in the Planning Scheme Policy 4 – FNQROC Regional Development Manual.</p>	n/a	Not applicable. To be addressed at operational works stage.
	<p>A07.6 Retaining walls have a maximum height of 1.5 metres and are designed and constructed in accordance with the Design Guidelines and Specifications set out in the Planning Scheme Policy 4 – FNQROC Regional Development manual.</p>	n/a	Not applicable. To be addressed at operational works stage.
	<p>A07.7 Excavation or filling at any point on a lot is to include measures that protect trees at the foot or top of cut or fill batters by the use of appropriate retaining methods and sensitive earth removal or placement and in accordance with the Design Guidelines and Specifications set out in the Planning Scheme Policy 4 – FNQROC Regional Development manual.</p>	n/a	Not applicable. To be addressed at operational works stage.
For assessable development			
Transport network			

Performance outcomes	Acceptable outcomes	Complies	Comments
<p>PO8 The development has access to a transport network of adequate standard to provide for the safe and efficient movement of vehicles, pedestrians and cyclists.</p>	<p>A08.1 Vehicle access, crossovers, road geometry, pavement, utilities and landscaping to the frontage/s of the site are designed and constructed in accordance with the Design Guidelines and Specifications set out in the Planning Scheme Policy 4 – FNQROC Regional Development manual.</p>	✓	Will be conditioned to comply.
	<p>A08.2 Development provides footpath pavement treatments in accordance with Planning Scheme Policy 9 – Footpath Paving.</p>	✓	Will be conditioned to comply.
Public infrastructure			
<p>PO9 The design, construction and provision of any infrastructure that is to be dedicated to Council is cost effective over its life cycle and incorporates provisions to minimise adverse impacts.</p>	<p>A09 Development is in accordance with the Design Guidelines and Specifications set out in the Planning Scheme Policy 4 – FNQROC Regional Development Manual.</p>	✓	Will be conditioned to comply.
Stormwater quality			

Performance outcomes	Acceptable outcomes	Complies	Comments
<p>PO10 Development has a non-worsening effect on the site and surrounding land and is designed to:</p> <ul style="list-style-type: none"> (a) optimise the interception, retention and removal of waterborne pollutants, prior to the discharge to receiving waters; (b) protect the environmental values of waterbodies affected by the development, including upstream, on-site and downstream waterbodies; (c) achieve specified water quality objectives; (d) minimise flooding; (e) maximise the use of natural channel design principles; (f) maximise community benefit; and (g) minimise risk to public safety. 	<p>AO10.1 The following reporting is prepared for all Material change of use or Reconfiguring a lot proposals:</p> <ul style="list-style-type: none"> (a) a Stormwater Management Plan and Report that meets or exceeds the standards of design and construction set out in the Queensland Urban Drainage Manual (QUDM) and the Design Guidelines and Specifications set out in the Planning Scheme Policy 4 – FNQROC Regional Development Manual; and (b) an Erosion and Sediment Control Plan that meets or exceeds the Soil Erosion and Sedimentation Control Guidelines (Institute of Engineers Australia), including: <ul style="list-style-type: none"> (i) drainage control; (ii) erosion control; (iii) sediment control; and (iv) water quality outcomes. 	<p>✓</p>	<p>Will be conditioned to comply at operational works stage.</p>

Performance outcomes	Acceptable outcomes	Complies	Comments
	<p>AO10.2 For development on land greater than 2,500m² or that result in more than 5 lots or more than 5 dwellings or accommodation units, a Stormwater Quality Management Plan and Report prepared and certified by a suitably qualified design engineer (RPEQ) is prepared that demonstrates that the development:</p> <ul style="list-style-type: none"> (a) meets or exceeds the standards of design and construction set out in the Urban Stormwater Quality Planning Guideline and the Queensland Water Quality Guideline; (b) is consistent with any local area stormwater water management planning; (c) accounts for development type, construction phase, local climatic conditions and design objectives; and (d) provides for stormwater quality treatment measures reflecting land use constraints, such as soil type, landscape features (including landform), nutrient hazardous areas, acid sulfate soil and rainfall erosivity. 	✓	Will be conditioned to comply at operational works stage.

Performance outcomes	Acceptable outcomes	Complies	Comments
<p>PO11 Storage areas for stormwater detention and retention:</p> <p>(a) protect or enhance the environmental values of receiving waters;</p> <p>(b) achieve specified water quality objectives;</p> <p>(c) where possible, provide for recreational use;</p> <p>(d) maximise community benefit; and</p> <p>(e) minimise risk to public safety.</p>	<p>AO11 No acceptable outcome is provided.</p>	✓	Will be conditioned to comply at operational works stage.
Excavation or filling			
<p>PO12 Traffic generated by filling or excavation does not impact on the amenity of the surrounding area.</p>	<p>AO12.1 Haul routes used for transportation of fill to or from the site only use major roads and avoid residential areas.</p>	✓	Will be conditioned to comply at operational works stage.
	<p>AO12.2 Transportation of fill to or from the site does not occur:</p> <p>(a) within peak traffic times; and</p> <p>(b) before 7am or after 6pm Monday to Friday;</p> <p>(c) before 7am or after 1pm Saturdays; and</p> <p>(d) on Sundays or Public Holidays.</p>	✓	Will be conditioned to comply at operational works stage.

Performance outcomes	Acceptable outcomes	Complies	Comments
PO13 Air pollutants, dust and sediment particles from excavation or filling, do not cause significant environmental harm or nuisance impacts.	AO13.1 Dust emissions do not extend beyond the boundary of the site.	✓	Will be conditioned to comply at operational works stage.
	AO13.2 No other air pollutants, including odours, are detectable at the boundary of the site.	✓	Will be conditioned to comply at operational works stage.
	AO13.3 A management plan for control of dust and air pollutants is prepared and implemented.	✓	Will be conditioned to comply at operational works stage.
PO14 Access to the premises (including driveways and paths) does not have an adverse impact on: <ul style="list-style-type: none"> (a) safety; (b) drainage; (c) visual amenity; and (d) privacy of adjoining premises. 	AO14 Access to the premises (including all works associated with the access): <ul style="list-style-type: none"> (a) must follow as close as possible to the existing contours; (b) be contained within the premises and not the road reserve, and (c) are designed and constructed in accordance with the Design Guidelines and Specifications set out in the Planning Scheme Policy 4 – FNQROC Regional Development manual. 	✓	Will be conditioned to comply at operational works stage.
Weed and pest management			
PO15 Development prevents the spread of weeds, seeds or other pests into clean areas or away from infested areas.	AO15 No acceptable outcome is provided.	✓	Will be conditioned to comply at operational works stage.
Contaminated land			

Performance outcomes	Acceptable outcomes	Complies	Comments
<p>PO16 Development is located and designed to ensure that users and nearby sensitive land uses are not exposed to unacceptable levels of contaminants</p>	<p>AO16 Development is located where: (a) soils are not contaminated by pollutants which represent a health or safety risk to users; or (b) contaminated soils are remediated prior to plan sealing, operational works permit, or issuing of building works permit.</p>	✓	Complies.
Fire services in developments accessed by common private title			
<p>PO17 Fire hydrants are located in positions that will enable fire services to access water safely, effectively and efficiently.</p>	<p>AO17.1 Fire hydrants are located in accessways or private roads held in common private title at a maximum spacing of: (a) 120 metres for residential development; and (b) 90 metres for any other development.</p>	n/a	Not applicable.
	<p>AO17.2 Fire hydrants are located at all intersections of accessways or private roads held in common private title.</p>	n/a	Not applicable.