



21 December 2023

Senior Planner: Carl Ewin  
Direct Phone: 07 4086 4656  
Our Reference: RAL/23/0009  
Your Reference: F23/20

Conmat No 2 Pty Ltd TTE  
C/- Freshwater Planning Pty Ltd  
17 Barronview Drive  
FRESHWATER QLD 4870

Dear Applicants,

## Decision Notice

### *Planning Act 2016*

I refer to your application and advise that on 20 December 2023, Council decided to approve the application in full subject to conditions.

Details of the decision are as follows:

#### APPLICATION DETAILS

Application No:	RAL/23/0009
Street Address:	Ray Road, Mareeba
Real Property Description:	Lot 1 on RP747077
Planning Scheme:	Mareeba Shire Council Planning Scheme 2016

#### DECISION DETAILS

Type of Decision:	Approval
Type of Approval:	Development Permit for Reconfiguration of a Lot Subdivision (1 Lot into 41 Lots in 4 Stages)
Date of Decision:	20 December 2023



---

**CURRENCY PERIOD OF APPROVAL**

The currency period for this development approval is four (4) years starting the day that this development approval takes effect. (Refer to Section 85 "Lapsing of approval at end of currency period" of the *Planning Act 2016*.)

**INFRASTRUCTURE**

Where conditions relate to the provision of infrastructure, these are non-trunk infrastructure conditions unless specifically nominated as a "*necessary infrastructure condition*" for the provision of trunk infrastructure as defined under Chapter 4 of the *Planning Act 2016*.

**ASSESSMENT MANAGER CONDITIONS**

## (C) ASSESSMENT MANAGER'S CONDITIONS (COUNCIL)

(a) Development assessable against the Planning Scheme

1. Development must be carried out generally in accordance with the approved plans and the facts and circumstances of the use as submitted with the application, and subject to any alterations:
  - found necessary by the Council's delegated officer at the time of examination of the engineering plans or during construction of the development because of particular engineering requirements; and
  - to ensure compliance with the following conditions of approval.
2. Timing of Effect
  - 2.1 The conditions of the development permit must be complied with to the satisfaction of Council's delegated officer prior to the endorsement of the plan of survey for each stage of the development, or alternative documentation as approved by the Land Title Act, except where specified otherwise in these conditions of approval.
3. General
  - 3.1 The applicant/developer is responsible for the cost of necessary alterations to existing public utility mains, services or installations required by works in relation to the proposed development or any works required by condition(s) of this approval.
  - 3.2 All payments or bonds required to be made to the Council pursuant to any condition of this approval or the Adopted Infrastructure Charges Notice must be made prior to the endorsement of the plan of survey, or alternative documentation as approved by the Land Title Act and at the rate applicable at the time of payment.



- 
- 3.3 The developer must relocate (in accordance with FNQROC standards) any services such as water, sewer, drainage, telecommunications and electricity that are not wholly located within the lots that are being created/serviced where required by the relevant authority, unless approved by Council's delegated officer.
- 3.4 Where utilities (such as sewers on non-standard alignments) traverse lots to service another lot, easements must be created in favour of Council for access and maintenance purposes. The developer is to pay all costs (including Council's legal expenses) to prepare and register the easement documents.
- 3.5 All works must be designed, constructed and carried out in accordance with FNQROC Development Manual requirements (as amended) and to the satisfaction of Council's delegated officer.

3.6 Charges

All outstanding rates, charges, and expenses pertaining to the land are to be paid in full.

3.7 Local Heritage Place – Heavy Anti Aircraft Gun Station 448

No aspect of this development shall interfere with or damage the heritage significance of Heavy Anti Aircraft Gun Station 448.

4. Infrastructure Services and Standards

4.1 Stormwater Drainage

- (a) The applicant/developer must take all necessary steps to ensure a non-worsening effect on surrounding land as a consequence of the development.
- (b) Prior to works commencing the applicant must submit a Stormwater Management Plan and Report prepared and certified by a suitably qualified design engineer (RPEQ) that meets or exceeds the standards of design and construction set out in the Queensland Urban Drainage Manual (QUDM) and the FNQROC Development Manual to the satisfaction of Council's delegated officer.

The Stormwater Management Plan and Report must also consider the existing condition of the downstream Easement A on RP733064 and make all necessary recommendations to ensure the long term stability and functioning of this drainage easement.



- 
- (c) Prior to works commencing the applicant must submit a Stormwater Quality Management Plan and Report prepared and certified by a suitably qualified design engineer (RPEQ) that meets or exceeds the standards of design and construction set out in the Urban Stormwater Quality Planning Guideline and the Queensland Water Quality Guideline to the satisfaction of Council's delegated officer.
  - (d) The Stormwater Quality Management Plan must include an Erosion and Sediment Control Plan that meets or exceeds the Soil Erosion and Sedimentation Control Guidelines (Institute of Engineers Australia) to the satisfaction of Council's delegated officer.
  - (e) The applicant/developer must construct the stormwater drainage infrastructure in accordance with the approved Stormwater Management Plan and/or Stormwater Quality Management Plan and Report.
  - (f) Temporary drainage is to be provided and maintained during the construction phase of the development, discharged to a lawful point and not onto the construction site.
  - (g) All stormwater channels through private property must be registered, with the easement for drainage purposes in favour of Council. All documentation leading to the registration of the easement must be completed at no cost to Council.
  - (h) All stormwater drainage collected from the site must be discharged to an approved legal point of discharge.
  - (i) The applicant (at their cost) must video all stormwater lines and submit the video for inspection by Council's delegated officer prior to the development being taken "off maintenance" to ensure that no defects have occurred during the 12 month maintenance period.
  - (j) All drainage easements must be constructed to prevent erosion. Construction may be in the form of a concrete invert, with outlet protection.

#### 4.2 Earthworks

All earthworks must be carried out in accordance with the requirements of the FNQROC Development Manual (as amended) to the satisfaction of Council's delegated officer.



---

#### 4.3 Roadworks/footpaths – Internal

- (a) The subdivision internal roads must be designed and constructed to Access Street standard in accordance with Council's FNQROC Development Manual, as detailed in Table D.1.1
- (b) Individual property access must be designed in accordance with the requirements of FNQROC Development Manual. Appropriate distances are required from intersections and tangent points in accordance with AS2890.1.

The provision of layback/roll-over kerbing along the frontage of each allotment will satisfy this condition.

- (c) The diameter of the cul-de-sacs must be suitable for the largest refuse collection vehicle used throughout the shire to be able to turn around in a forward direction. Swept path diagrams must be submitted as part of the development application for Operational Works to demonstrate this requirement.
- (d) A temporary gravel vehicle turnaround at the end of all partially constructed roads must be provided of a sufficient size to turnaround a refuse collection vehicle, either in a continuous forward movement or by a three-point turn.
- (e) A second 4 metre wide road reserve connection must be provided along the common boundary of proposed Lots 11 & 12 (and ultimately proposed Lots 22 & 23) to allow for future pedestrian only connectivity between Ray Road and the proposed internal road.
- (f) Two (2) metre wide concrete pedestrian footpaths must be installed in the locations marked on the approved Footpath Plan, applicable to the relevant stage. The horizontal alignment of all footpaths must comply with the FNQROC development Manual (specifically Standard Drawing S1004A).

#### 4.4 Roadworks - External (Ray Road and Cater Road)

- (a) Prepare a design for Ray Road (between McIver Road and Cater Road) to a Major Collector Road standard as defined in Council's FNQROC Development Manual. The design must detail the alignment of all associated infrastructure including:
  - pavement
  - kerb and channel



- footpath (western side)
- street lighting
- underground stormwater infrastructure

The design should also identify the extent of any land requirements on the subject lots to facilitate the road network, giving consideration to any localised widenings necessary to facilitate the construction/ upgrade of the intersections.

- (b) Undertake road widening along the full Ray Road frontage of the site equivalent to half of a Major Collector Road, inclusive of pavement, kerb and channel, drainage infrastructure, footpath, landscaping, and street lighting. The arrangement must be compatible with the eventual full upgrade of Ray Road to Major Collector Road standard. Services are required to be installed in the location suitable for the future road upgrade of the eastern half of Ray Road.
- (c) Design Cater Road to a 10 metre wide bus route Access Street standard as defined in Council's FNQROC Development Manual, for the full frontage of proposed Lots 17 and 18.
- (d) Undertake road widening along Cater Road for the full frontage of proposed Lots 17 and 18 equivalent to half of a 10 metre wide bus route Access Street standard, inclusive of pavement, kerb and channel, drainage infrastructure, footpath, landscaping, and street lighting. Services are required to be installed in the location suitable for the future road upgrade of the western half of Cater Road.
- (e) Design and construct the new internal road intersection with Ray Road and upgrade of Ray Road/Cater Road intersection in accordance with Council's FNQROC Development Manual.
- (f) The design and construction of the interim arrangements must allow for all necessary work and adjustments to smoothly join the new works to the existing formation. Minor adjustment to levels may be necessary to achieve this.
- (g) Individual property access must be designed in accordance with the requirements of FNQROC Development Manual. Appropriate distances are required from intersections and tangent points in accordance with AS2890.1.

The access to all properties with two (2) road frontages (Lot 17 & Lot 18) must be from the lower order road being Cater Road.

The provision of layback/roll-over kerbing along the frontage of each allotment will satisfy this condition.



#### 4.5 Water Supply

- (b) A water service connection must be provided to each proposed lot in accordance with FNQROC Development Manual standards (as amended) to the satisfaction of Council's delegated officer
- (b) Where the existing reticulated water supply does not currently service the site or is not at an adequate capacity, the developer is required to extend or upgrade the reticulated water supply infrastructure to connect the site to Council's existing infrastructure at a point that has sufficient capacity to service the development in accordance with FNQROC Development Manual standards (as amended).

#### 4.6 Sewerage Connection

- (a) The developer must connect the proposed development to Council's reticulated sewerage system in accordance with FNQROC Development Manual standards (as amended) to the satisfaction of Council's delegated officer.
- (b) Where sewerage connections are not available to the site, or where existing connections are not satisfactory for the proposed development, the developer is required to extend or upgrade the reticulated sewerage infrastructure to connect the site to Council's existing infrastructure at a point that has sufficient capacity to service the development in accordance with FNQROC Development Manual standards (as amended).

#### 4.7 Electricity provision/supply

The applicant/developer must ensure that an appropriate level of electricity supply is provided to each allotment in accordance with FNQROC Development Manual standards (as amended) to the satisfaction of Council's delegated officer.

Written advice from an Electricity Service Provider is to be provided to Council indicating that an agreement has been made for the provision of power reticulation.

#### 4.8 Telecommunications

The applicant/developer must enter into an agreement with a telecommunication carrier to provide telecommunication services to each allotment and arrange provision of necessary conduits and enveloping pipes.



#### 4.9 Lighting

- (a) The new intersection formed on Ray Road for the purpose of accessing the development and the intersection of Ray Road/ Cater Road must be provided with street lighting for a distance equivalent to at least two (2) spans either side of the intersection to the relevant Lighting Category.
- (b) Prior to the issue of a development permit for Operational Works a Rate 2 lighting scheme is to be prepared by an Ergon Energy approved consultant and submitted to Council for approval. The Rate 2 lighting scheme is to be designed in accordance with the relevant Road Lighting Standard AS/NZS 1158 and the FNQROC Development Manual. The applicable lighting category is to be determined from the Road Hierarchy Table D1.1.

#### 4.10 Street Trees

One (1) street tree must be at the planted at centre of each lot's road frontage. Corner allotments must have a street tree planted on each frontage.

All street trees must be provided in accordance with the FNQROC Development Manual - Design Manual D9 Landscaping.

Plans for the development works required under Conditions 4.1 - 4.10 must be submitted to Council for approval as part of a subsequent application for operational works.

#### REFERRAL AGENCIES

Not Applicable.

#### APPROVED PLANS

The following plans are Approved plans for the development:

Plan/Document Number	Plan/Document Title	Prepared by	Dated
9348-ROL1 Rev B	Sheet 1 of 3	Twine Surveys Pty Ltd	25.07.2023
9348-ROL1 Rev B	Sheet 2 of 3	Twine Surveys Pty Ltd	25.07.2023
9348-ROL1 Rev B	Sheet 3 of 3	Twine Surveys Pty Ltd	25.07.2023



---

**ADVISORY NOTES**

The following notes are included for guidance and information purposes only and do not form part of the assessment manager conditions:

(D) ASSESSMENT MANAGER'S ADVICE

(a) An Adopted Infrastructure Charges Notice has been issued with respect to the approved development. The Adopted Infrastructure Charges Notice details the type of infrastructure charge/s, the amount of the charge/s and when the charge/s are payable.

(b) The Adopted Infrastructure Charges Notice does not include all charges or payments that are payable with respect to the approved development. A number of other charges or payments may be payable as conditions of approval. The applicable fee is set out in Council's Fees & Charges Schedule for each respective financial year.

(c) Easement Documents

Council has developed standard easement documentation to assist in the drafting of formal easement documents for Council easements. Please contact the Planning Section for more information regarding the drafting of easement documents for Council easements.

(d) Endorsement Fees

Council charges a fee for the endorsement of a Survey Plan, Community Management Statements, easement documents, and covenants. The fee is set out in Council's Fees & Charges Schedule applicable for each respective financial year.

(e) Compliance with applicable codes/policies

The development must be carried out to ensure compliance with the provisions of Council's Local Laws, Planning Scheme Policies, Planning Scheme and Planning Scheme Codes to the extent they have not been varied by a condition of this approval.

(f) Environmental Protection and Biodiversity Conservation Act 1999

The applicant is advised that referral may be required under the *Environmental Protection and Biodiversity Conservation Act 1999* if the proposed activities are likely to have a significant impact on a matter of national environmental significance. Further information on these matters can be obtained from [www.dcceew.gov.au](http://www.dcceew.gov.au).

(g) Cultural Heritage

In carrying out the activity the applicant must take all reasonable and practicable measures to ensure that no harm is done to Aboriginal cultural heritage (the



“cultural heritage duty of care”). The applicant will comply with the cultural heritage duty of care if the applicant acts in accordance with gazetted cultural heritage duty of care guidelines. An assessment of the proposed activity against the duty of care guidelines will determine whether or to what extent Aboriginal cultural heritage may be harmed by the activity. Further information on cultural heritage, together with a copy of the duty of care guidelines and cultural heritage search forms, may be obtained from [www.dsdsatsip.qld.gov.au](http://www.dsdsatsip.qld.gov.au).

(h) Electric Ants

Electric ants are designated as restricted biosecurity matter under the *Biosecurity Act 2014*.

Certain restrictions and obligations are placed on persons dealing with electric ant carriers within the electric ant restricted zone. Movement restrictions apply in accordance with Sections 74–77 of the *Biosecurity Regulation 2016*. Penalties may be imposed on movement of electric ant carriers and electric ants in contravention of the legislated restrictions. It is the responsibility of the applicant to check if the nominated property lies within a restricted zone.

All persons within and outside the electric ant biosecurity zone have an obligation (a **general biosecurity obligation**) to manage biosecurity risks and threats that are under their control, they know about, or they are expected to know about. Penalties may apply for failure to comply with a general biosecurity obligation. For more information please visit the electric ant website at [Electric ants in Queensland | Business Queensland](#) or contact Biosecurity Queensland 13 25 23.

#### PROPERTY NOTES

Not Applicable.

#### FURTHER DEVELOPMENT PERMITS REQUIRED

- Development Permit for Operational Work

#### SUBMISSIONS

Not Applicable.

#### RIGHTS OF APPEAL

You are entitled to appeal against this decision. A copy of the relevant appeal provisions from the *Planning Act 2016* is attached.

During the appeal period, you as the applicant may suspend your appeal period and make written representations to council about the conditions contained within the development approval. If council agrees or agrees in part with the representations, a “negotiated decision notice” will be issued. Only one “negotiated decision notice” may be given. Taking this step will



---

defer your appeal period, which will commence again from the start the day after you receive a "negotiated decision notice".

**OTHER DETAILS**

If you wish to obtain more information about Council's decision, electronic copies are available on line at [www.msc.qld.gov.au](http://www.msc.qld.gov.au), or at Council Offices.

Yours faithfully

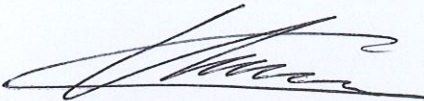

for **BRIAN MILLARD**  
**COORDINATOR PLANNING SERVICES**

Enc: Approved Plans/Documents  
Appeal Rights  
Adopted Infrastructure Charge Notice



Approved Plans/Documents

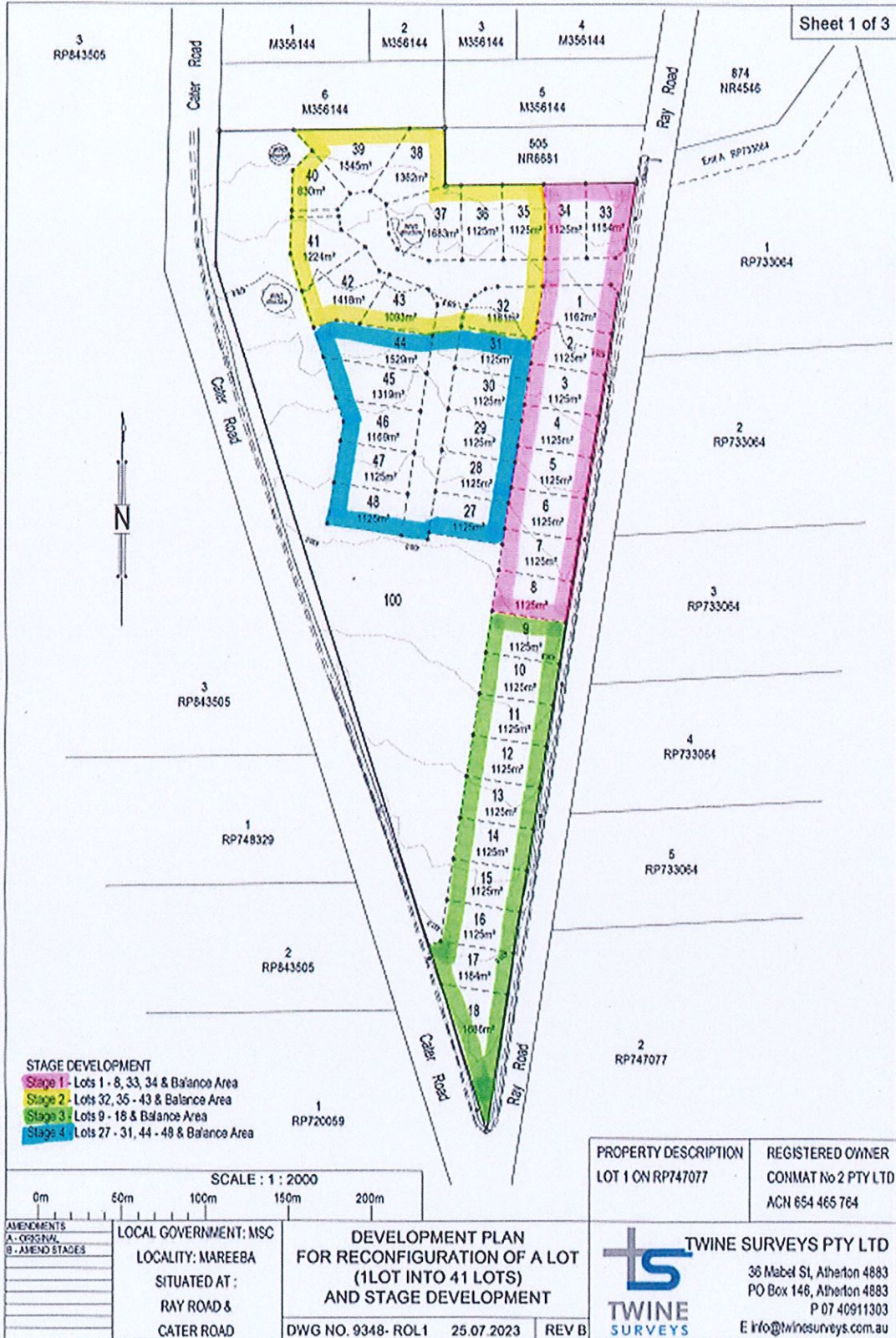

*[Signature]*  
21/12/2023



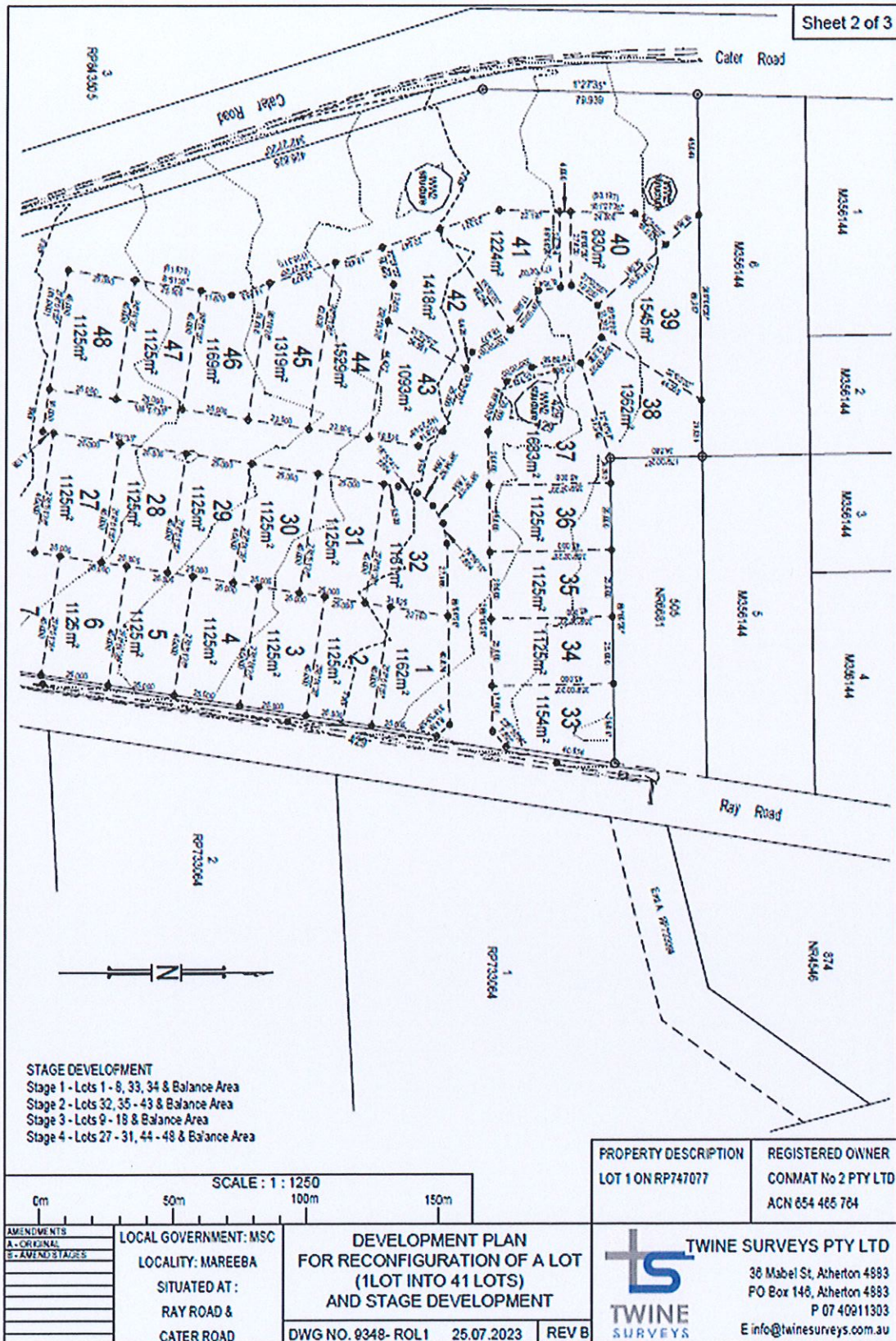

*[Signature]*  
21/12/2023



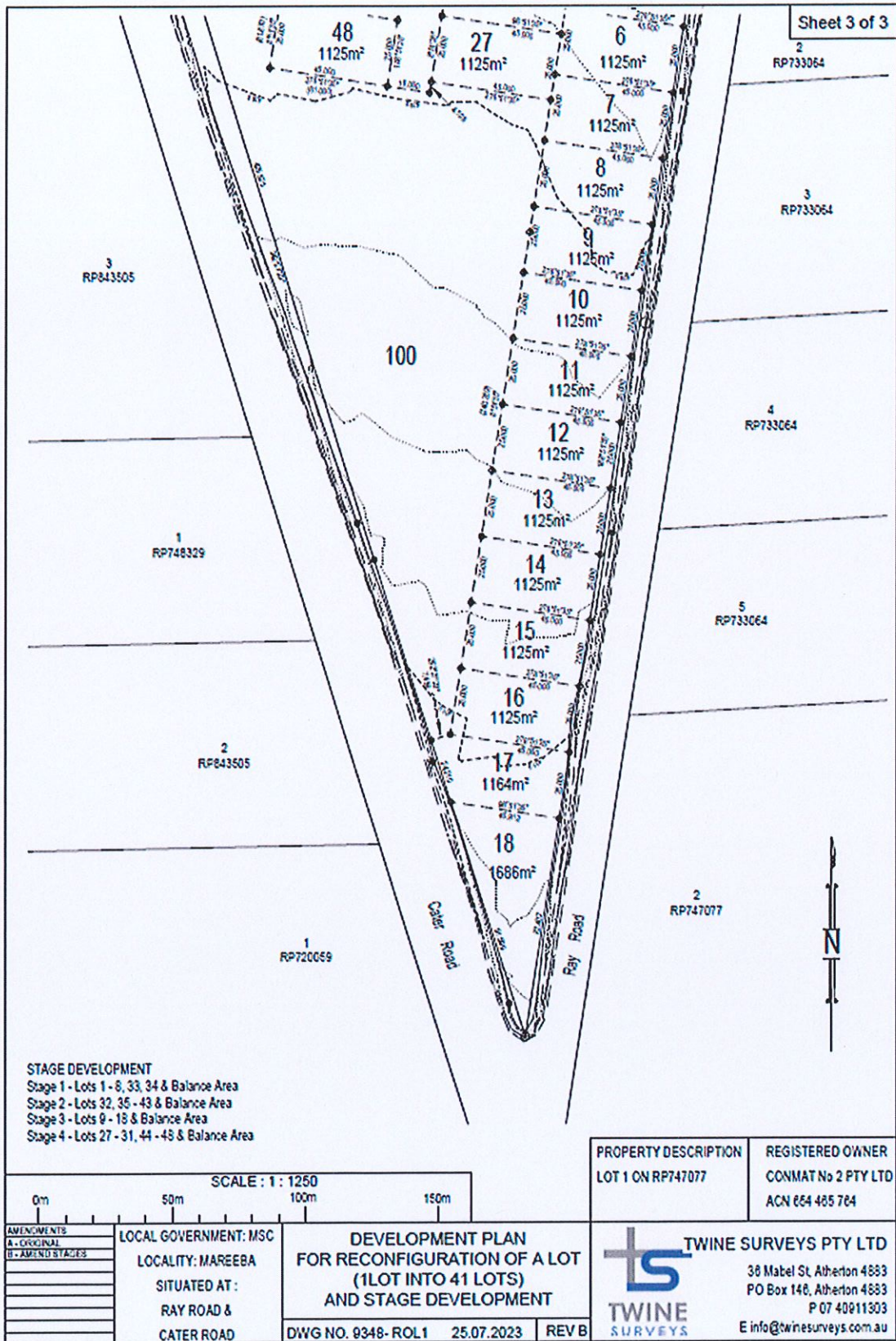

*[Signature]*  
21/12/2023



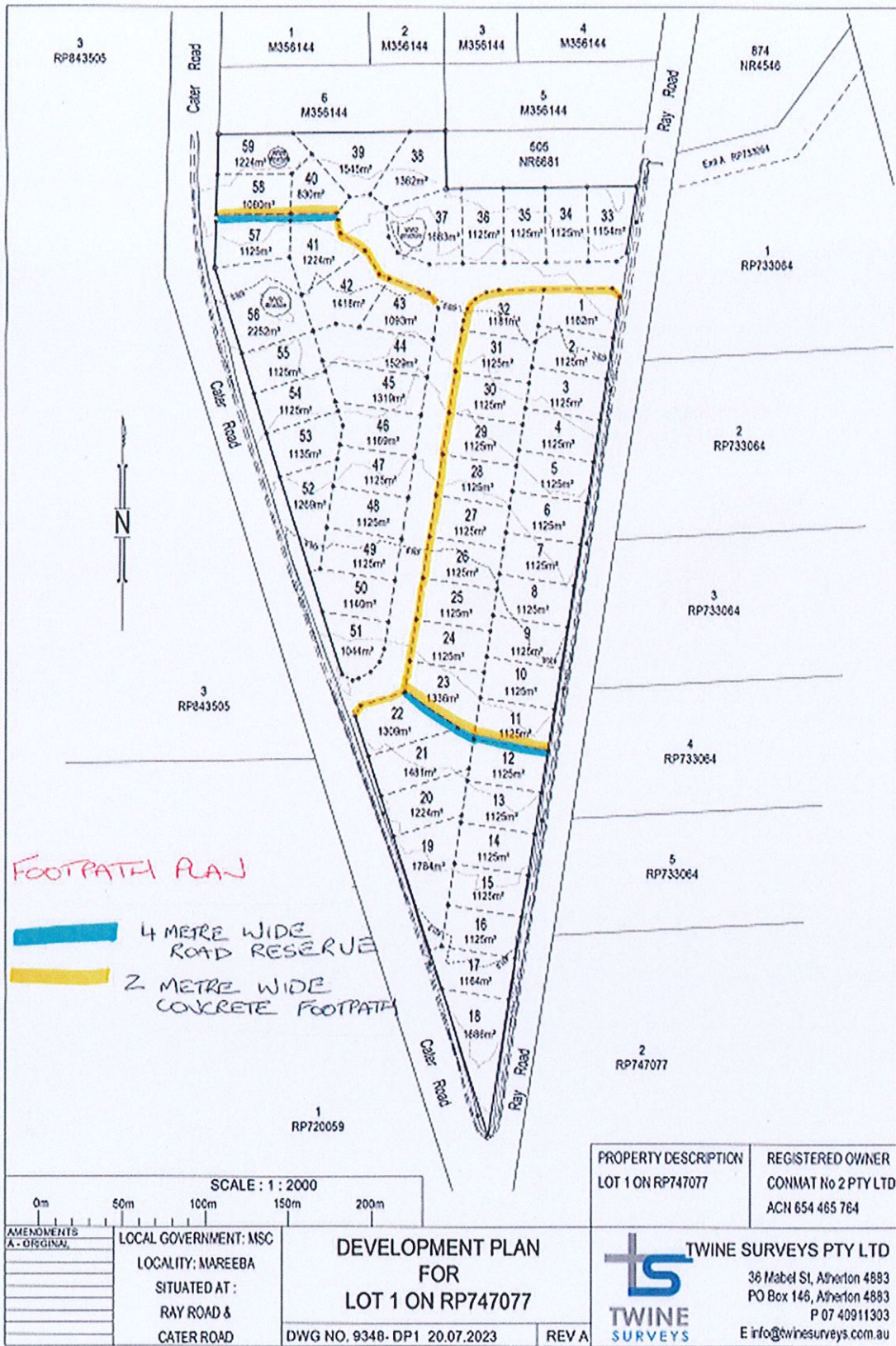

*[Handwritten Signature]*  
21/12/2023



## Appeal Rights

PLANNING ACT 2016 & THE PLANNING REGULATION 2017

### Chapter 6 Dispute resolution

#### Part 1 Appeal rights

##### 229 Appeals to tribunal or P&E Court

- (1) Schedule 1 of the *Planning Act 2016* states –
- (a) Matters that may be appealed to –
    - (i) either a tribunal or the P&E Court; or
    - (ii) only a tribunal; or
    - (iii) only the P&E Court; and
  - (b) The person-
    - (i) who may appeal a matter (**the appellant**); and
    - (ii) who is a respondent in an appeal of the matter; and
    - (iii) who is a co-respondent in an appeal of the matter; and
    - (iv) who may elect to be a co-respondent in an appeal of the matter.

(Refer to Schedule 1 of the Planning Act 2016)

- (2) An appellant may start an appeal within the appeal period.
- (3) The **appeal period** is –
- (a) for an appeal by a building advisory agency – 10 business days after a decision notice for the decision is given to the agency; or
  - (b) for an appeal against a deemed refusal – at any time after the deemed refusal happens; or
  - (c) for an appeal against a decision of the Minister, under chapter 7, part 4, to register premises or to renew the registration of premises – 20 business days after a notice is published under section 269(3)(a) or (4); or
  - (d) for an appeal against an infrastructure charges notice – 20 business days after the infrastructure charges notice is given to the person; or
  - (e) for an appeal about a deemed approval of a development application for which a decision notice has not been given – 30 business days after the applicant gives the deemed approval notice to the assessment manager; or
  - (f) for any other appeal – 20 business days after a notice of the decision for the matter, including an enforcement notice, is given to the person.

*Note –*

*See the P&E Court Act for the court's power to extend the appeal period.*

- (4) Each respondent and co-respondent for an appeal may be heard in the appeal.
- (5) If an appeal is only about a referral agency's response, the assessment manager may apply to the tribunal or P&E Court to withdraw from the appeal.



- 
- (6) To remove any doubt. It is declared that an appeal against an infrastructure charges notice must not be about-
- (a) the adopted charge itself; or
  - (b) for a decision about an offset or refund-
    - (i) the establishment cost of trunk infrastructure identified in a LGIP; or
    - (ii) the cost of infrastructure decided using the method included in the local government's charges resolution.

### 230 Notice of appeal

- (1) An appellant starts an appeal by lodging, with the registrar of the tribunal or P&E Court, a notice of appeal that-
  - (a) is in the approved form; and
  - (b) succinctly states the grounds of the appeal.
- (2) The notice of appeal must be accompanied by the required fee.
- (3) The appellant or, for an appeal to a tribunal, the registrar must, within the service period, give a copy of the notice of appeal to –
  - (a) the respondent for the appeal ; and
  - (b) each co-respondent for the appeal; and
  - (c) for an appeal about a development application under schedule 1, table 1, item 1 – each principal submitter for the development application; and
  - (d) for an appeal about a change application under schedule 1, table 1, item 2 – each principal submitter for the change application; and
  - (e) each person who may elect to become a co-respondent for the appeal, other than an eligible submitter who is not a principal submitter in an appeal under paragraph (c) or (d); and
  - (f) for an appeal to the P&E Court – the chief executive; and
  - (g) for an appeal to a tribunal under another Act – any other person who the registrar considers appropriate.
- (4) The *service period* is –
  - (a) if a submitter or advice agency started the appeal in the P&E Court – 2 business days after the appeal has started; or
  - (b) otherwise – 10 business days after the appeal is started.
- (5) A notice of appeal given to a person who may elect to be a co-respondent must state the effect of subsection (6).
- (6) A person elects to be a co-respondent by filing a notice of election, in the approved form, within 10 business days after the notice of appeal is given to the person.

### 231 Other appeals

- (1) Subject to this chapter, schedule 1 and the P&E Court Act, unless the Supreme Court decides a decision or other matter under this Act is affected by jurisdictional error, the decision or matter is non-appealable.
- (2) The *Judicial Review Act 1991*, part 5 applies to the decision or matter to the extent it is affected by jurisdictional error.
- (3) A person who, but for subsection (1) could have made an application under the *Judicial Review Act 1991* in relation to the decision or matter, may apply under part 4 of that Act for a statement of reasons in relation to the decision or matter.
- (4) In this section –



*decision* includes-

- (a) conduct engaged in for the purpose of making a decision; and
- (b) other conduct that relates to the making of a decision; and
- (c) the making of a decision or failure to make a decision; and
- (d) a purported decision ; and
- (e) a deemed refusal.

*non-appealable*, for a decision or matter, means the decision or matter-

- (a) is final and conclusive; and
- (b) may not be challenged, appealed against, reviewed, quashed, set aside or called into question in any other way under the Judicial Review Act 1991 or otherwise, whether by the Supreme Court, another court, a tribunal or another entity; and
- (c) is not subject to any declaratory, injunctive or other order of the Supreme Court, another court, a tribunal or another entity on any ground.

#### 232 Rules of the P&E Court

- (1) A person who is appealing to the P&E Court must comply with the rules of the court that apply to the appeal.
- (2) However, the P&E Court may hear and decide an appeal even if the person has not complied with the rules of the P&E Court.