

MAREEBA ROADHOUSE AND ACCOMMODATION PARK

WILLIAMS CLOSE, MAREEBA

LANDSCAPE DOCUMENTATION

ISSUE: 2
DATE: 10 May 2018
JOB NO: 181005

SHEET INDEX

SHEET	DESCRIPTION
L00	Cover Sheet and General Information
L01	Site Plan
L02	Landscape Layout Part 1
L02-1	Planting Plan Part 1
L02-2	Plant schedule Part 1
L03	Landscape Layout Part 2
L03-1	Planting Plan and Schedule Part 2
L04	Landscape, Planting Plan and Schedule Part 3
L05	Landscape Layout Part 4
L05-1	Planting Plan and Plant Schedule Part 4
L06	Plant Schedule - Overall
L07	General Details
L08	Simple Specification

GENERAL NOTES:

- Contours may be changed on site.
- Landscaping should be adjusted to suit site conditions.
- Refer to drawings by others for information on site such as service location. Determine the position of all underground services on site prior to commencing construction.Do not rely solely upon limited services information provided on landscape plans.
- Trees and shrubs should be planted in accordance with FNQROC guidelines and adjusted to suit structures such as lights and power poles (summarized on the detail sheets of these plans).
- Refer to plans by others for finished surface levels. All new finished surfaces should align flush with existing surface levels and retain existing levels to adjacent surfaces unless otherwise instructed by superintendent.
- Refer to plans by others for path and crossover setout, service locations, jointing and conduit in pavements, all structural fixings and reinforcements to pavements and walls etc., lighting and hydraulic elements.
- The final setout for all landscaping should be confirmed on site by the superintendent.
- It is the responsibility of the landscape contractor to check all plant quantities for themselves on the plans. Where plant numbers or species in the schedules differ from those on the plans, the plans have precedence over the schedules. The contractor should immediately contact the landscape designer for clarification if they identify any discrepancies and should not quote on or place orders based solely on the schedules.
- Any changes to the suggested species, including sizes, should be agreed with Suzan Quigg Landscape Designs and council in writing prior to making substitutions.
- All landscape work will be carried out in accordance with FNQROC guidelines, Cairns City in a Garden Guidelines, other relevant codes and any relevant Australian Standards and NATSPEC recommendations.
- The landscape designer will not be responsible for any damage or injuries to persons or property sustained as a result of using the plants nominated in this plan. It is understood that most plants can be toxic or injurious to varying degrees if ingested or handled in inappropriate ways.
- Do not rely upon the accuracy of these plans as they may have been reproduced at a scale different to that nominated on the plans. Verify the scale by checking against the scale bar shown on the plans and do not use these plans for accurate measurements without first checking against other plans such as engineering and building plans.
- If the landscape contractor is subcontracting to a main contractor, then the sub-contract for the landscaping must be awarded early enough for the landscaper to be able to provide all the species nominated in the sizes advised.
- The contractor may need to source these plants from several nurseries WELL IN ADVANCE of the planting times to ensure that the nominated species are available in the sizes required.
- It is the responsibility of the contractor to ensure that he is at all times in possession of the latest revisions to the plans.
- Species have been selected from a range anticipated to suit the anticipated site conditions and preferences of the owner. No guarantee is given as to the success or longevity of the scheme if variations are made to the layout or irrigation/drainage/careful regular maintenance and other cultural conditions are not provided.
- Do not copy or distribute these plans without permission from Suzan Quigg Landscape Designs

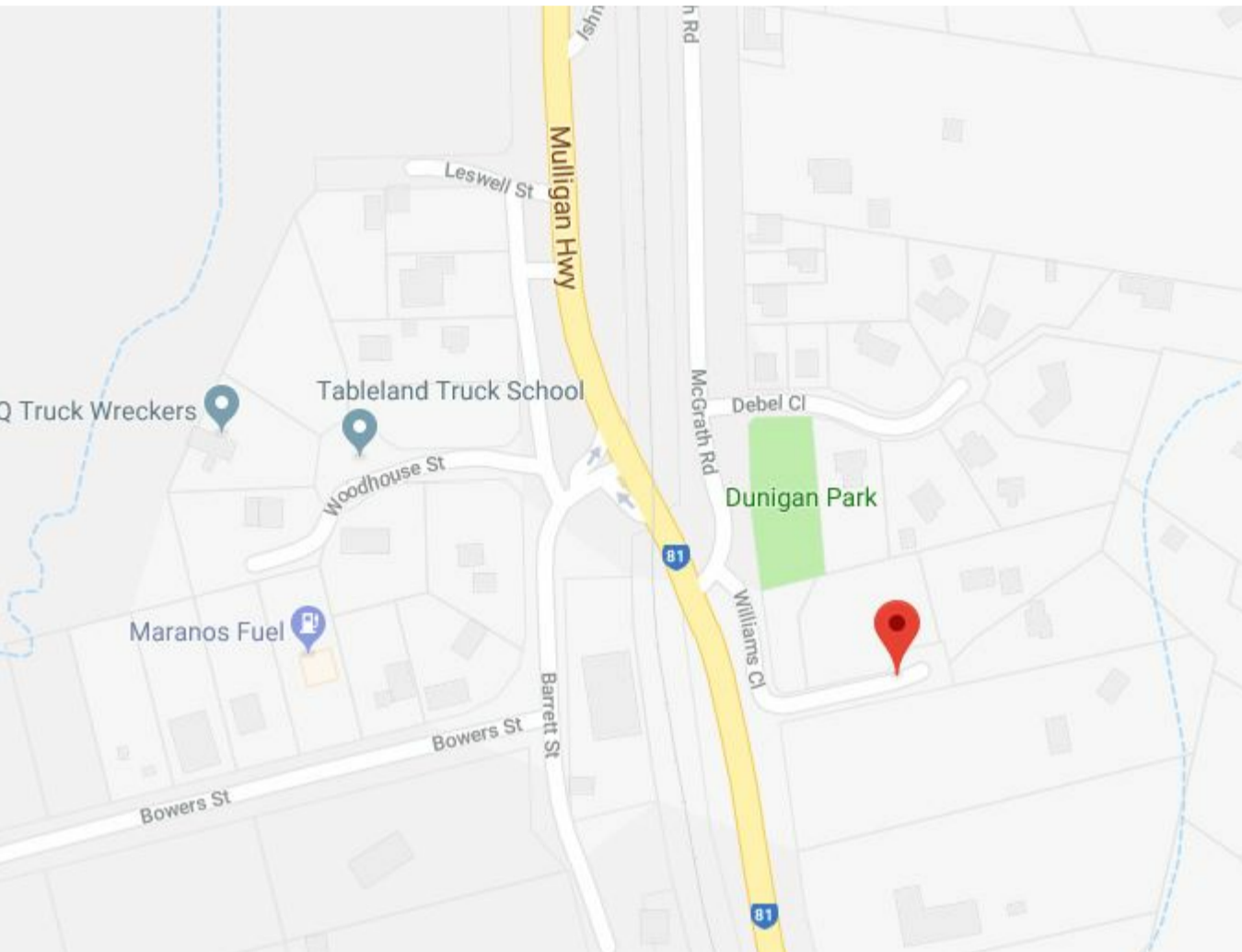

LOCATION MAP (COURTESY GOOGLE MAPS)

Issue	Date	Item
1	13/12/2017	plans to client for comment
1a	16/03/2018	revised plans to client
1b	28/03/2018	Plans to client for Approvals
2	10/05/2018	Revised Plans to client for Approvals

L00 COVER SHEET

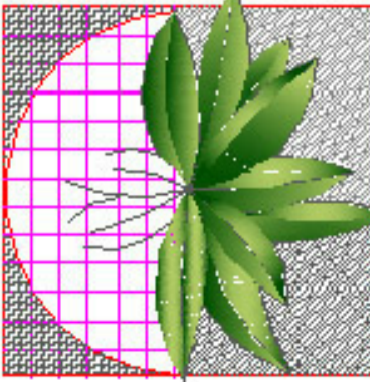

Suzan Quigg Landscape Design
PO Box 638 Malanda QLD 4885 Australia
P: 07 4095 1017 M: 0407 035 381
E: suzanjq@bigpond.com
W: www.suzanquigg.com

©Suzan J Quigg Landscape Design 2018

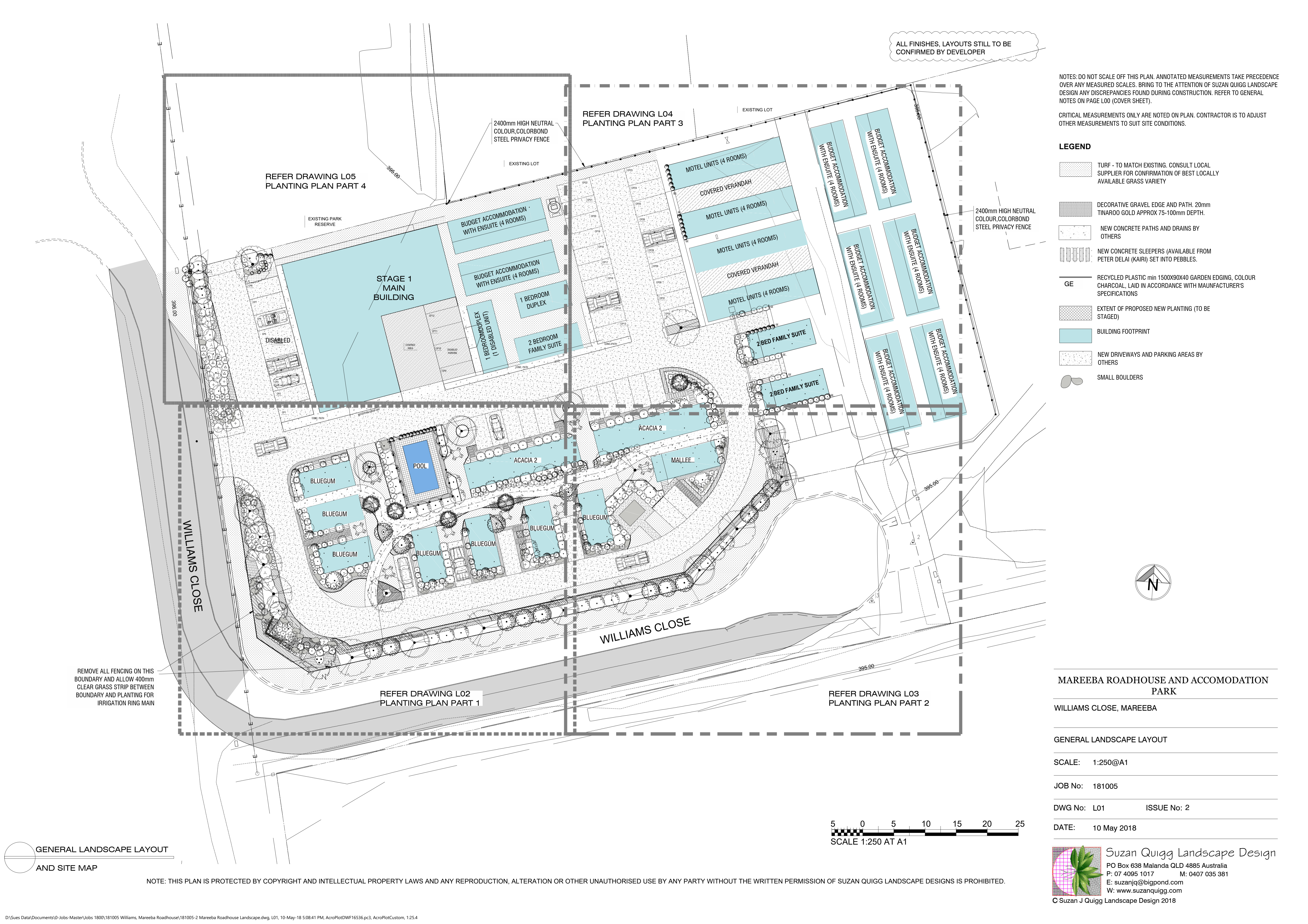

ALL FINISHES, LAYOUTS STILL TO BE
CONFIRMED BY DEVELOPER

NOTES: DO NOT SCALE OFF THIS PLAN. ANNOTATED MEASUREMENTS TAKE PRECEDENCE
OVER ANY MEASURED SCALES. BRING TO THE ATTENTION OF SUZAN QUIGG LANDSCAPE
DESIGN ANY DISCREPANCIES FOUND DURING CONSTRUCTION. REFER TO GENERAL
NOTES ON PAGE L00 (COVER SHEET).

CRITICAL MEASUREMENTS ONLY ARE NOTED ON PLAN. CONTRACTOR IS TO ADJUST
OTHER MEASUREMENTS TO SUIT SITE CONDITIONS.

LEGEND

- TURF - TO MATCH EXISTING. CONSULT LOCAL
SUPPLIER FOR CONFIRMATION OF BEST LOCALLY
AVAILABLE GRASS VARIETY
- DECORATIVE GRAVEL EDGE AND PATH. 20mm
TINAROO GOLD APPROX 75-100mm DEPTH.
- NEW CONCRETE PATHS AND DRAINS BY
OTHERS
- NEW CONCRETE SLEEPERS (AVAILABLE FROM
PETER DELAI (KAIRI) SET INTO PEBBLES.
- RECYCLED PLASTIC min 1500X90X40 GARDEN EDGING. COLOUR
CHARCOAL, LAID IN ACCORDANCE WITH MAUNFACTURER'S
SPECIFICATIONS
- EXTENT OF PROPOSED NEW PLANTING (TO BE
STAGED)
- BUILDING FOOTPRINT
- NEW DRIVEWAYS AND PARKING AREAS BY
OTHERS
- SMALL BOULDERS

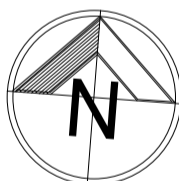

MAREEBA ROADHOUSE AND ACCOMODATION
PARK

WILLIAMS CLOSE, MAREEBA

GENERAL LANDSCAPE LAYOUT

SCALE: 1:250@A1

JOB No: 181005

DWG No: L01 ISSUE No: 2

DATE: 10 May 2018

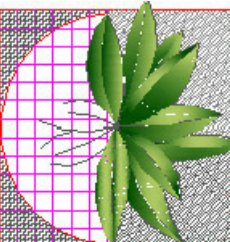

Suzan Quigg Landscape Design
PO Box 638 Malanda QLD 4885 Australia
P: 07 4095 1017 M: 0407 035 381
E: suzanjq@bigpond.com
W: www.suzanquigg.com

© Suzan J Quigg Landscape Design 2018

PLANT SCHEDULE L02

TREES	QTY	BOTANICAL NAME	COMMON NAME	CONT	
CUP ANA	5	CUPANIOPSIS ANACARDIOIDES	CARROT WOOD	100LT BAG	
MAN LEN	4	MANILTOA LENTICELLATA	CASCADING BEAN TREE	400MM POT	
PLU SIN	1	PLUMERIA OBTUSA	SINGAPORE PLUMERIA	400MM POT	
SYZ AUS	10	SYZYGIIUM AUSTRALE `RESILIENCE`	RESILIENCE BRUSH CHERRY	300MM POT	
XAN CHR	7	XANTHOSTEMON CHRYSANTHUS	GOLDEN PENDA	100LT BAG	
PALM TREES	QTY	BOTANICAL NAME	COMMON NAME	CONT	
LIV DEC	1	LIVISTONA DECIPIENS	LIVISTONA PALM	100LT BAG	
SHRUBS	QTY	BOTANICAL NAME	COMMON NAME	CONTAINER SIZE	SPACING
CAL GRB	20	CALLISTEMON X `GREAT BALLS OF FIRE`	BOTTLEBRUSH `GREAT BALLS OF FIRE`	140MM POT	1m
CAS COU	5	CASUARINA GLAUCA `COUSIN IT`	COUSIN IT CASUARINA	200MM POT	0,80m
COD PET	14	CODIAEUM VARIEGATUM `PETRA`	BRAVO CROTON	200MM POT	1,20m
COR TAR	12	CORDYLINE FRUTICOSA `TARTAN`	CORDYLINE `TARTAN`	200MM POT	1,20m
DIE BI2	63	DIETES BICOLOR	FORTNIGHT LILY	140MM POT	1m
DRA BLA	4	DRACAENA MARGINATA `BLACK KNIGHT`	BLACK-LEAVED DRACEANA	140MM POT	1,50m
FUR MED	5	FURCRAEA FOETIDA `MEDIPIOCTA`	MAURITIUS HEMP	200MM POT	1,50m
GRE OR2	1	GREVILLEA X `ORANGE MARMALADE`	GREVILLEA `ORANGE MARMALADE`	200MM POT	3m
HIB CUB	26	HIBISCUS ROSA-SINENSIS `CUBAN ORANGE`	HIBISCUS	200MM POT	1,50m
IXO PRO	33	IXORA X `PRINCE OF ORANGE COMPACT`	MEDIUM ORANGE IXORA	200MM POT	1m
JUN SHO	10	JUNIPERUS CONFERTA	SHORE JUNIPER	200MM POT	1,50m
LOM LIP	92	LOMANDRA CONFERTIFOLIA `LITTLE PAL`	LITTLE PAL MAT RUSH	140MM POT	0,60m
MEL EVO	5	MELICOPE RUBRA	EVODIELLA	140MM POT	2m
MUR MIN	12	MURRAYA PANICULATA `MIN-A-MIN`	DWARF MURRAYA (HEDGE)	200MM POT	0,75m
MUR PAN	15	MURRAYA PANICULATA	ORANGE JESSAMINE	300MM POT	2,50m
SYZ BOO	4	SYZYGIIUM AUSTRALE `AUSSIE BOOMER`	AUSSIE BOOMER LILLY PILLY	200MM POT	1,50m
THY MAX	6	THYSANOLAENA MAXIMA	TIGER GRASS	200MM POT	2m
TIB JAZ	9	TIBOUCHINA URVILLEANA `JAZZIE`	PRINCESS FLOWER	200MM POT	1,50m
XAN NOR	7	XANTHORRHOEA JOHNSONII	NORTHERN GRASS TREE	200MM POT	1,20m
XAN VER	10	XANTHOSTEMON VERTICILLATUS `LITTLE PENDA`	LITTLE PENDA	140MM POT	1,20m
ZAM FUR	8	ZAMIA FURFURACEA	CARDBOARD PALM	200MM POT	1,50m
SHRUB AREAS	QTY	BOTANICAL NAME	COMMON NAME	CONT	SPACING
DIA SIL	46	DIANELLA X `SILVER STREAK`	VARIEGATED DIANELLA	140MM POT	700mm
DIE BIC	29	DIETES BICOLOR	FORTNIGHT LILY	140MM POT	1000mm
EVO PIL	33	EVOLVULUS PILOSUS	BLUE SAPPHIRE	140MM POT	550mm
GAR DWR	25	GARDENIA RADICANS	DWARF GARDENIA	140MM POT	600mm
IXO PRI	14	IXORA X `PRINCE OF ORANGE COMPACT`	MEDIUM ORANGE IXORA	200MM POT	1000mm
LOM LUC	35	LOMANDRA X `LUCKY STRIPE`	VARIEGATED RIVER REED	140MM POT	800mm
GROUND COVERS	QTY	BOTANICAL NAME	COMMON NAME	CONT	SPACING
HEL PET	11	HELICHRYSUM PETIOLARE	LICORICE PLANT	140MM POT	850mm
LOM LIC	10	LOMANDRA CONFERTIFOLIA `LITTLE CRICKET`	SMALL MAT RUSH	140MM POT	500mm
RHO SPA	135	RHOEO SPATHACEA	BOATLILY	140MM POT	550mm
ZEP CAN	20	ZEPHYRANTHES CANDIDA	STORM CROCUS	140MM POT	400mm

MAREEBA ROADHOUSE AND ACCOMODATION PARK

WILLIAMS ROAD, MAREEBA

PLANTING SCHEDULE PART 1

SCALE: N/A

JOB No: 181005

DWG No: L02-2 ISSUE No: 2

DATE: 10 May 2018

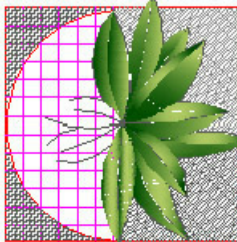

Suzan Quigg Landscape Design
PO Box 638 Malanda QLD 4885 Australia
P: 07 4095 1017 M: 0407 035 381
E: suzanjq@bigpond.com
W: www.suzanquigg.com
© Suzan J Quigg Landscape Design 2018

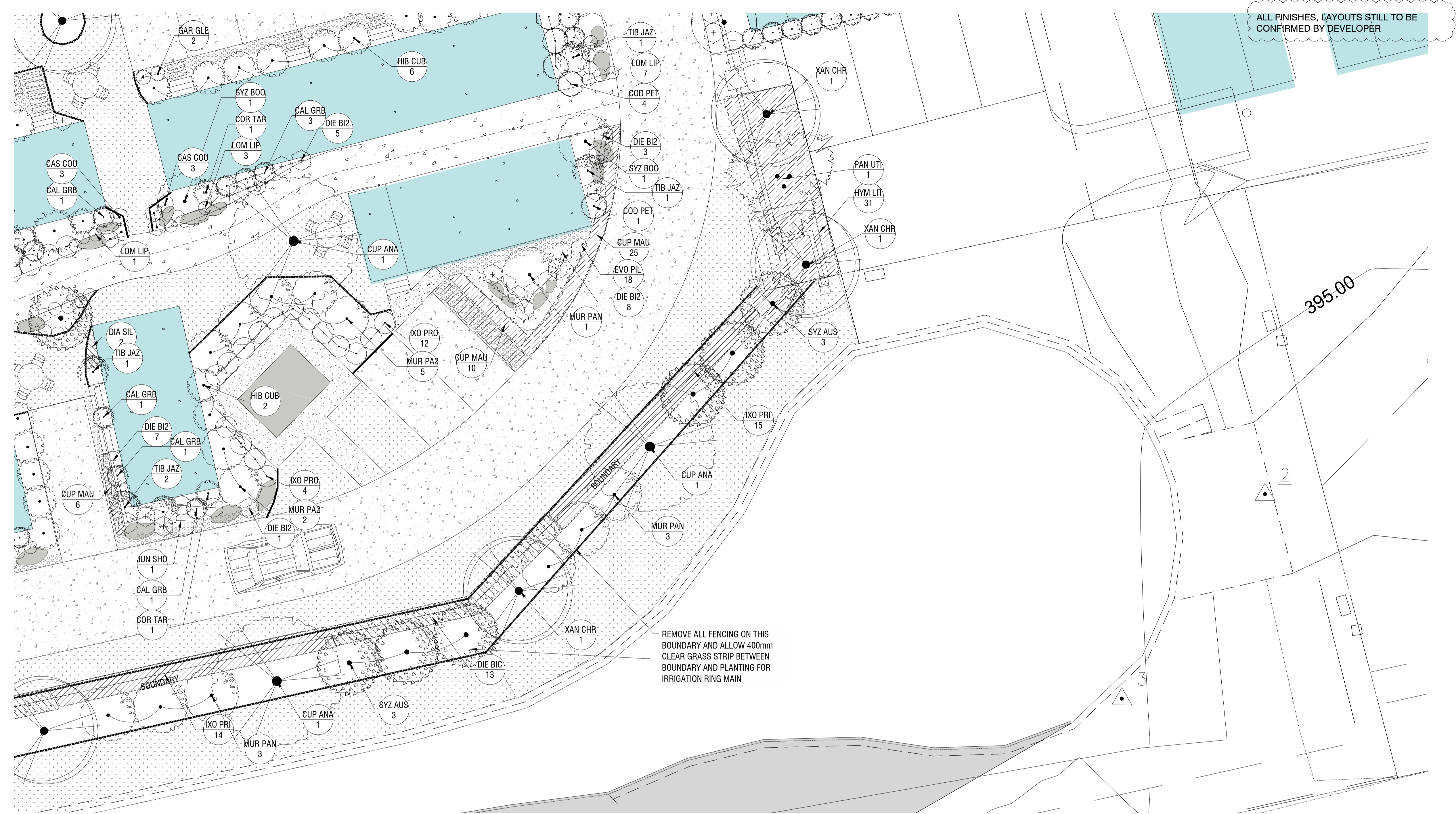

PLANT SCHEDULE L03

TREES	QTY	BOTANICAL NAME	COMMON NAME	CONT	
CUP ANA	3	CUPANIOPSIS ANACARDIOIDES	CARROT WOOD	100LT BAG	
PAN UTI	1	PANDANUS UTILIS	SCREW PINE	100LT BAG	
SYZ AUS	6	SYZYGIVM AUSTRALE `RESILIENCE`	RESILIENCE BRUSH CHERRY	300MM POT	
XAN CHR	3	XANTHOSTEMON CHRYSANTHUS	GOLDEN PENDA	100LT BAG	
SHRUBS	QTY	BOTANICAL NAME	COMMON NAME	CONTAINER SIZE	SPACING
CAL GRB	7	CALLISTEMON X `GREAT BALLS OF FIRE`	BOTTLEBRUSH` `GREAT BALLS OF FIRE`	140MM POT	1m
CAS COU	6	CASUARINA GLAUCA `COUSIN IT`	COUSIN IT CASUARINA	200MM POT	0,80m
COD PET	3	CODIAEUM VARIEGATUM `PETRA`	BRAVO CROTON	200MM POT	1,20m
COR TAR	3	CORDYLINE FRUTICOSA `TARTAN`	CORDYLINE `TARTAN`	200MM POT	1,20m
DIE BI2	24	DIETES BICOLOR	FORTNIGHT LILY	140MM POT	1m
GAR GLE	2	GARDENIA PSIDIOIDES `GLENNIE RIVER`	GARDENIA GLENNIE RIVER	140MM POT	0,70m
HIB CUB	7	HIBISCUS ROSA-SINENSIS `CUBAN ORANGE`	HIBISCUS	200MM POT	1,50m
IXO PRO	16	IXORA X `PRINCE OF ORANGE COMPACT`	MEDIUM ORANGE IXORA	200MM POT	1m
JUN SHO	1	JUNIPERUS CONFERTA	SHORE JUNIPER	200MM POT	1,50m
LOM LIP	12	LOMANDRA CONFERTIFOLIA `LITTLE PAL`	LITTLE PAL MAT RUSH	140MM POT	0,60m
MUR PA2	7	MURRAYA PANICULATA	ORANGE JESSAMINE (TOPIARIED)	200MM POT	2m
MUR PAN	7	MURRAYA PANICULATA	ORANGE JESSAMINE	300MM POT	2,50m
SYZ BOO	2	SYZYGIVM AUSTRALE `AUSSIE BOOMER`	AUSSIE BOOMER LILLY PILLY	200MM POT	1,50m
TIB JAZ	5	TIBOUCHINA URVILLEANA `JAZZIE`	PRINCESS FLOWER	200MM POT	1,50m
SHRUB AREAS	QTY	BOTANICAL NAME	COMMON NAME	CONT	SPACING
CUP MAU	41	CUPHEA HYSSOPIFOLIA `MAUVE`	MAUVE MAD HATTER	140MM POT	550mm
DIA SIL	2	DIANELLA X `SILVER STREAK`	VARIEGATED DIANELLA	140MM POT	700mm
DIE BIC	13	DIETES BICOLOR	FORTNIGHT LILY	140MM POT	1000mm
EVO PIL	18	EVOLVULUS PILOSUS	BLUE SAPPHIRE	140MM POT	550mm
HYM LIT	31	HYMENOCALLIS LITTORALIS	SPIDER LILY	BARE-ROOTED	1000mm
IXO PRI	29	IXORA X `PRINCE OF ORANGE COMPACT`	MEDIUM ORANGE IXORA	200MM POT	1000mm

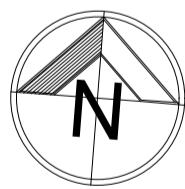

MAREEBA ROADHOUSE AND ACCOMODATION PARK

WILLIAMS CLOSE, MAREEBA

PLANTING PLAN PART 1

SCALE: 1:100@A1

JOB No: 181005

DWG No: L03-1 ISSUE No: 2

DATE: 10 May 2018

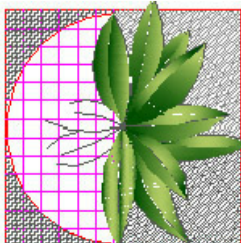

Suzan Quigg Landscape Design
PO Box 638 Malanda QLD 4885 Australia
P: 07 4095 1017 M: 0407 035 381
E: suzanjq@bigpond.com
W: www.suzanquigg.com
C Suzan J Quigg Landscape Design 2018

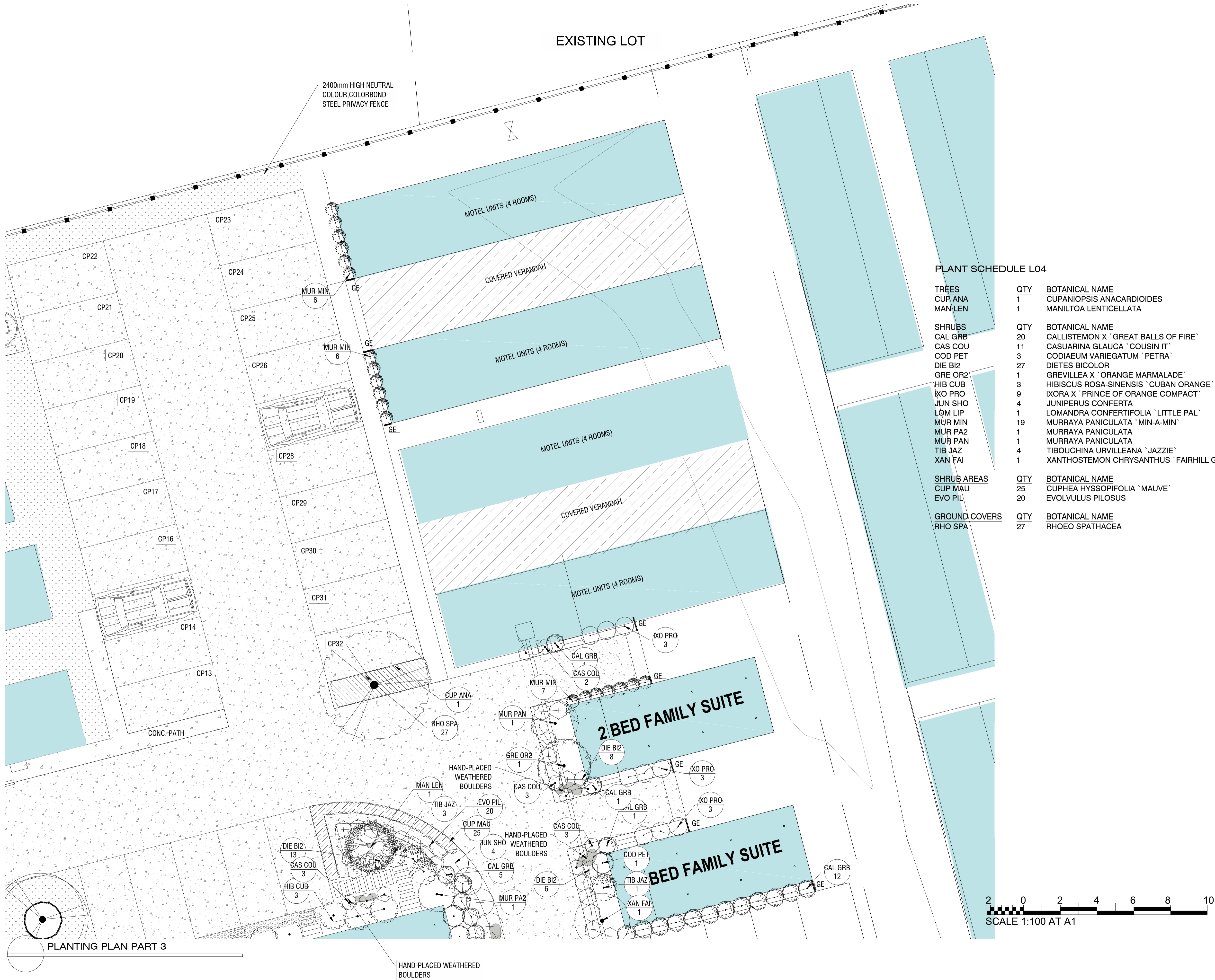

MAREEBA ROADHOUSE AND ACCOMODATION PARK

WILLIAMS ROAD, MAREEBA

PLANTING PLAN AND PLANT SCHEDULE PART 3

SCALE: 1:100@A1

JOB No: 181005

DWG No: L04 ISSUE No: 2

DATE: 10 May 2018

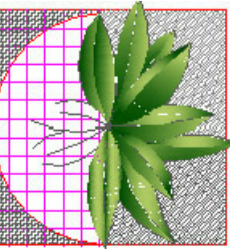

Suzan Quigg Landscape Design
PO Box 638 Malanda QLD 4885 Australia
P: 07 4095 1017 M: 0407 035 381
E: suzanjq@bigpond.com
W: www.suzanquigg.com
© Suzan J Quigg Landscape Design 2018

NOTE: THIS PLAN IS PROTECTED BY COPYRIGHT AND INTELLECTUAL PROPERTY LAWS AND ANY REPRODUCTION, ALTERATION OR OTHER UNAUTHORISED USE BY ANY PARTY WITHOUT THE WRITTEN PERMISSION OF SUZAN QUIGG LANDSCAPE DESIGNS IS PROHIBITED.

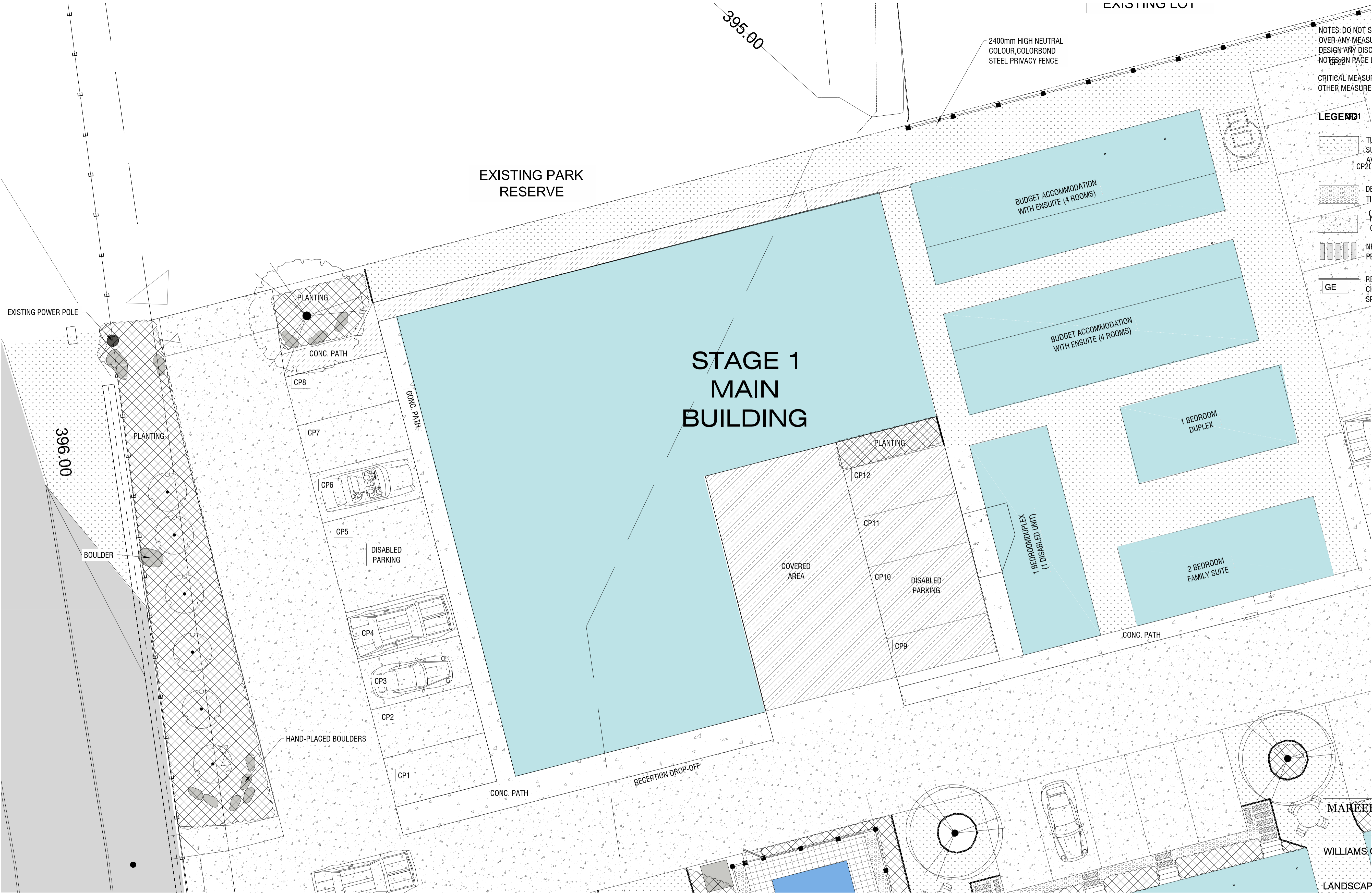

NOTES: DO NOT SCALE OFF THIS PLAN. ANNOTATED MEASUREMENTS TAKE PRECEDENCE OVER ANY MEASURED SCALES. BRING TO THE ATTENTION OF SUZAN QUIGG LANDSCAPE DESIGN ANY DISCREPANCIES FOUND DURING CONSTRUCTION. REFER TO GENERAL NOTES ON PAGE L00 (COVER SHEET).

CRITICAL MEASUREMENTS ONLY ARE NOTED ON PLAN. CONTRACTOR IS TO ADJUST OTHER MEASUREMENTS TO SUIT SITE CONDITIONS.

- LEGEND**
- TURF - TO MATCH EXISTING. CONSULT LOCAL SUPPLIER FOR CONFIRMATION OF BEST LOCALLY AVAILABLE GRASS VARIETY
 - DECORATIVE GRAVEL EDGE AND PATH. 20mm TINAROO GOLD APPROX 75-100mm DEPTH.
 - NEW CONCRETE PATHS AND DRAINS BY OTHERS
 - NEW CONCRETE SLEEPERS (AVAILABLE FROM PETER DELAI (KAIRI) SET INTO PEBBLES.
 - RECYCLED PLASTIC min 1500X90X40 GARDEN EDGING, COLOUR CHARCOAL. LAID IN ACCORDANCE WITH MAUNFACTURER'S SPECIFICATIONS

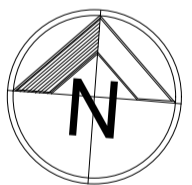

MAREEBA ROADHOUSE AND ACCOMODATION PARK

WILLIAMS CLOSE, MAREEBA

LANDSCAPE LAYOUT PART 4

SCALE: 1:100@A1

JOB No: 181005

DWG No: L05 ISSUE No: 2

DATE: 10 May 2018

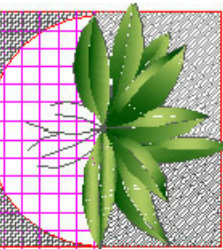

Suzan Quigg Landscape Design
PO Box 638 Malanda QLD 4885 Australia
P: 07 4095 1017 M: 0407 035 381
E: suzanjq@bigpond.com
W: www.suzanquigg.com
© Suzan J Quigg Landscape Design 2018

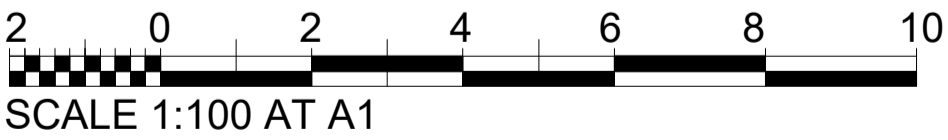

NOTE: THIS PLAN IS PROTECTED BY COPYRIGHT AND INTELLECTUAL PROPERTY LAWS AND ANY REPRODUCTION, ALTERATION OR OTHER UNAUTHORISED USE BY ANY PARTY WITHOUT THE WRITTEN PERMISSION OF SUZAN QUIGG LANDSCAPE DESIGNS IS PROHIBITED.

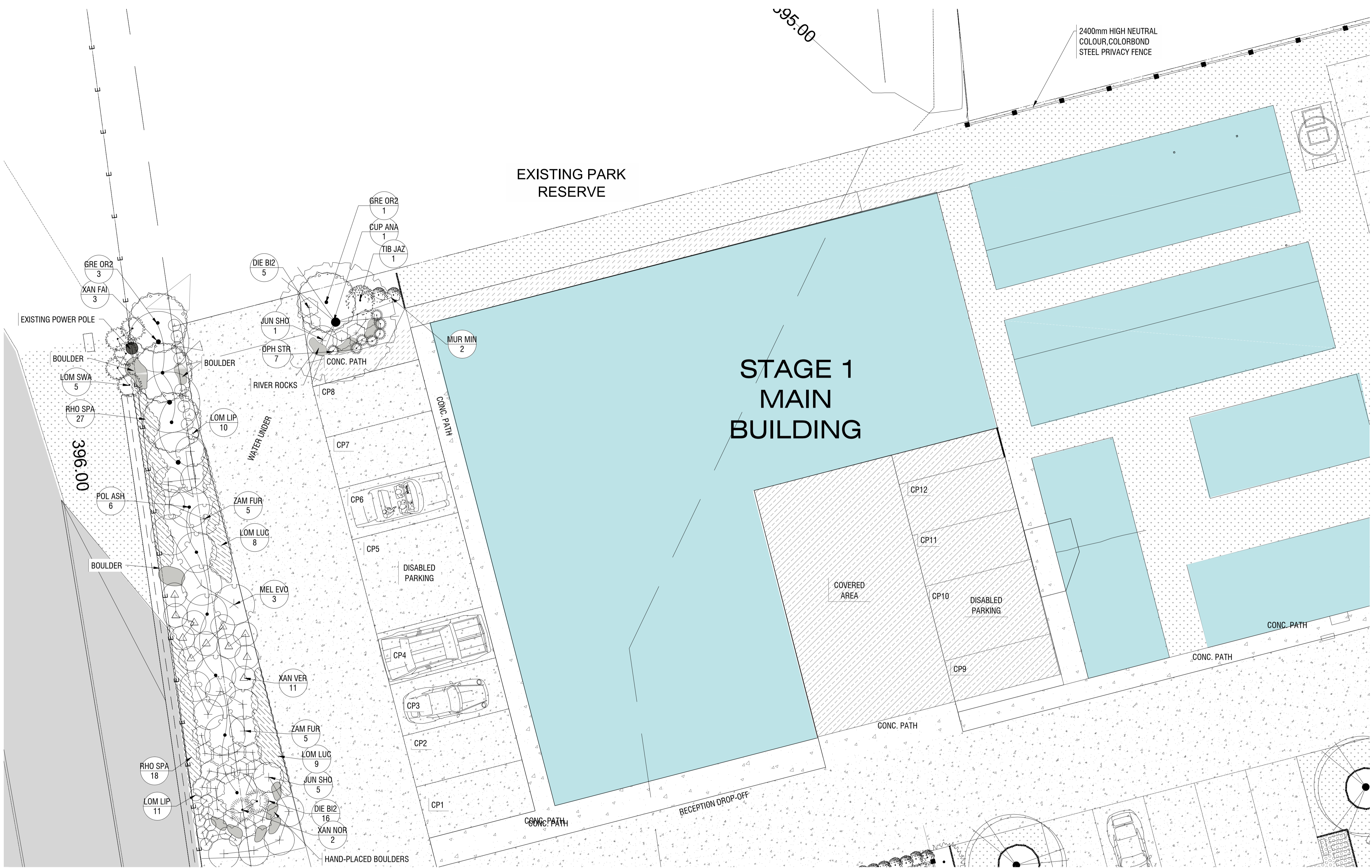

ALL FINISHES, LAYOUTS STILL TO BE
CONFIRMED BY DEVELOPER

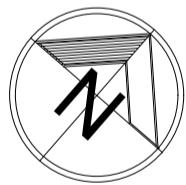

PLANT SCHEDULE L05

TREES	QTY	BOTANICAL NAME	COMMON NAME	CONT	
CUP ANA	1	CUPANIOPSIS ANACARDIOIDES	CARROT WOOD	100LT BAG	
POL ASH	6	POLYALTHIA LONGIFOLIA	ASHOK	100LT BAG	
SHRUBS	QTY	BOTANICAL NAME	COMMON NAME	CONTAINER SIZE	SPACING
DIE BI2	21	DIETES BICOLOR	FORTNIGHT LILY	140MM POT	1m
GRE OR2	4	GREVILLEA X `ORANGE MARMALADE`	GREVILLEA `ORANGE MARMALADE`	200MM POT	3m
JUN SHO	6	JUNIPERUS CONFERTA	SHORE JUNIPER	200MM POT	1,50m
LOM LIP	21	LOMANDRA CONFERTIFOLIA `LITTLE PAL`	LITTLE PAL MAT RUSH	140MM POT	0,60m
LOM SWA	5	LOMANDRA HYSTRIX	SWAMP MAT RUSH	200MM POT	1,20m
MEL EVO	3	MELICOPE RUBRA	EVODIELLA	140MM POT	2m
MUR MIN	2	MURRAYA PANICULATA `MIN-A-MIN`	DWARF MURRAYA (HEDGE)	200MM POT	0,75m
OPH STR	7	OPHIOPOGON INTERMEDIANS `STRIPEY WHITE`	VARIEGATED MONDO GRASS	140MM POT	0,60m
TIB JAZ	1	TIBOUCHINA URVILLEANA `JAZZIE`	PRINCESS FLOWER	200MM POT	1,50m
XAN FAI	3	XANTHOSTEMON CHRYSANTHUS `FAIRHILL GOLD`	DWARF GOLDEN PENDA	300MM POT	3m
XAN NOR	2	XANTHORRHOEA JOHNSONII	NORTHERN GRASS TREE	200MM POT	1,20m
XAN VER	11	XANTHOSTEMON VERTICILLATUS `LITTLE PENDA`	LITTLE PENDA	140MM POT	1,20m
ZAM FUR	10	ZAMIA FURFURACEA	CARDBOARD PALM	200MM POT	1,50m
SHRUB AREAS	QTY	BOTANICAL NAME	COMMON NAME	CONT	SPACING
LOM LUC	17	LOMANDRA X `LUCKY STRIPE`	VARIEGATED RIVER REED	140MM POT	800mm
GROUND COVERS	QTY	BOTANICAL NAME	COMMON NAME	CONT	SPACING
RHO SPA	45	RHOEO SPATHACEA	BOATLILY	140MM POT	550mm

MAREEBA ROADHOUSE AND ACCOMODATION
PARK

WILLIAMS ROAD, MAREEBA

PLANTING PLAN AND PLANT SCHEDULE PART 4

SCALE: 1:100@A1

JOB No: 181005

DWG No: L05-1 ISSUE No: 2

DATE: 10 May 2018

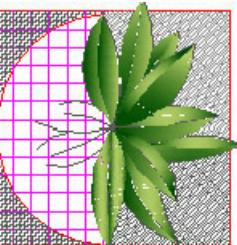

Suzan Quigg Landscape Design
PO Box 638 Malanda QLD 4885 Australia
P: 07 4095 1017 M: 0407 035 381
E: suzanjq@bigpond.com
W: www.suzanquigg.com

© Suzan J Quigg Landscape Design 2017

PLANTING PLAN PART 4

NOTE: THIS PLAN IS PROTECTED BY COPYRIGHT AND INTELLECTUAL PROPERTY LAWS AND ANY REPRODUCTION, ALTERATION OR OTHER UNAUTHORISED USE BY ANY PARTY WITHOUT THE WRITTEN PERMISSION OF SUZAN QUIGG LANDSCAPE DESIGNS IS PROHIBITED.

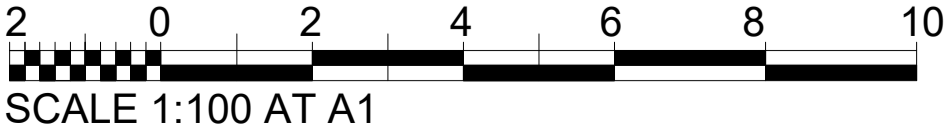

SCALE 1:100 AT A1

PLANT SCHEDULE

TREES	QTY	BOTANICAL NAME	COMMON NAME	CONT	
CUP ANA	10	CUPANIOPSIS ANACARDIOIDES	CARROT WOOD	100LT BAG	
MAN LEN	5	MANILTOA LENTICELLATA	CASCADING BEAN TREE	400MM POT	
PAN UTI	1	PANDANUS UTILIS	SCREW PINE	100LT BAG	
PLU SIN	1	PLUMERIA OBTUSA	SINGAPORE PLUMERIA	400MM POT	
POL ASH	6	POLYALTHIA LONGIFOLIA	ASHOK	100LT BAG	
SYZ AUS	17	SYZYGIIUM AUSTRALE `RESILIENCE`	RESILIENCE BRUSH CHERRY	300MM POT	
XAN CHR	10	XANTHOSTEMON CHRYSANTHUS	GOLDEN PENDA	100LT BAG	
PALM TREES	QTY	BOTANICAL NAME	COMMON NAME	CONT	
LIV DEC	1	LIVISTONA DECIPIENS	LIVISTONA PALM	100LT BAG	
SHRUBS	QTY	BOTANICAL NAME	COMMON NAME	CONTAINER SIZE	SPACING
CAL GRB	47	CALLISTEMON X `GREAT BALLS OF FIRE`	BOTTLEBRUSH `GREAT BALLS OF FIRE`	140MM POT	1m
CAS COU	22	CASUARINA GLAUCA `COUSIN IT`	COUSIN IT CASUARINA	200MM POT	0,80m
COD PET	20	CODIAEUM VARIEGATUM `PETRA`	BRAVO CROTON	200MM POT	1,20m
COR TAR	14	CORDYLINE FRUTICOSA `TARTAN`	CORDYLINE `TARTAN`	200MM POT	1,20m
DIE BI2	135	DIETES BICOLOR	FORTNIGHT LILY	140MM POT	1m
DRA BLA	4	DRACAENA MARGINATA `BLACK KNIGHT`	BLACK-LEAVED DRACEANA	140MM POT	1,50m
FUR MED	5	FURCRAEA FOETIDA `MEDIOPICTA`	MAURITIUS HEMP	200MM POT	1,50m
GAR GLE	2	GARDENIA PSIDIOIDES `GLENNIE RIVER`	GARDENIA GLENNIE RIVER	140MM POT	0,70m
GRE OR2	6	GREVILLEA X `ORANGE MARMALADE`	GREVILLEA `ORANGE MARMALADE`	200MM POT	3m
HIB CUB	37	HIBISCUS ROSA-SINENSIS `CUBAN ORANGE`	HIBISCUS	200MM POT	1,50m
IXO PRO	58	IXORA X `PRINCE OF ORANGE COMPACT`	MEDIUM ORANGE IXORA	200MM POT	1m
JUN SHO	21	JUNIPERUS CONFERTA	SHORE JUNIPER	200MM POT	1,50m
LOM LIP	125	LOMANDRA CONFERTIFOLIA `LITTLE PAL`	LITTLE PAL MAT RUSH	140MM POT	0,60m
LOM SWA	5	LOMANDRA HYSTRIX	SWAMP MAT RUSH	200MM POT	1,20m
MEL EVO	8	MELICOPE RUBRA	EVODIELLA	140MM POT	2m
MUR MIN	33	MURRAYA PANICULATA `MIN-A-MIN`	DWARF MURRAYA (HEDGE)	200MM POT	0,75m
MUR PA2	9	MURRAYA PANICULATA	ORANGE JESSAMINE (TOPIARIED)	200MM POT	2m
MUR PAN	23	MURRAYA PANICULATA	ORANGE JESSAMINE	300MM POT	2,50m
OPH STR	7	OPHIPOGON INTERMEDIANS `STRIPEY WHITE`	VARIEGATED MONDO GRASS	140MM POT	0,60m
SYZ BOO	6	SYZYGIIUM AUSTRALE `AUSSIE BOOMER`	AUSSIE BOOMER LILLY PILLY	200MM POT	2,50m
THY MAX	7	THYSANOLAENA MAXIMA	TIGER GRASS	200MM POT	2m
TIB JAZ	19	TIBOUCHINA URVILLEANA `JAZZIE`	PRINCESS FLOWER	200MM POT	1,50m
XAN FAI	4	XANTHOSTEMON CHRYSANTHUS `FAIRHILL GOLD`	DWARF GOLDEN PENDA	300MM POT	3m
XAN NOR	9	XANTHORRHOEA JOHNSONII	NORTHERN GRASS TREE	200MM POT	1,20m
XAN VER	21	XANTHOSTEMON VERTICILLATUS `LITTLE PENDA`	LITTLE PENDA	140MM POT	1,20m
ZAM FUR	18	ZAMIA FURFURACEA	CARDBOARD PALM	200MM POT	1,50m
SHRUB AREAS	QTY	BOTANICAL NAME	COMMON NAME	CONT	SPACING
CUP MAU	66	CUPHEA HYSSOPIFOLIA `MAUVE`	MAUVE MAD HATTER	140MM POT	550mm
DIA SIL	48	DIANELLA X `SILVER STREAK`	VARIEGATED DIANELLA	140MM POT	700mm
DIE BIC	42	DIETES BICOLOR	FORTNIGHT LILY	140MM POT	1000mm
EVO PIL	71	EVOLVULUS PILOSUS	BLUE SAPPHIRE	140MM POT	550mm
GAR DWR	25	GARDENIA RADICANS	DWARF GARDENIA	140MM POT	600mm
HYM LIT	31	HYMENOCALLIS LITTORALIS	SPIDER LILY	BARE-ROOTED	1000mm
IXO PRI	43	IXORA X `PRINCE OF ORANGE COMPACT`	MEDIUM ORANGE IXORA	200MM POT	1000mm
LOM LUC	52	LOMANDRA X `LUCKY STRIPE`	VARIEGATED RIVER REED	140MM POT	800mm
GROUND COVERS	QTY	BOTANICAL NAME	COMMON NAME	CONT	SPACING
HEL PET	11	HELICHRYSUM PETIOLARE	LICORICE PLANT	140MM POT	850mm
LOM LIC	10	LOMANDRA CONFERTIFOLIA `LITTLE CRICKET`	SMALL MAT RUSH	140MM POT	500mm
RHO SPA	207	RHOEO SPATHACEA	BOATLILY	140MM POT	550mm
ZEP CAN	20	ZEPHYRANTHES CANDIDA	STORM CROCUS	140MM POT	400mm

MAREEBA ROADHOUSE AND ACCOMODATION
PARK

WILLIAMS ROAD, MAREEBA

OVERALL PLANT SCHEDULE

SCALE: N/A

JOB No: 181005

DWG No: L06 ISSUE No: 2

DATE: 10 May 2018

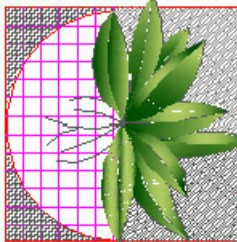

Suzan Quigg Landscape Design

PO Box 638 Malanda QLD 4885 Australia
P: 07 4095 1017 M: 0407 035 381
E: suzanjq@bigpond.com
W: www.suzanquigg.com

© Suzan J Quigg Landscape Design 2018

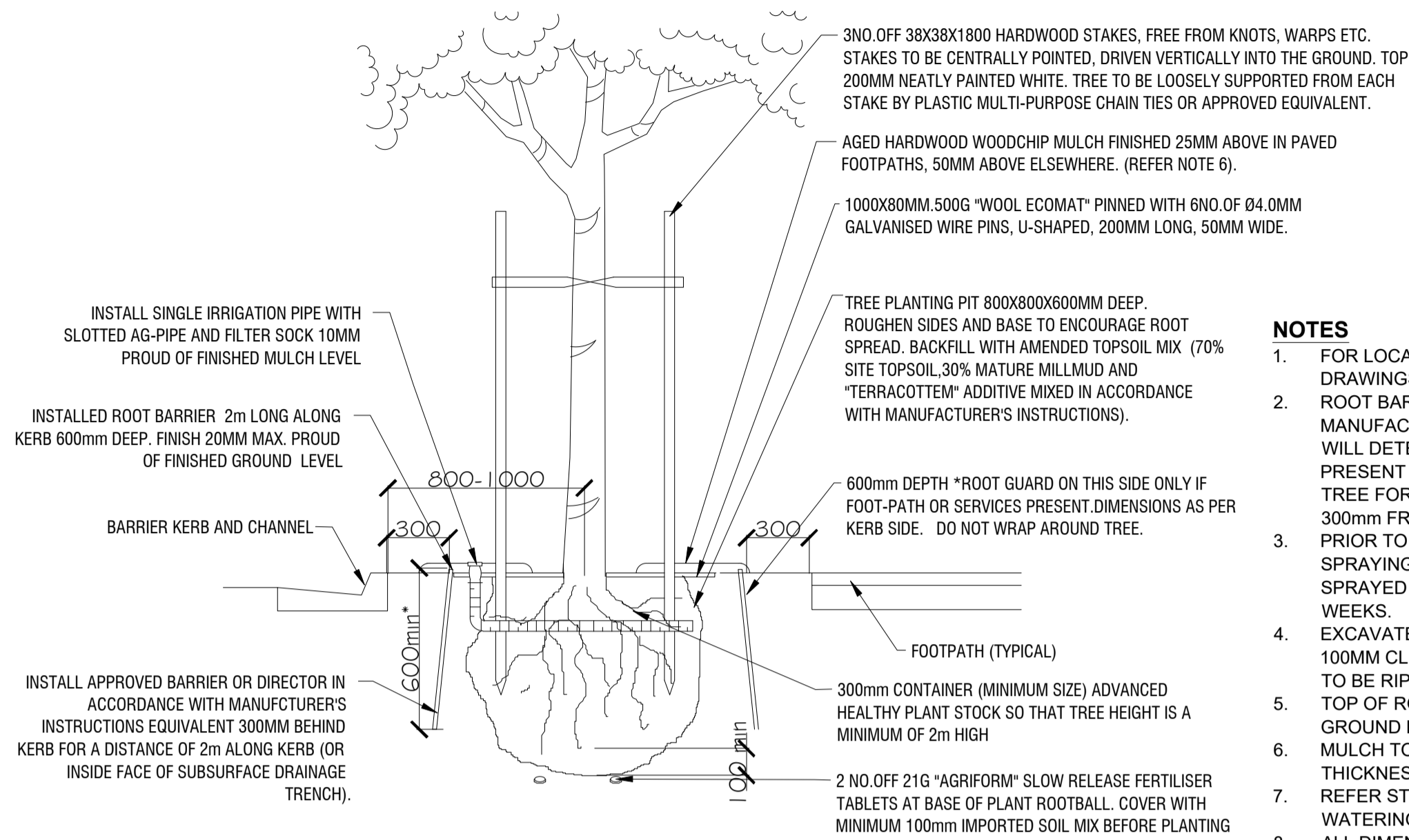

- NOTES**
- FOR LOCATION AND SPECIES OF TREES REFER PROJECT DRAWINGS.
 - ROOT BARRIERS - INSTALL IN ACCORDANCE WITH MANUFACTURER'S INSTRUCTIONS. *DEPTH OF SERVICES WILL DETERMINE BARRIER TYPE. IF PATH OR SERVICES ARE PRESENT THEN USE ROOT BARRIER ON BOTH SIDES OF TREE FOR A DISTANCE OF 2m ALONG KERB AND FOOTPATH 300mm FROM BOTH.
 - PRIOR TO PLANTING ALL WEEDS SHALL BE KILLED BY SPRAYING A SUITABLE GLYPHOSATE BASED HERBICIDE. SPRAYED AREA SHALL REMAIN UNDISTURBED FOR TWO WEEKS.
 - EXCAVATED PLANTING HOLE SHALL ALLOW FOR A MINIMUM 100MM CLEARANCE AROUND THE ROOTBALL. BASE OF HOLE TO BE RIPPED TO 150MM DEPTH TO PROMOTE DRAINAGE. TOP OF ROOTBALL TO BE FINISHED FLUSH WITH EXISTING GROUND LEVEL.
 - MULCH TO BE 75MM THICK IN PAVED FOOTPATHS. 125MM THICKNESS ELSEWHERE. REFER STANDARD SPECIFICATION FOR MAINTENANCE AND WATERING REQUIREMENTS.
 - ALL DIMENSIONS ARE IN MILLIMETRES.

1 S4210 STREET TREE PLANTING
NTS

- 1 Compacted subgrade
- 2 150mm Depth cultivated subgrade to turf area
- 3 100mm Deep topsoil to turf areas
- 4 Turf - Refer to specification for species
- 5 150mm Depth cultivated subsoil to planted areas
- 6 300mm Deep topsoil to planted areas
- 7 100mm Deep organic mulch as specified
- 8 Replas edge fixed in accordance with manufacturer's instructions

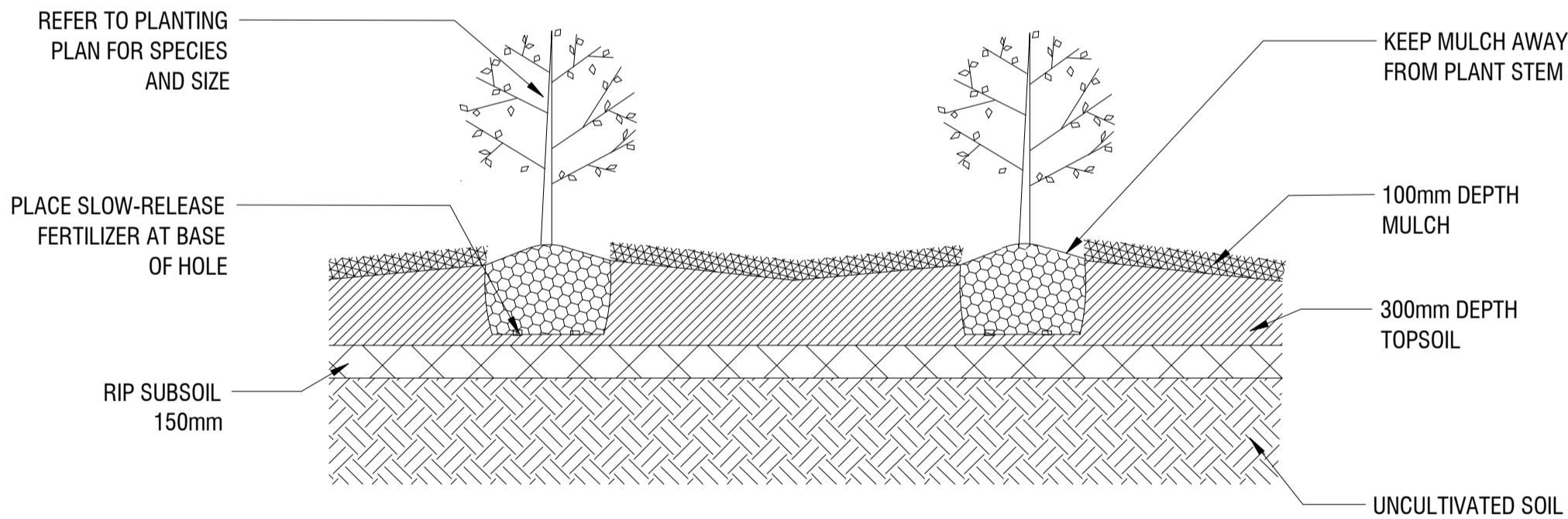
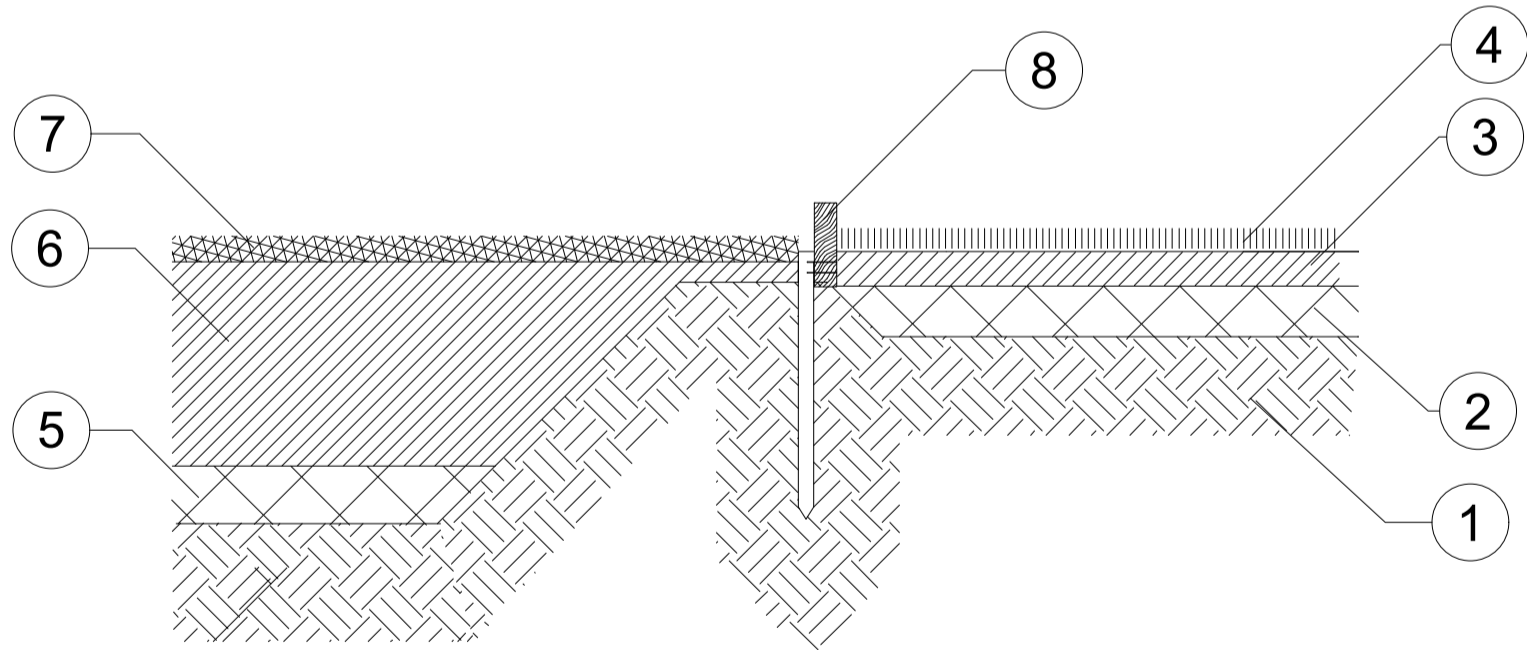

3 SHRUB PLANTING
NTS

2 GARDEN EDGING SLEEPER STYLE
NTS

MAREEBA ROADHOUSE AND ACCOMODATION
PARK

WILLIAMS ROAD, MAREEBA

GENERAL DETAILS

SCALE: N/A

JOB No: 181005

DWG No: L07 ISSUE No: 2

DATE: 10 May 2018

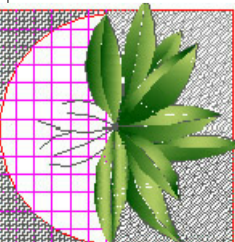

Suzan Quigg Landscape Design
PO Box 638 Malanda QLD 4885 Australia
P: 07 4095 1017 M: 0407 035 381
E: suzanjq@bigpond.com
W: www.suzanquigg.com
© Suzan J Quigg Landscape Design 2018

NOTE: THIS PLAN IS COPYRIGHTED BY SUZAN QUIGG LANDSCAPE DESIGNS AND ANY REPRODUCTION, ALTERATION OR OTHER UNAUTHORISED USE BY ANY PARTY WITHOUT THE WRITTEN PERMISSION OF THE OWNER IS NOT PERMITTED.

GENERAL DETAILS

- GENERAL
- ALL WORK IS TO BE CARRIED OUT BY LICENSED CONTRACTORS IN ACCORDANCE WITH ALL AUSTRALIAN, NATSPEC AND LOCAL GOVERNMENT CODES AND STANDARDS.
 - REFER ALSO TO INFORMATION ON L00
 - LOCATE ALL SERVICES BEFORE DOING ANY WORK.
- EXISTING - VEGETATION PROTECTION
- DO NOT REMOVE OR PRUNE ANY TREES OR SHRUBS WITHOUT FIRST CHECKING WITH THE SUPERINTENDENT WHO SHOULD MAKE SURE ALL NECESSARY PERMITS HAVE BEEN ISSUED. THE SUPERVISOR SHOULD NOTIFY COUNCIL THAT TREE REMOVAL OR PRUNING IS TO OCCUR IN ADVANCE OF THE WORK, ENABLING THEM TO BE PRESENT IF DESIRED.
 - ALL TREES TO BE RETAINED SHALL BE PROTECTED DURING CONSTRUCTION IN ACCORDANCE WITH AS4970-2009. A MINIMUM OF 2m (OR AS SUITS CALCULATED RPZ) FROM THE TRUNK IS TO BE FENCED WITH BARRIER FENCING TO PREVENT ANY TRAFFIC (VEHICLE OR OTHERWISE) WITHIN THIS AREA. DO NOT STORE ANY HARMFUL OR BULK CHEMICALS NEAR TREES OR SHRUBS WHICH ARE TO BE RETAINED. DO NOT ALTER GROUND LEVELS OR MOISTURE AROUND TREES.
 - ONLY A QUALIFIED ARBORIST IS TO CARRY OUT ANY REQUIRED REMEDIAL WORK ON PROTECTED TREES. THE ARBORIST SHOULD CHECK THE HEALTH OF ANY EXISTING TREES WHICH MIGHT IMPACT ON THE LANDSCAPED AREAS. TREES SHOULD BE PRUNED AS NECESSARY UNDER HIS/HER INSTRUCTION TO REMOVE ANY DEAD, DYING, DISEASED, UNHEALTHY OR UNSIGHTLY GROWTH. TREAT ALL WOUNDS TO THE TREES WITH BITUMENOUS PAINT TO PREVENT ENTRY OF FUNGAL SPORES.
 - IF DIRECTED AREA AROUND SPECIFIC AND SIGNIFICANT TREES MAY NEED TO BE AERATED, FERTILISED AND WATERED AS PART OF THE GENERAL MAINTENANCE PROGRAM.
- WEED CONTROL AND SITE PREPARATION
- REMOVE ANY WOODY AND HERBACEOUS WEEDS, GRASSES AND DECLARED PEST PLANTS BY MECHANICAL MEANS, CAREFULLY DISPOSING OF ALL REMOVED MATERIAL, OBSERVING ALL LOCAL AUTHORITY AND ENVIRONMENTAL AGENCY REQUIREMENTS.
 - DO NOT TRANSPORT SOIL BETWEEN SITES AND CHECK THAT ALL MACHINERY, VEHICLES AND SHOES ARE CLEANED BEFORE LEAVING THE SITE.
 - SITE PREPARATION INVOLVES 2 APPLICATIONS OF A NON-RESIDUAL GLYPHOSATE HERBICIDE 2 MONTHS PRIOR TO PLANTING APPLIED IN ACCORDANCE WITH THE MANUFACTURER'S INSTRUCTIONS. THE SECOND APPLICATION WILL BE ONE MONTH AFTER THE FIRST TO ENSURE THAT ANY AREAS MISSED IN THE INITIAL APPLICATION ARE TREATED.
 - TREAT ANY WOODY WEEDS WITH SEMBRA SPRAYED AT REGULAR INTERVALS APPLIED IN ACCORDANCE WITH MANUFACTURER'S INSTRUCTIONS.
 - CHECK THAT ALL MACHINERY, VEHICLES AND SHOES ARE CLEANED BEFORE LEAVING THE SITE.
 - THE LANDSCAPE CONTRACTOR IN ASSOCIATION WITH THE CIVIL CONTRACTOR WILL BE RESPONSIBLE FOR ADEQUATE DRAINAGE OF THE SITE DURING THE CONSTRUCTION PERIOD. EROSION AND SEDIMENT CONTROL BARRIERS WILL BE ERECTED AS PART OF THE SITE PREPARATION WORKS.REFER TO CIVIL PLANS
- SUB-SOIL
- CULTIVATE SUBGRADE TO 150MM DEPTH BELOW PLANTING PIT. REMOVE ALL ROCKS, STONES AND RUBBLE THAT EXCEEDS 75MM DIA.
 - IF REQUIRED PROVIDE SUBSOIL DRAINAGE TO ALL GARDEN BEDS TO PREVENT WATER POOLING IN GARDEN BEDS AND CONNECT TO STORMWATER DRAINAGE SYSTEM.
- SERVICES ACCESS
- INSTALL CONDUITS UNDER PAVEMENTS IF REQUIRED FOR IRRIGATION.
- TOPSOIL
- THE QUALITY OF TOPSOIL PILED ON THE SITE SHALL BE CHECKED AND IF ADEQUATE FOR USE WITH THE ADDITION OF SUITABLE ADDITIVES, THEN THIS MAY BE USED IN PLACE OF IMPORTED TOPSOIL PROVIDED THAT IT COMPLIES WITH THE RELEVANT AUSTRALIAN STANDARDS. PROVIDE SAMPLES OF A ONE LITRE BAG OF ANY PROPOSED TOPSOIL TO BE USED.
 - ALL IMPORTED TOPSOIL SHALL CONFORM TO AS4419(INT) AND SHALL BE A PREMIUM QUALITY LANDSCAPING SOIL MIX IMPORTED FROM AN APPROVED SOURCE.
 - SOIL FOR NATIVES SHALL BE LOW IN PHOSPHOROUS TO COMPLY WITH PARAGRAPH 5.8 OF AS4419-2003.
 - SOIL SHALL CONTAIN APPROXIMATELY 70% SANDY LOAM AND 30% COMPOSTED OR MATURE ORGANIC MATTER
 - IT SHALL BE FRIABLE AND NOT CONTAIN ANY CLAY
 - THE PH SHOULD BE BETWEEN 5.5 AND 7.0
 - IT SHALL BE FREE FROM CONTAMINANTS SUCH AS THE SEED OF DECLARED WEEDS, ROCKS AND SALTS
 - IT SHALL NOT CONTAIN ANY CHEMICAL FERTILIZERS.

SOIL ADDITIVES (ESSENTIAL)

1.	GENERALLY - ALL GARDEN SOIL - ADD GYPSUM AT 1KG/M2 TO ALL GARDEN SOIL AND 30% MILL MUD IF NOT ALREADY INCLUDED IN MIX..
2.	BACKFILL FOR PLANTING HOLES - THOROUGHLY MIX THE SOIL THAT IS TO FILL THE PLANT HOLE WITH TERRACOTTEM (R) GENERAL SOIL CONDITIONER AT THE RECOMMENDED RATES: PLANT HOLE SIZE(mm) TERRACOTTEM(R)/PLANT
	200X200X300 20g
	300X300X300 40g
	700X700X700 100g
	1000X1000X1000 1.5kg OR 1.5kg PER CUBIC METRE GROWING MEDIA OR SOIL TAKEN FROM PLANT HOLE

- PLACING TOPSOIL
- FOR GROUP PLANTED GARDEN BEDS PLACE TOPSOIL AS SHOWN TO SUIT THE SIZES AND TYPE OF PLANTS SHOWN ON THE PROJECT DRAWINGS.

- PLANT SUPPLY
- PLANTS SHOULD BE ORDERED WELL IN ADVANCE OF THE PROJECTED PLANTING DATE TO ALLOW TIME FOR THEM TO BE AN OPTIMUM SIZE. DO NOT SUBSTITUTE WITHOUT REFERENCE TO THE SUPERINTENDENT WHO SHOULD CONSULT THE OWNER. IF A SPECIMEN PLANT IS AVAILABLE IN A LARGER SIZE THAN SPECIFIED ON THE PLAN, BRING THIS TO THE ATTENTION OF THE SUPERINTENDENT WHO MAY WISH TO ORGANISE USING THE LARGER AVAILABLE SPECIMEN IF IT IS SUITABLE AS A VARIATION TO THE CONTRACT.
 - ALL TREES AND SHRUBS ARE TO BE TRUE TO NAME, WELL-GROWN AND WELL ESTABLISHED IN THEIR ROOT AND BRANCH FORMATION. AND CONFORM TO NATSPEC'S "SPECIFYING TREES - A GUIDE TO THE ASSESSMENT OF TREE QUALITY" SECOND EDITION 2003 BY ROSS CLARK.
 - STOCK MUST BE FROM SEED FROM AN APPROPRIATE SOURCE
 - ALL PLANTS SHALL BE DELIVERED TO SITE IN A COVERED VEHICLE AND WATERED IMMEDIATELY FOLLOWING DELIVERY. DO NOT ALLOW PLANTS TO DRY OUT OR OVER-HEAT AT ANY TIME.
 - ALL PLANTING MUST BE CARRIED OUT IMMEDIATELY FOLLOWING DELIVERY, REMOVING CONTAINERS, UNLESS FULLY DEGRADABLE, AT THE LATEST POINT BEFORE PLANTING.
 - ALL PLANTS MUST BE FULLY SUN-HARDENED, TRUE TO NAME, WELL-FORMED AND FREE FROM DISEASE.

- PLANTING - GENERALLY
- GENERALLY ALL PLANTS SHOULD BE PLANTED IN ACCORDANCE WITH THE PLAN, HOWEVER WHERE POSITIONS OF SERVICES HAVE BEEN VARIED FROM THOSE SHOWN ON THE PLAN OR CONTOURS AND EARTHWORKS MEAN THAT IT WOULD BE IMPRACTICAL TO LOCATE PLANTS IN THE POSITIONS INDICATED, DISCUSS ALTERNATIVE PLANTING LOCATIONS/OMISSION OF SPECIES WITH SITE SUPERVISOR.
 - ALL APPROPRIATE WATER PERMITS MUST BE OBTAINED PRIOR TO COMMENCING PLANTING
 - LARGE SHRUBS AND TREES - EXCAVATE THE PLANTING HOLE TO ALLOW A MINIMUM OF 150MM CLEARANCE AROUND THE ROOT BALL. RIP THE BASE OF THE HOLE TO 150MM DEPTH BELOW THIS TO PROMOTE GOOD DRAINAGE.
 - GROUP PLANTING OF SHRUB AND GROUNDcover AREAS - SPREAD PREMIUM GRADE TOPSOIL THAT CONFORMS TO AS4419(1998) SOIL FOR LANDSCAPING AND GARDEN USE TO A DEPTH OF 300MM OR AS OTHERWISE SHOWN ON DETAIL OF GROUP PLANTED AREAS
 - RECOMMENDED FERTILISER IS AGRIFORM PELLETS APPLIED AT A RATE OF 20F 21G TABLETS PER PLANTING HOLE. FERTILISER IS TO BE PLACED IN THE BOTTOM OF THE HOLE AND COVERED WITH SOME SOIL PRIOR TO PLANTING TO PREVENT THE FERTILISER COMING INTO DIRECT CONTACT WITH THE ROOTS.
 - PLACE WATER CRYSTALS AT A RATE OF 250MM EXPANDED CRYSTALS PER PLANTING HOLE.
 - IMMERSE THE PLANT CONTAINER IN WATER PRIOR TO REMOVING THE PLANT FROM THE POT AND WATER THE PLANT HOLE TO PREVENT THE ROOTS COMING INTO CONTACT WITH DRY SOIL. DO NOT DAMAGE THE ROOTS WHEN REMOVING THE PLANT FROM ITS CONTAINER AND GENTLY PLACING IN THE HOLE.
 - PLANTING SHOULD BE CARRIED OUT IN SUCH A WAY THAT THE TOP OF THE SOIL IN THE PLANT CONTAINER FROM THE NURSERY IS AT GROUND LEVEL WHEN PLANTED AND NEITHER TOO DEEP OR TOO SHALLOW.
 - BACKFILL THE HOLE GENTLY FIRING SUCCESSIVE LAYERS WITHOUT COMPACTING THE SOIL BUT ENSURE THAT THE PLANT IS HELD SECURELY BY THE SOIL.
 - FORM A SMALL INDENTED AREA AROUND THE STEM TO CAPTURE WATER.
 - WATER WITH A MINIMUM 10 LITRES IMMEDIATELY FOLLOWING PLANTING AND PRIOR TO MULCHING

- MULCHING
 - ENSURE THAT MULCH IS REASONABLY FIRE-RETARDENT
 - MULCH SHOULD BE FOREST BARK OR SIMILAR (NO FINES) INSTALLED TO A MINIMUM DEPTH OF 75M AROUND TREES AND 100MM DEEP IN SHRUB BEDS. IT SHOULD BE KEPT CLEAR OF THE PLANT STEM.
 - USE PARTICLE MASKS WHEN SPREADING MULCH TO AVOID BREATHING IN MOULD SPORES.
- GARDEN EDGING
- A SPADE-EDGE IS SUFFICIENT FOR THIS PROJECT.
- TURFING
- WHERE GRASS IS DAMAGED DURING CONSTRUCTION REPAIR AND MAKE GOOD USING TURF TO MATCH EXISTING SPECIES MIX. EXTENT OF TURFED AREA TO BE DETERMINED ON SITE.
 - TURF SHOULD BE FREE FROM ANY TOXIC MATERIAL, NOXIOUS WEEDS, SEEDS OR ROOTS INCLUDING NUT GRASS AND OXALIS. THE SOIL TO THE TURF SHALL BE FREE FROM RUBBISH, STICKS OR OTHER DELETERIOUS MATERIAL, CUT WITH A FULL 25MM REMAINING BELOW THE THATCH OF THE TURF.
 - THE MOISTURE LEVEL IN THE TURF SHOULD BE KEPT RELATIVELY CONSISTENT SO THAT IT IS NOT SATURATED OR SEVERELY DRIED OUT WHEN LAYING.
- GROUND PREPARATION
- CULTIVATE THE AREA TO A DEPTH OF 150MM BELOW FINISHED SURFACE LEVELS AND GRADE TO EVEN-RUNNING CONTOURS.
 - CULTIVATE THE SOIL TO A FINE TILTH, FREE OF CLODS, ROCKS, STICKS AND THE LIKE. ANY STOCK-PILED TOPSOIL SHOULD BE SPREAD TO A MINIMUM DEPTH OF 25MM AND PREPARED AS ABOVE.
 - ANY CONTAMINATED SOIL SHOULD BE EXCAVATED AND REMOVED FROM SITE.
 - BEFORE LAYING TURF A SLOW RELEASE FERTILISER SHALL BE PLACED ON TOP OF THE PREPARED TOPSOIL RATE OF 35G/M2. THIS SHOULD BE AN APPROVED LAWN FERTILISER WITH AN N:P:K RATION OF 12:12:8 AND RAKED INTO THE TOPSOIL.

- LAYING
- SECTIONS TO BE TURFED SHALL BE WATERED WITHIN TWENTY FOUR HOURS PRIOR TO TURFING AT AN APPROXIMATE RATE OF 10MM OF WATER IN NOT LESS THAN ONE HOUR.
 - WATERING IS TO BE CARRIED OUT IN SUCH A WAY AS NOT TO CAUSE ANY SCOURING OR EROSION.
 - FILL ALL JOINTS IN TURF WITH TOPSOIL DRESSING, ROLL AND WATER.
- WATERING/IRRIGATION
- ALLOW FOR IRRIGATION SYSTEM TO ALL NEW LANDSCAPED AREAS.
 - PROVIDE DETAILS OF IRRIGATION SYSTEM PRIOR TO INSTALLATION FOR APPROVAL BY COUNCIL.
 - WATERING IS THE APPLICATION OF 10MM OF WATER TO THE TOTAL AREA IN NOT LESS THAN ONE HOUR AND SHALL INCLUDE ANY NATURAL RAINFALL.
 - ALL PLANTS MUST BE THOROUGHLY WATERED IMMEDIATELY ON ARRIVAL AT SITE AND AGAIN PRIOR TO PLANTING.
 - WATER DURING AND IMMEDIATELY AFTER PLANTING.
 - AFTER ESTABLISHMENT OF TREES WATERING MAY BE DONE BY HAND IN PERIODS OF DRY WEATHER ONLY.
 - THE FREQUENCY OF WATERING SHALL COMPLY WITH THE FOLLOWING MINIMUM REQUIREMENTS.
- | PERIODS AFTER GRASSING/PLANTING | WATERING |
|--|---|
| IMMEDIATELY | ONCE |
| WEEK 1 | TWICE/DAY DURING HOT DRY WINDY PERIODS
ONCE/DAY DURING COOL/OVERCAST PERIODS |
| WEEK 2 | ONCE/DAY |
| WEEKS 3 & 4 | ONCE EVERY SECOND DAY |
| WEEKS 5 UNTIL NECESSARY | TWICE/WEEK |
| OR AS NECESSARY TO ENSURE A MINIMUM STRIKE RATE. | |

- MAINTENANCE
- A MAINTENANCE PERIOD OF 13 WEEKS IS REQUIRED FOLLOWING A PRACTICAL COMPLETION INSPECTION AND WILL COMMENCE FOLLOWING AN 'ON MAINTENANCE' INSPECTION OF THE 'AS CONSTRUCTED' LANDSCAPING WORKS.
 - THE MAINTENANCE PERIOD SHOULD, HOWEVER, BE IMPLEMENTED IMMEDIATELY FOLLOWING PLANTING AND IF STARTED MORE THAN 13 WEEKS FOR THE DATE OF WORKS ACCEPTANCE THEN THE DEVELOPER WILL NEED TO CONTINUE MAINTENANCE UNTIL HANDOVER OF THE WORKS TO COUNCIL.
 - DURING THE MAINTENANCE PERIOD, THE CONTRACTOR IS TO ENSURE ALL WORK IS DONE TO ENSURE PLANTS AND GRASS ARE HEALTHY AND GROWING WEL.L
 - REMOVE AND REPLACE AS NECESSARY ANY DEAD, DISEASED OR UNHEALTHY GROWTH SO THAT ALL VEGETATION IS THRIVING BY THE TIME THAT COUNCIL ACCEPTS RESPONSIBILITY FOR THE LANDSCAPE WORKS.
 - ALL WEEDS SHOULD BE ERADICATED MANUALLY OR WITH THE USE OF AN APPROVED HERBICIDE APPLIED IN ACCORDANCE WITH THE MANUFACTURER'S SPECIFICATIONS. SPRAYING WILL ONLY TAKE PLACE AT A TIME WHEN THERE WILL BE NO DAMAGE CAUSED TO THE ENVIRONMENT BY APPLYING THE CHEMICAL EG NOT IN WINDY CONDITIONS OR WHEN RAIN APPEARS IMMINENT.
 - MOW, MULCH, PRUNE, FERTILISE AND WATER AS REQUIRED.
 - AT THE END OF THE HANDOVER PERIOD, COUNCIL SHOULD ISSUE AN 'OFF-MAINTENANCE CERTIFICATE'.
 - MAINTENANCE VISITS SHOULD BE AT APPROXIMATELY 1 WEEKLY INTERVALS.

MAREEBA ROADHOUSE AND ACCOMODATION PARK

WILLIAMS ROAD, MAREEBA

SPECIFICATION

SCALE: N/A

JOB No: 181005

DWG No: L08 ISSUE No: 2

DATE: 10 May 2018

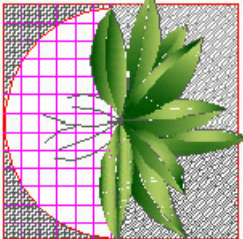

Suzan Quigg Landscape Design
PO Box 638 Malanda QLD 4885 Australia
P: 07 4095 1017 M: 0407 035 381
E: suzanjq@bigpond.com
W: www.suzanquigg.com

© Suzan J Quigg Landscape Design 2018

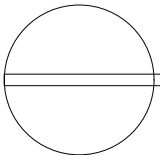

SPECIFICATION