

8.2.4 Environmental significance overlay code

8.2.4.1 Application

- (1) This code applies to assessing development where:
 - (a) land the subject of development is affected by a constraint category identified on the **Environmental significance overlay maps (OM-004a-z)**; and
 - (b) it is identified in the assessment benchmarks for assessable development and requirements for accepted development column of an assessment table in Part 5 of the planning scheme.

Note—Biodiversity and Water quality are appropriately reflected in Overlay Map 4 and is required to be mapped by State Government in response to Environment and Heritage State Interests.

8.2.4.2 Purpose

- (1) The purpose of the Environmental significance overlay code is to identify and protect matters of environmental significance, which include matters of state environmental significance (MSES) as defined under the state planning policy.

The Environmental significance overlay code ensures that:

- (a) waterways and high ecological significance wetlands are protected and enhanced to maintain ecosystem services and hydrological processes and provide aquatic habitat for flora and fauna; and
 - (b) the environmental values of regulated vegetation, wildlife habitat, protected areas and legally secured offset areas are protected and managed.
- (2) The purpose of the code will be achieved through the following overall outcomes:
 - (a) the biodiversity values, ecosystem services and climate change resilience of areas of environmental significance are protected, managed, enhanced and rehabilitated;
 - (b) the biodiversity values of protected areas and legally secured offset areas are protected from development unless overriding community need is demonstrated;
 - (c) development is located, designed and managed to minimise the edge effects of development on areas of regulated vegetation and wildlife habitat;
 - (d) areas of regulated vegetation and wildlife habitat are managed to minimise biodiversity losses;
 - (e) development maintains, protects and enhances a regional network of vegetated corridors that assist in wildlife movement and contribute to the maintenance of habitat and biological diversity;
 - (f) development is appropriately setback from waterways and high ecological significance wetlands to minimise direct and indirect impacts on water quality and biodiversity; and
 - (g) riparian vegetation and vegetation associated with high ecological significance wetlands is protected and enhanced to improve water quality and natural ecosystem function.

8.2.4.3 Criteria for assessment

Table 8.2.4.3A - Environmental significance overlay code - For accepted development subject to requirements and assessable development

Performance outcomes	Acceptable outcomes	Complies	Comments
For accepted development subject to requirements and assessable development			
Regulated vegetation			
<p>PO1 Vegetation clearing in areas mapped as 'Regulated vegetation' identified on the Environmental Significance Overlay Maps (OM-004a-o) is avoided unless:</p> <p>(a) it is demonstrated that the area does not support regulated vegetation as mapped;</p> <p>(b) the loss or reduction in regulated vegetation is for community infrastructure and associated access facilities that cannot be avoided;</p> <p>(c) wildlife interconnectivity is maintained or enhanced at a local and regional scale; and</p> <p>(d) the loss or reduction in regulated vegetation is minimised and any residual impacts are offset.</p> <p>Note—A supporting Ecological Assessment Report is prepared in accordance with Planning Scheme Policy 2 – Ecological Assessment Reports.</p>	<p>AO1.1 No clearing of native vegetation is undertaken within areas of 'Regulated vegetation' identified on the Environmental Significance Overlay Maps (OM-004a-o).</p>	✓	<p>No clearing is proposed.</p>
<p>PO2 Development on sites adjacent to areas of 'Regulated vegetation' identified on the Environmental Significance Overlay Maps (OM-004a-o) protects the environmental significance of regulated vegetation and:</p> <p>(a) does not interrupt, interfere, alter or otherwise impact on underlying natural</p>	<p>AO2 Development (excluding roads, earthworks, drainage infrastructure and underground infrastructure) is not located within 20 metres of 'Regulated vegetation' areas identified on the Environmental Significance Overlay Maps (OM-004a-o).</p>	✓	<p>Complies</p>

Performance outcomes	Acceptable outcomes	Complies	Comments
<p>ecosystem processes such as water quality, hydrology, geomorphology and biophysical processes;</p> <p>(b) does not negatively impact the movement of wildlife at a local or regional scale; and</p> <p>(c) avoids noise, light, vibration or other edge affects, including weed and pest incursion on identified environmental values.</p> <p>Note—A supporting Ecological Assessment Report is prepared in accordance with Planning Scheme Policy 2 – Ecological Assessment Reports.</p>			
Regulated vegetation intersecting a watercourse			
<p>PO3 Vegetation clearing in areas mapped as 'Regulated vegetation intersecting a watercourse', identified as 'Waterway' and 'Waterway buffer' on the Environmental Significance - Waterway Overlay Maps (OM-004p-z) is avoided unless wildlife interconnectivity between habitats is maintained or enhanced at a local and regional scale, to the extent that migration or normal movement of significant species between habitats or normal gene flow between populations is not inhibited.</p> <p>Note—A supporting Ecological Assessment Report is prepared in accordance with Planning Scheme Policy 2 – Ecological Assessment Reports.</p>	<p>Where within a 'Waterway buffer' on Environmental Significance - Waterway Overlay Maps (OM-004p-z)</p> <p>AO3.1 A minimum setback in accordance with Table 8.2.4.3B is provided between development and the top of the high bank of a 'Waterway' identified on the Environmental Significance - Waterway Overlay Maps (OM-004p-z).</p>	✓	Complies
	<p>Where within a 'Waterway buffer' on Environmental Significance - Waterway Overlay Maps (OM-004p-z)</p> <p>AO3.2 No clearing of native vegetation is undertaken within the minimum setback identified at AO3.1.</p>	✓	Complies
Waterways and wetlands			

Performance outcomes	Acceptable outcomes	Complies	Comments
<p>PO4 'High ecological significance wetlands' identified on the Environmental Significance Overlay Maps (OM-004a-o) and 'Waterways' on Environmental Significance - Waterway Overlay Maps (OM-004p-z) and are protected by:</p> <p>(a) maintaining adequate separation distances between waterways/wetlands and development;</p> <p>(b) maintaining and enhancing aquatic and terrestrial habitat including vegetated corridors to allow for native fauna (terrestrial and aquatic) movement;</p> <p>(c) maintaining waterway bank stability by minimising bank erosion and slumping;</p> <p>(d) maintaining water quality by providing buffers to allow filtering of sediments, nutrients and other pollutants; and</p> <p>(e) retaining and improving existing riparian vegetation and existing vegetation associated with a wetland.</p> <p>Note—A supporting Ecological Assessment Report is prepared in accordance with Planning Scheme Policy 2 – Ecological Assessment Reports.</p>	<p>Where within a 'Waterway buffer' on Environmental Significance - Waterway Overlay Maps (OM-004p-z)</p> <p>AO4.1 A minimum setback in accordance with Table 8.2.4.3B is provided between development and the top of the high bank of a 'Waterway' identified on the Environmental Significance - Waterway Overlay Maps (OM-004p-z).</p>	NA	Not applicable
	<p>Where within a 'High ecological significance wetland buffer' on Environmental Significance Overlay Maps (OM-004a-o)</p> <p>AO4.2 A minimum buffer of 200 metres is provided between development and the edge of a 'High ecological significance wetland' identified on the Environmental Significance Overlay Maps (OM-004a-o).</p>	NA	Not applicable
	<p>Where within a 'Waterway buffer' on Environmental Significance - Waterway Overlay Maps (OM-004p-z) or 'High ecological significance wetland buffer' on Environmental Significance Overlay Maps (OM-004a-o)</p> <p>AO4.3 No stormwater is discharged to a 'Waterway' on Environmental Significance - Waterway Overlay Maps (OM-004p-z) or 'High ecological significance wetland' identified on the Environmental Significance Overlay Maps (OM-004a-o).</p>	NA	Not applicable

Performance outcomes	Acceptable outcomes	Complies	Comments
	<p>Note— An alternative outcome is required to demonstrate that the ecological impacts of stormwater discharge to a 'Waterway' or 'High ecological significance wetland' are mitigated in accordance with PO3 through appropriate stormwater management / treatment (where possible).</p> <p>Where within a 'Waterway buffer' on Environmental Significance - Waterway Overlay Maps (OM-004p-z) or 'High ecological significance wetland buffer' on Environmental Significance Overlay Maps (OM-004a-o) AO4.4</p> <p>No wastewater is discharged to a 'Waterway' on Environmental Significance - Waterway Overlay Maps (OM-004p-z) or 'High ecological significance wetland' identified on the Environmental Significance Overlay Map (OM-004a-z).</p> <p>Note— A alternative outcome is required to demonstrate that the ecological impacts of wastewater discharge to a 'Waterway' or 'High ecological significance wetland' are mitigated in accordance with PO3 through appropriate wastewater management / treatment (where possible).</p>	NA	Not applicable
For assessable development			
Wildlife Habitat			
<p>PO5 Development within a 'Wildlife habitat' area identified on the Environmental Significance Overlay Maps (OM-004a-o):</p> <p>(a) protects and enhances the habitat of Endangered, Vulnerable and Near Threatened (EVNT) species and local species of significance;</p> <p>(b) incorporates siting and design measures to</p>	<p>AO5 No acceptable outcome is provided</p>	NA	Not applicable

Performance outcomes	Acceptable outcomes	Complies	Comments
<p>protect and retain identified ecological values and underlying ecosystem processes within or adjacent to the development site;</p> <p>(c) maintains or enhances wildlife interconnectivity at a local and regional scale; and</p> <p>(d) mitigates the impact of other forms of potential disturbance (such as presence of vehicles, pedestrian use, increased exposure to domestic animals, noise and lighting impacts) to protect critical life stage ecological processes (such as feeding, breeding or roosting).</p> <p>Note—Development applications must identify any EVNT species or their habitats that may be affected by the proposal. In particular, applications are to identify and describe how the development avoids adverse impacts on ecological processes within or adjacent to the development area.</p> <p>Note—A supporting Ecological Assessment Report is prepared in accordance with Planning Scheme Policy 2 – Ecological Assessment Reports.</p>			
Legally secured offset areas			
<p>PO6 Development within a 'Legally secured offset area' identified on the Environmental Significance Overlay Maps (OM-004a-o) or other known Legally Secured Offset Area is consistent with the binding requirements of the offset and does not prejudice, undermine, or negatively impact the inherent ecological values, including all naturally occurring native flora, fauna and their habitat</p>	<p>AO6 No acceptable outcome is provided.</p>	<p>NA</p>	<p>Not applicable</p>

Performance outcomes	Acceptable outcomes	Complies	Comments
<p>within the Legally Secured Offset Area.</p> <p>Note—A supporting Ecological Assessment Report is prepared in accordance with Planning Scheme Policy 2 – Ecological Assessment Reports.</p>			
Protected areas			
<p>PO7 Development within a 'Protected area' identified on the Environmental Significance Overlay Maps (OM-004a-o) is consistent with the values of the Protected Area and:</p> <ul style="list-style-type: none"> (a) supports the inherent ecological and community values of the Protected Area asset; (b) maintains or enhances wildlife interconnectivity at a local and regional scale; and (c) does not prejudice, undermine, or negatively impact the inherent ecological values, including all naturally occurring native flora, fauna and their habitat within the Protected Area. <p>Note—A supporting Ecological Assessment Report is prepared in accordance with Planning Scheme Policy 2 – Ecological Assessment Reports.</p>	<p>AO7 No acceptable outcome is provided</p>	<p>NA</p>	<p>Not applicable</p>

Performance outcomes	Acceptable outcomes	Complies	Comments
Ecological corridors and Habitat linkages			
<p>PO8 Development located: (a) in the Conservation zone, Emerging community zone, Recreation and open space zone, Rural zone or Rural residential zone; and (b) within an 'Ecological corridor' or a 'Habitat linkage' identified on the Environmental Significance Overlay Maps (OM-004a-o)</p> <p>does not compromise the provision of habitat connectivity of the corridor/linkage, having regard to:</p> <p>(a) the environmental values of the area of the site identified in the 'Ecological corridor' or 'Habitat linkage'; (b) the environmental values of adjoining and nearby land within the 'Ecological corridor' or 'Habitat linkage'; (c) the extent of any modification proposed to the natural environment including (but not limited to) vegetation and topography; (d) the location and design of proposed improvements that may impact on the functions of the 'Ecological corridor' or 'Habitat linkage' including (but not limited to) buildings, structures, fences, lighting, vehicle movement areas and infrastructure services; and (e) the ability for the 'Ecological corridor' or</p>	<p>AO8 No acceptable outcome is provided</p>	<p>NA</p>	<p>Not applicable</p>

Performance outcomes	Acceptable outcomes	Complies	Comments
<p>'Habitat linkage' to be enhanced to improve ecological connectivity.</p> <p>Note—A supporting Ecological Assessment Report prepared in accordance with Planning Scheme Policy 2 – Ecological Assessment Reports may be appropriate to demonstrate compliance with PO8.</p>			

Table 8.2.4.3B - Setback and buffer distances from waterways

Stream order	Setback and buffer from waterways
1	10 metres from top of high bank
2-4	25 metres from top of high bank
5 or more	50 metres from top of high bank

Note—The stream order of a 'waterway' is to be determined on a case by case basis.

8.2.6 Flood hazard overlay code

8.2.6.1 Application

- (1) This code applies to assessing development where:
 - (a) land the subject of development is located within a Flood hazard area identified on the **Flood hazard overlay maps (OM-006a-o)**; and
 - (b) it is identified in the assessment benchmarks for assessable development and requirements for accepted development column of an assessment table in Part 5 of the planning scheme.

Note—Natural hazards are appropriately reflected in Overlay Maps 3, 6 and 8 and are required to be mapped by State Government in response to Hazard and Safety State Interests.

Note—where new information, including flood studies or flood modelling supersedes the Flood hazard overlay maps (OM-006a-o) Council may have regard to this new information in the application of the Flood hazard overlay code in the interests of the precautionary principle and the safety of persons and property.

8.2.6.2 Purpose

- (1) The purpose of the Flood hazard overlay code is to manage development outcomes in flood hazard areas identified on the **Flood hazard overlay maps (OM-006a-o)** so that risk to life, property, community and the environment during flood events is minimised, and to ensure that development does not increase the potential for flood damage on site or to other property.
- (2) The purpose of the code will be achieved through the following overall outcomes:
 - (a) Development in the 'Extreme flood hazard area':
 - i. maintains and enhances the hydrological function of the land;
 - ii. does not involve filling (earthworks) or changes to existing landform or drainage lines that results in a loss of the flood conveyance and flood storage capacity of the land;
 - iii. is limited to:
 - A. flood proofed Sport and recreation activities;
 - B. Rural activities where for Animal husbandry, Cropping or Permanent plantation;
 - C. flood proofed Utility installations, Substations or Major electricity infrastructure;
 - D. conservation and natural area management; and
 - E. replacement of existing lawful development, including Accommodation activities where habitable rooms are elevated above the defined flood level and include freeboard;

Where there is no increase to the number of persons at risk of flood and where development reduces existing or potential risks to life and property.
 - (b) Development in the 'High flood hazard area':
 - i. maintains the hydrological function of the land;
 - ii. does not involve filling (earthworks) or changes to the existing landform or drainage lines that results in a loss of the flood conveyance and flood storage capacity of the land;
 - iii. is limited to:
 - A. flood proofed Sport and recreation activities and Club uses;
 - B. Non-resident workforce accommodation, Relocatable home park, Resort complex, Rooming accommodation, Short term accommodation and

Tourist park uses where these uses comprise permanent on-site management and a flood evacuation management plan ensures the health and safety of persons during a flood event;

- C. a Dwelling house only where the lot existed or had a lawful reconfiguring a lot approval at the commencement of the planning scheme and the land is included in a Residential zone or the Centre zone or where for minor intensification of existing Dwelling houses;
- D. Rural activities where for Animal husbandry, Cropping or Permanent plantation;
- E. Industrial activities and Commercial activities where it is accepted development that flood damage is incurred as an operational cost and where flood sensitive elements of the development or use are elevated above the defined flood level, including freeboard;
- F. flood proofed Utility installations, Substations or Major electricity infrastructure;
- G. conservation and natural area management; and
- H. replacement of existing lawful development;

where there is no increase to the number of persons at risk of flood and where development reduces existing or potential risks to life and property.

- iv. protects surrounding land and land uses from increased flood hazard impacts;
- v. elevates habitable rooms for all accommodation activities (including where for minor building work) above the defined flood level, including freeboard.

(c) Development in the 'Significant flood hazard area':

- i. minimises risk to life and property from flood events;
- ii. involves changes to the existing landform and drainage lines in this area only where detrimental impacts to the flood hazard risk of surrounding areas is avoided;
- iii. is limited to:
 - A. Sport and recreation activities;
 - B. Industrial activities and Commercial activities where it is accepted development that flood damage is incurred as an operational cost and where flood sensitive elements of the development or use are elevated above the defined flood level, including freeboard;
 - C. Rural activities;
 - D. Accommodation activities, excluding Residential care facility and Retirement facility;
 - E. flood proofed Community activities, excluding Child care centre, Hospital and Community use where a flood emergency evacuation plan ensures the safety of people during a flood event;
 - F. flood proofed Utility installations, Substations or Major electricity infrastructure;
 - G. conservation and natural area management;
- iv. locates habitable rooms for all accommodation activities above the defined flood level, including freeboard; and
- v. locates the minimum floor level for all buildings other than accommodation activities, industrial activities and business activities above the defined flood level.

- (d) Development in the 'Low flood hazard area':
 - i. minimises risk to life and property from flood events;
 - ii. locates habitable rooms for all Accommodation activities above the defined flood level, including freeboard; and
 - iii. locates the minimum floor level for all buildings other than Accommodation activities above the defined flood level, including freeboard.

- (e) Development in the 'Potential flood hazard area':
 - i. maintains the safety of people on the development site from flood events and minimises the potential damage from flooding to property;
 - ii. does not result in adverse impacts on people's safety, the environment or the capacity to use land within the floodplain;
 - iii. locates habitable rooms for all Accommodation activities above a 1% Annual Exceedance Probability (AEP), including freeboard; and
 - iv. locates the minimum floor level for all building work other than Accommodation activities above the 1% AEP flood level, including freeboard.

8.2.6.3 Criteria for assessment

Table 8.2.6.3A - Flood hazard overlay code - For accepted development subject to requirements and assessable development

Performance outcomes	Acceptable outcomes	Complies	Comments
For accepted development subject to requirements and assessable development			
All flood hazard areas			
PO1 Development prevents the carriage or dispersal of contaminants or pollutants into the receiving environment.	AO1 The processing or storage of dangerous goods or hazardous materials is: (a) not undertaken in a flood hazard area identified on the Flood hazard overlay maps (OM-006a-o) ; or (b) is located above the defined flood level plus 0.3 metre freeboard.	✓	Complies
PO2 Essential community infrastructure is able to function effectively during and immediately after flood events.	AO2 Design levels for buildings must comply with the flood immunity standards specified in Table 8.2.6.3.B and Table 8.2.6.3.C where within a flood hazard area identified on the Flood hazard overlay maps (OM-006a-o) .	✓	Complies
Extreme flood hazard area			

Performance outcomes	Acceptable outcomes	Complies	Comments
<p>PO3 Development, where involving a Material change of use within an 'Extreme flood hazard area' on the Flood hazard overlay maps (OM006a-o), is appropriate to the flood hazard risk having regard to the:</p> <p>(a) likelihood and frequency of flooding;</p> <p>(b) flood risk acceptability of development;</p> <p>(c) vulnerability of and safety risk to persons associated with the use;</p> <p>(d) associated consequences of flooding in regard to impacts on proposed buildings, structures, and supporting infrastructure; and</p> <p>(e) associated consequences of flooding in respect to undue burden on disaster response recovery capacity and capabilities.</p>	<p>AO3.1 Uses within the following activity groups are not located within an 'Extreme flood hazard area identified' on the Flood hazard overlay maps (OM006a-o):</p> <p>(a) Accommodation activities;</p> <p>(b) Commercial activities;</p> <p>(c) Community activities except where for a Club with a maximum gross floor area of 100m²;</p> <p>(d) Industrial activities;</p> <p>(e) Rural activities, except where for Animal husbandry, Cropping, or Permanent plantation.</p>	NA	Not applicable
	<p>AO3.2 Sport and recreation activities are not located within an 'Extreme flood hazard area' identified on the Flood hazard overlay maps (OM006a-o) except where for:</p> <p>(a) Environment facility;</p> <p>(b) Park; or</p> <p>(c) Outdoor sport and recreation (excluding the provision of ancillary facilities or amenities conducted within a building).</p>	NA	Not applicable

Performance outcomes	Acceptable outcomes	Complies	Comments
<p>PO4 Development is located and designed to:</p> <p>(a) maintain and enhance the flood conveyance capacity of the premises;</p> <p>(b) not increase the number of people calculated to be at risk from flooding;</p> <p>(c) not increase the flood impact on adjoining premises;</p> <p>(d) ensure the safety of all persons by ensuring that development levels are set above the defined flood level;</p> <p>(e) reduce property damage; and</p> <p>(f) provide flood immune access to buildings.</p> <p>Note—Buildings may be constructed from flood resistant, waterproof materials below the defined flood level where certified by a qualified structural engineer to be flood proof (including the ability to withstand damage from floodwater and debris) and where an alternative outcome to AO4.1-AO4.4 is also demonstrated.</p> <p>Note—In the event that a lawful building or structure is destroyed by flood or other event the building may be replaced in situ where there is no increase in:</p> <ol style="list-style-type: none"> i. gross floor area; or ii. the number of dwellings or bedrooms on the premises. 	<p>AO4.1 Buildings, including extensions to existing buildings, are:</p> <p>(a) not located within an 'Extreme flood hazard area' identified on the Flood hazard overlay maps (OM006a-o); or</p> <p>(b) elevated above the defined flood level, with 0.3 metres freeboard from the defined flood level provided for habitable rooms within a dwelling.</p>	NA	Not applicable
	<p>AO4.2 All building work must be high set and retains the flood storage and conveyance capacity of the premises.</p> <p>Note—Building work must be certified by a qualified structural engineer to be flood proof including the ability to withstand damage from floodwater and debris.</p>	NA	Not applicable
	<p>AO4.3 New buildings are provided with flood free pedestrian and vehicle evacuation access between the building and a flood safe accessible road.</p> <p>Note—A flood safe accessible road includes a road where identified as outside a flood hazard area or within a 'Low flood hazard area', 'Potential flood hazard area' or 'Significant flood hazard area' on the Flood hazard overlay maps (OM006a-o).</p>	NA	Not applicable
	<p>AO4.4 Development does not increase the number of lots in the 'Extreme flood hazard area' identified on the Flood hazard overlay maps (OM006a-o) except where for the purposes of public open space.</p>	NA	Not applicable

Performance outcomes	Acceptable outcomes	Complies	Comments
<p>PO5 Development involving earthworks in a Flood hazard area below the defined flood level must protect life and property on premises and off premises through maintaining:</p> <ul style="list-style-type: none"> (a) flood storage capacity of land; (b) flood conveyance function of land; (c) flood and drainage channels; (d) overland flow paths; and (e) flood warning times. 	<p>AO5 Filling above ground level is not undertaken in the 'Extreme flood hazard area' identified on the Flood hazard overlay maps (OM006a-o).</p>	NA	Not applicable
High flood hazard area			
<p>PO6 Development, where for a Material change of use within a 'High flood hazard area' identified on the Flood hazard overlay maps (OM-006a-o), is appropriate to the flood hazard risk having regard to the:</p> <ul style="list-style-type: none"> (a) likelihood and frequency of flooding; (b) flood risk acceptability of development; (c) vulnerability of and safety risk to persons associated with the use; (d) associated consequences of flooding in regard to impacts on proposed buildings, structures and supporting infrastructure; and 	<p>AO6.1 Uses within the following activity groups are not located within a 'High flood hazard area' identified on the Flood hazard overlay maps (OM006a-o):</p> <ul style="list-style-type: none"> (a) Accommodation activities, except where for Dwelling house and only where the lot existed or had a lawful reconfiguring a lot approval at the commencement of the planning scheme and the land is included in a Residential zone or the Centre zone; (b) Community activities except where for a Club with a maximum gross floor area of 100m²; (c) Rural activities, except where for Animal husbandry, Cropping or Permanent plantation. 	NA	Not applicable

Performance outcomes	Acceptable outcomes	Complies	Comments
(e) associated consequences of flooding in respect to undue burden on disaster response recovery capacity and capabilities.	AO6.2 Sport and recreation activities are not located within a 'High flood hazard area' identified on the Flood hazard overlay maps (OM006a-o) except where for: (a) Environment facility; (b) Park; or (c) Outdoor sport and recreation (excluding the provision of ancillary facilities or amenities conducted within a building).	NA	Not applicable
PO7 Development is located and designed to: (a) maintain hydrological function of the premises; (b) not increase the number of people calculated to be at risk from flooding; (c) minimises the flood impact on adjoining premises; (d) ensure the safety of all persons by ensuring that an appropriate	AO7.1 Buildings, including extensions to existing buildings are: (a) not located within the 'High flood hazard area' identified on the Flood hazard overlay maps (OM006a-o) ; or (b) elevated above the defined flood level, with 0.3 metres freeboard from the defined flood level provided for habitable rooms within a dwelling. OR	NA	Not applicable

Performance outcomes	Acceptable outcomes	Complies	Comments
<p>proportion of buildings are set above the defined flood level;</p> <p>(e) reduce the carriage of debris in flood waters;</p> <p>(f) reduce property damage; and</p> <p>(g) provide flood immune access to buildings.</p> <p>Note—Buildings may be constructed from flood resistant, waterproof materials below the defined flood level where certified by a qualified structural engineer to be flood proof (including the ability to withstand damage from floodwater and debris) and where an alternative outcome to AO8.1-AO8.9 is also demonstrated.</p>	<p>AO7.2 Buildings used for Commercial activities or Industrial activities include a minimum floor level of 0.3 metres above the defined flood where for the following components of the use:</p> <p>(a) administrative areas; or</p> <p>(b) services, plant and equipment associated with the building.</p> <p>Note—AO8.2 accepts that the cost of flood impact is an operational cost of the Commercial activity or Industrial activity.</p> <p>Note—Building work must be certified by a qualified structural engineer to be flood proof including the ability to withstand damage from floodwater and debris.</p>	NA	Not applicable
	<p>AO7.3 All building work below the defined flood level must be high set (comprising pier and beam construction) and retains the flood storage and conveyance capacity of the premises.</p>	NA	Not applicable
	<p>AO7.4 New buildings are provided with flood free pedestrian and vehicle evacuation access between the building and a flood safe accessible road.</p> <p>Note—A flood safe accessible road includes a road where identified as outside a flood hazard area or within a 'Low flood hazard area', 'Potential flood hazard area' or 'Significant flood hazard area' on the Flood hazard overlay maps (OM006a-o).</p>	NA	Not applicable
	<p>AO7.5 New temporary, relocatable or impermanent buildings and structures are to be anchored with the ability to withstand transportation by floodwater.</p> <p>Note—Building work must be certified by a qualified structural engineer.</p>	NA	Not applicable

Performance outcomes	Acceptable outcomes	Complies	Comments
	AO7.6 Dwellings do not exceed four bedrooms.	NA	Not applicable
	AO7.7 Building work on an existing dwelling does not comprise additional bedrooms.	NA	Not applicable
	AO7.8 Building work on an existing dwelling is limited to a maximum increase of 20 percent of the lawfully approved gross floor area of the existing dwelling.	NA	Not applicable
	AO7.9 Development does not increase the number of lots in the 'High flood hazard area; as identified on the Flood hazard overlay maps (OM006a-o) except where for the purposes of public open space.	NA	Not applicable
PO8 Development involving earthworks in a Flood hazard area below the defined flood level must protect life and property on premises and off premises through maintaining: (a) flood storage capacity of land; (b) flood conveyance function of land; (c) flood and drainage channels; (d) overland flow paths; and (e) flood warning times.	AO8 Filling above ground level is not undertaken in the 'High flood hazard area' identified on the Flood hazard overlay maps (OM006a-o) .	NA	Not applicable
Significant flood hazard area			

Performance outcomes	Acceptable outcomes	Complies	Comments
<p>PO9 Development, involving a Material change of use, within a 'Significant flood hazard area' on the Flood hazard overlay maps (OM006a-o) is appropriate to the flood hazard risk having regard to the:</p> <ul style="list-style-type: none"> (a) likelihood and frequency of flooding; (b) flood risk acceptability of development; (c) vulnerability of and safety risk to persons associated with the use; (d) associated consequences of flooding in regard to impacts on proposed buildings, structures and supporting infrastructure; and (e) associated consequences of flooding in respect to undue burden on disaster response recovery capacity and capabilities. 	<p>AO9 The following uses are not located within a 'Significant flood hazard area' identified on the Flood hazard overlay maps (OM006a-o):</p> <ul style="list-style-type: none"> (a) Residential care facility; (b) Retirement facility; (c) Child care centre; (d) Hospital; or (e) Community use. 	<p>NA</p>	<p>Not applicable</p>
<p>Significant flood hazard area, Low flood hazard area or Potential flood hazard area</p>			

Performance outcomes	Acceptable outcomes	Complies	Comments
<p>PO10 Development, where involving a Material change of use or Building work, is located and designed to:</p> <p>(a) maintain hydrological function of the premises;</p> <p>(b) not increase the number of people calculated to be at risk from flooding;</p> <p>(c) minimises the flood impact on adjoining premises;</p> <p>(d) ensure the safety of all persons by ensuring that a proportion of buildings are set above the defined flood level;</p> <p>(e) reduce the carriage of debris in flood waters;</p> <p>(f) reduce property damage; and</p> <p>(g) provide flood immune access to buildings.</p> <p>Note—Where the development is located in a 'Potential flood hazard area' identified on the Flood hazard overlay maps (OM006a-o) and there is no defined flood level a hydraulic (flood hazard assessment) report prepared by a RPEQ is required in substantiation of an alternative outcome is required or the defined flood level from the adjacent representative hazard zone is used.</p>	<p>AO10.1 Buildings, including extensions to existing buildings are:</p> <p>(a) elevated above the defined flood level; and</p> <p>(b) the defined flood event does not exceed a depth of 600mm; and</p> <p>(c) elevated above the defined flood level plus 0.3 metres freeboard where for habitable rooms within a dwelling.</p> <p>OR</p>	✓	<p>The proposed new dwelling is on the very edge of the low hazard zone above the high bank. Construction above the flood level will not involve any significant earthworks.</p>
	<p>AO10.2 Buildings used for Commercial activities or Industrial activities include a minimum floor level of 0.3 metres above the defined flood where for the following components of the use:</p> <p>(a) administrative areas; or</p> <p>(b) services, plant and equipment associated with the building.</p> <p>Note—AO10.2 accepts that the cost of flood impact is an operational cost of the Commercial activity or Industrial activity.</p>	NA	Not applicable
	<p>AO10.3 All building work below the defined flood level must be high set (comprising pier and beam construction) and retains the flood storage and conveyance capacity of the premises.</p> <p>Note—Building work must be certified by a qualified structural engineer to be flood proof including the ability to withstand damage from floodwater and debris.</p>	NA	Not applicable

Performance outcomes	Acceptable outcomes	Complies	Comments
<p>PO11 Development involving earthworks in a Flood hazard area below the defined flood level must protect life and property on premises and off premises through maintaining:</p> <ul style="list-style-type: none"> (a) flood storage capacity of land; (b) flood conveyance function of land; (c) flood and drainage channels; (d) overland flow paths; and (e) flood warning times. 	<p>AO11 Development does not involve in excess of 50m³ of fill above ground level per 1,000m² of site area.</p>	✓	Complies
<p>For assessable development</p>			
<p>Where for Material change of use or Reconfiguring a lot that involves new gross floor area or increases the number of persons living, working or residing in the Extreme flood hazard area, High flood hazard area or Significant flood hazard area other than a Dwelling house.</p>			

Performance outcomes	Acceptable outcomes	Complies	Comments
<p>PO12 Flood risk management minimises the impact on property and appropriately protects the health and safety of persons at risk of Extreme, high or significant flood hazard, and:</p> <ul style="list-style-type: none"> (a) indicates the position and path of all safe evacuation routes off the site; and (b) if the site contains or is within 100 metres of a flood hazard area, hazard warning signage and depth indicators are provided at key hazard points, such as at floodway crossings. <p>Note—A Material change of use or Reconfiguring a lot that involves new gross floor area or increases the number of persons living, working or residing in the 'Extreme flood hazard area' identified on the Flood hazard overlay map (OM006a-o) is supported by a Flood Emergency Evacuation Plan prepared by suitably qualified persons having regard to Floodplain Management in Australia: Best Practice Principles and Guidelines (2000), prepared by Standing Committee on Agriculture and Resource Management (SCARM), CSIRO.</p>	<p>AO12 No acceptable outcome is provided.</p>	<p>NA</p>	<p>Not applicable</p>

Performance outcomes	Acceptable outcomes	Complies	Comments
Significant flood hazard area, Low flood hazard area or Potential flood hazard area			
<p>PO13 Development, where involving Reconfiguring a lot, is located and designed to:</p> <ul style="list-style-type: none"> (a) maintain hydrological function of the premises; (b) not increase the number of people calculated to be at risk from flooding; (c) minimises the flood impact on adjoining premises; (d) ensure the safety of all persons by ensuring that a proportion of buildings are set above the defined flood level; (e) reduce the carriage of debris in flood waters; (f) reduce property damage; and (g) provide flood immune access to buildings. <p>Note—Where the development is located in a 'Potential flood hazard area' identified on the Flood hazard overlay maps (OM006a-o) and there is no defined flood level a hydraulic (flood hazard assessment) report prepared by a RPEQ is required in substantiation of an alternative outcome is required or the defined flood level from the adjacent representative hazard zone is used.</p>	<p>AO13 No acceptable outcome is provided.</p>	✓	<p>The development complies. The flood prone section of land is at the rear of the site. The entire proposed front block is outside of the flood hazard areas. The rear lot has a high bank that is roughly the same level as the modelled flood height. The proposed house location is on the edge of the lowest flood zone but will be constructed to the right level in accordance with the code.</p>

Table 8.2.6.3B Flood immunity levels

Development Category	Minimum design floor or pavement levels (mAHD)
Category A	1% AEP + 0.5 metres
Category B	1% AEP + 0.3 metres
Category C	1% AEP

Category D	1% AEP
Category E	2% AEP

Note—Refer Table 8.2.6.3D for building classification by Category.

Table 8.2.6.3C Community infrastructure flood immunity levels

Development Type	Minimum design floor or pavement levels (mAHD)
Emergency services, where for:	
• Emergency Shelters	0.1% AEP
• Police facilities	0.5% AEP
• Other Emergency services	0.1% AEP + 0.5 metres
Hospital	0.1% AEP+ 0.5 metres
Community use (where for the storage of valuable records or items of historic or cultural significance including libraries and museums)	0.5% AEP
Special industry (where for power station)	0.5% AEP
Substations	0.5% AEP
Utility installation (where for a sewage treatment plant)	Defined flood level
Utility installation (where for a water treatment plant)	0.5% AEP
Utility installation (other)	Alternative outcome required.
Air services	Alternative outcome required.

Table 8.2.6.3D Development category

Building Code of Australia Building classification ⁽¹⁾	Development types and design levels, assigned design floor or pavement levels	Category – refer to Table 8.2.6.3B for flood planning levels
Class 1–4	Habitable room	Category A
	Non-habitable room including patio and courtyard	Category B
	Non-habitable part of a Class 2 or Class 3 building excluding the essential services ⁽²⁾ control room	Category B
	Parking located in the building undercroft of a multiple dwelling	Category C
	Carport, unroofed car park; vehicular manoeuvring area	Category D
	Essential electrical services ⁽²⁾ of a Class 2 or Class 3 building only	Category A
	Basement parking entry	Category C + 0.3 metres
	Class 5, Class 6, or Class 8	Building floor level
Garage or car park located in the building undercroft		Category C

Building Code of Australia Building classification ⁽¹⁾	Development types and design levels, assigned design floor or pavement levels	Category – refer to Table 8.2.6.3B for flood planning levels
	Carport or unroofed car park	Category D
	Vehicular access and manoeuvring areas	Category D
	Basement parking entry	Category C
	Essential electrical services ⁽²⁾	Class 8 – Category Class 5 & 6 – Category A
Class 7a	Refer to the relevant building class specified in this table	
Class 7b	Building floor level	Category C
	Vehicular access and manoeuvring area	Category D
	Essential electrical services ⁽²⁾	Category C
Class 9	Building floor level	Category A
	Building floor level for habitable rooms in Class 9a or 9c where for a Residential care facility	0.2% AEP flood
	Building floor level for habitable rooms in Class 9b where involving children, such as a child care centre	0.2% AEP flood
	Garage or car park located in the building undercroft	Category C
	Carport or unroofed car park	Category D
	Vehicular access and manoeuvring areas	Category D
	Essential electrical services ⁽²⁾	Category A
Class 10a	Car parking facility	Refer to the relevant building class specified in this table
	Shed or the like	Category D
Class 10b	Swimming pool	Category E
	Associated mechanical and electrical pool equipment	Category C
	Other structures	Flood planning levels do not apply

⁽¹⁾ Refer to the Building Code of Australia for definitions of building classifications.

⁽²⁾ Essential electrical services include any area or room used for fire control panel, telephone PABX, sensitive substation equipment including transformers, low voltage switch gear, high voltage switch gear, battery chargers, protection control and communication equipment, low voltage cables, high voltage cables, and lift or pump controls.

9.4.4 Reconfiguring a lot code

9.4.4.1 Application

- (1) This code applies to assessing development where:
 - (a) for Reconfiguring a lot; and
 - (b) it is identified in the assessment benchmarks for assessable development and requirements for accepted development column of an assessment table in Part 5 of the planning scheme.

9.4.4.2 Purpose

- (1) The purpose of the Reconfiguring a lot code is to ensure that land is:
 - (a) arranged in a manner which is consistent with the intended scale and intensity of development within the area;
 - (b) provided with access to appropriate movement and open space networks; and
 - (c) contributes to housing diversity and accommodates a range of land uses.
- (2) The purpose of the code will be achieved through the following overall outcomes:
 - (a) Subdivision of land achieves the efficient use of land and the efficient provision of infrastructure and transport services;
 - (b) Lots are of a suitable size and shape for the intended or potential use having regard to the purpose and overall outcomes of the relevant zone or precinct.
 - (c) Subdivision of land creates lots with sufficient area and dimensions to accommodate the ultimate use, meet user requirements, protect environmental features and account for site constraints;
 - (d) A range and mix of lot sizes is provided to facilitate a variety of industry and housing types;
 - (e) Subdivision design incorporates a road network that provides connectivity and circulation for vehicles and provide safe and efficient access for pedestrians, cyclists and public transport;
 - (f) Subdivision design provides opportunities for walking and cycling for recreation and as alternative methods of travel;
 - (g) Subdivision of land provides and integrates a range of functional parkland, including local and district parks and open space links for the use and enjoyment of the residents of the locality and the shire;
 - (h) Subdivision of land contributes to an open space network that achieves connectivity along riparian corridors and between areas with conservation values;
 - (i) Subdivision within the Rural zone maintains rural landholdings in viable parcels;
 - (j) Land in historical townships is not reconfigured to be used for urban purposes; and
 - (k) Residential subdivision and greenfield development is designed to consider and respect:
 - i. topography;
 - ii. climate responsive design and solar orientation;
 - iii. efficient and sustainable infrastructure provision;
 - iv. environmental values;
 - v. water sensitive urban design;
 - vi. good quality agricultural land; and
 - vii. the character and scale of surrounding development.

9.4.4.3 Criteria for assessment

Table 9.4.4.3A—Reconfiguring a lot code – For assessable development

Performance outcomes	Acceptable outcomes	Complies	Comments
Area and frontage of lots			
<p>PO1 Lots include an area and frontage that:</p> <ul style="list-style-type: none"> (a) is consistent with the design of lots in the surrounding area; (b) allows the desired amenity of the zone to be achieved; (c) is able to accommodate all buildings, structures and works associated with the intended land use; (d) allow the site to be provided with sufficient access; (e) considers the proximity of the land to: <ul style="list-style-type: none"> (i) centres; (ii) public transport services; and (iii) open space; and (f) allows for the protection of environmental features; and (g) accommodates site constraints. 	<p>AO1.1 Lots provide a minimum area and frontage in accordance with Table 9.4.4.3B.</p>	✓	<p>The proposed development does not meet the Table 9.4.4.3B minimum requirements for lot size and includes a rear lot with reduced frontage. However the development does comply with the performance outcomes. The proposed configuration is consistent with the development in the local vicinity – it is rural residential in nature and has lot sizes consistent with those in the surrounding area. The development provides for residential amenity, has sufficient space for the development to be contained outside of the flood hazard area, has existing access, is within close proximity to Mareeba, does not involve clearing vegetation and has no other constraints.</p>
Existing buildings and easements			

Performance outcomes	Acceptable outcomes	Complies	Comments
PO2 Reconfiguring a lot which contains existing land uses or existing buildings and structures ensures: (a) new lots are of sufficient area and dimensions to accommodate existing land uses, buildings and structures; and (b) any continuing use is not compromised by the reconfiguration.	AO2.1 Each land use and associated infrastructure is contained within its individual lot.	✓	Complies
	AO2.2 All lots containing existing buildings and structures achieve the setback requirements of the relevant zone.	✓	Complies
PO3 Reconfiguring a lot which contains an existing easement ensures: (a) future buildings, structures and accessways are able to be sited to avoid the easement; and (b) the reconfiguration does not compromise the purpose of the easement or the continued operation of any infrastructure contained within the easement.	AO3 No acceptable outcome is provided.	✓	Complies
Boundary realignment			
PO4 The boundary realignment retains all attendant and existing infrastructure connections and potential connections.	AO4 No acceptable outcome is provided.	NA	Not applicable
Access and road network			

Performance outcomes	Acceptable outcomes	Complies	Comments
<p>PO5 Access to a reconfigured lot (including driveways and paths) must not have an adverse impact on:</p> <ul style="list-style-type: none"> (a) safety; (b) drainage; (c) visual amenity; (d) privacy of adjoining premises; and (e) service provision. 	<p>AO5 No acceptable outcome is provided.</p>	✓	<p>Complies. The accesses are existing, safe and functional</p>
<p>PO6 Reconfiguring a lot ensures that access to a lot can be provided that:</p> <ul style="list-style-type: none"> (a) is consistent with that provided in the surrounding area; (b) maximises efficiency and safety; and (c) is consistent with the nature of the intended use of the lot. <p>Note—The Parking and access code should be considered in demonstrating compliance with PO6.</p>	<p>AO6 Vehicle crossover and access is provided in accordance with the design guidelines and specifications set out in Planning Scheme Policy 4 – FNQROC Regional Development Manual.</p>	✓	<p>Complies. The accesses are existing, safe and cater for the intended use.</p>
<p>PO7 Roads in the Industry zone are designed having regard to:</p> <ul style="list-style-type: none"> (a) the intended use of the lots; (b) the existing use of surrounding land; (c) the vehicular servicing requirements of the intended use; (d) the movement and turning requirements of B-Double vehicles. <p>Note—The Parking and access code should be considered in demonstrating compliance with PO7.</p>	<p>AO7 No acceptable outcome is provided.</p>	NA	<p>Not applicable</p>
Rear lots			
<p>PO8 Rear lots are designed to:</p> <ul style="list-style-type: none"> (a) provide a high standard of amenity for residents 	<p>AO8.1 Rear lots are designed to facilitate development that adjoins or overlooks a park or open space.</p>	✓	<p>Development complies. There is a watercourse behind the rear lot.</p>

Performance outcomes	Acceptable outcomes	Complies	Comments
(b) and other users of the site; provide a high standard of amenity for adjoining properties; and	AO8.2 No more than two rear lots are created behind any lot with a road frontage.	✓	Complies
(c) not adversely affect the safety and efficiency of the road from which access is gained.	AO8.3 Access to lots is via an access strip with a minimum width of: (a) 4 metres where in the Low density residential zone or Medium density residential zone; or (b) 8 metres otherwise.	✓	Complies
	AO8.4 A single access strip is provided to a rear lot along one side of the lot with direct frontage to the street. Note—Figure A provides further guidance in relation to the desired outcome.	✓	Complies
	AO8.5 No more than 1 in 10 lots created in a new subdivision are rear lots.	✓	Complies
	AO8.6 Rear lots are not created in the Centre zone or the Industry zone.	✓	Complies
Crime prevention and community safety			

Performance outcomes	Acceptable outcomes	Complies	Comments
<p>PO9 Development includes design features which enhance public safety and seek to prevent opportunities for crime, having regard to:</p> <ul style="list-style-type: none"> (a) sightlines; (b) the existing and intended pedestrian movement network; (c) the existing and intended land use pattern; and (d) potential entrapment locations. 	<p>AO9 No acceptable outcome is provided.</p>	✓	<p>The development does not create entrapment locations, in fact there will be very little change.</p>
Pedestrian and cycle movement network			
<p>PO10 Reconfiguring a lot must assist in the implementation of a Pedestrian and cycle movement network to achieve safe, attractive and efficient pedestrian and cycle networks.</p>	<p>AO10 No acceptable outcome is provided.</p>	✓	<p>No changes are proposed to the existing road and transport infrastructure as it is adequate to support the proposed development.</p>
Public transport network			
<p>PO11 Where a site includes or adjoins a future public transport corridor or future public transport site identified through a structure planning process, development:</p> <ul style="list-style-type: none"> (a) does not prejudice the future provision of the identified infrastructure; (b) appropriately treats the common boundary with the future corridor; and (c) provides opportunities to integrate with the adjoining corridor where a it will include an element which will attract pedestrian movement. 	<p>AO11 No acceptable outcome is provided.</p>	✓	<p>The land is not identified for significant public transport infrastructure.</p>
Residential subdivision			

Performance outcomes	Acceptable outcomes	Complies	Comments
<p>PO12 Residential lots are:</p> <p>(a) provided in a variety of sizes to accommodate housing choice and diversity; and</p> <p>(b) located to increase variety and avoid large areas of similar lot sizes.</p>	<p>AO12 No acceptable outcome is provided.</p>	✓	<p>Complies. The lot sizes are similar to the surrounding area but offer a variety of sizes.</p>
Rural residential zone			
<p>PO13 New lots are only created in the Rural residential zone where land is located within the 4,000m² precinct, the 1 hectare precinct or the 2 hectare precinct.</p>	<p>AO13 No acceptable outcome is provided.</p>	NA	<p>Not applicable</p>
Additional provisions for greenfield development only			
<p>PO14 The subdivision design provides the new community with a local identity by responding to:</p> <p>(a) site context</p> <p>(b) site characteristics</p> <p>(c) setting</p> <p>(d) landmarks</p> <p>(e) natural features; and</p> <p>(f) views.</p>	<p>AO14 No acceptable outcome provided.</p>	NA	<p>Not applicable</p>
<p>PO15 The road network is designed to provide a high level of connectivity, permeability and circulation for local vehicles, public transport, pedestrians and cyclists.</p>	<p>AO15 No acceptable outcome provided.</p>	NA	<p>Not applicable</p>

Performance outcomes	Acceptable outcomes	Complies	Comments
<p>PO16 The road network is designed to:</p> <ul style="list-style-type: none"> (a) minimise the number of cul-de-sacs; (b) provide walkable catchments for all residents in cul-de-sacs; and (c) include open cul-de-sacs heads. <p>Note—Figure B provides further guidance in relation to the desired outcome.</p>	<p>AO16 No acceptable outcome provided.</p>	NA	Not applicable
<p>PO17 Reconfiguring a lot provides safe and convenient access to the existing or future public transport network.</p>	<p>AO17 The subdivision locates 90% of lots within 400 metres walking distance of a future public transport route.</p>	NA	Not applicable
<p>PO18 The staging of the lot reconfiguration prioritises delivery of link roads to facilitate efficient bus routes.</p>	<p>AO18 No acceptable outcome provided.</p>	NA	Not applicable
<p>PO19 Provision is made for sufficient open space to:</p> <ul style="list-style-type: none"> (a) meet the needs of the occupiers of the lots and to ensure that the environmental and scenic values of the area are protected; (b) retain riparian corridors, significant vegetation and habitat areas and provides linkages between those areas; and (c) meet regional, district and neighbourhood open space requirements. 	<p>AO19.1 A minimum of 10% of the site area is dedicated as open space.</p>	NA	Not applicable
	<p>AO19.2 A maximum of 30% of the proposed open space can consist of land identified as significant vegetation or riparian corridor buffer.</p>	NA	Not applicable

Performance outcomes	Acceptable outcomes	Complies	Comments
PO20 A network of parks and community land is provided: <ul style="list-style-type: none"> (a) to support a full range of recreational and sporting activities; (b) to ensure adequate pedestrian, cycle and vehicle access; (c) which is supported by appropriate infrastructure and embellishments; (d) to facilitate links between public open spaces; (e) which is co-located with other existing or proposed community infrastructure; (f) which is consistent with the preferred open space network; and (g) which includes a diversity of settings; 	AO20 No acceptable outcome is provided.	NA	Not applicable

Table 9.4.4.3B—Minimum area and dimensions for Reconfiguring a lot

Zone	Type	Minimum area	Minimum frontage
Centre	All lots	800m ²	20 metres
Community facilities	All lots	Not specified	Not specified
Conservation	All lots	Not specified	Not specified
Emerging community	All lots	10 hectares	100 metres
Low density residential	Where greenfield development and connected to reticulated water and sewerage		
	Rear lot	800m ²	5 metres
	All other lots	350m ²	10 metres
	Where connected to reticulated water and sewerage		
	Rear lot	800m ²	5 metres
	All other lots	600m ²	16 metres
	Where connected to reticulated water		
	Rear lot	1,000m ²	5 metres
	All other lots	800m ²	16 metres
Medium density residential	Rear lot	600m ²	5 metres
	All other lots	400m ²	10 metres
Industry	All lots	1,500m ²	45 metres
Recreation and open space	All lots	Not specified	Not specified

Zone	Type	Minimum area	Minimum frontage
Rural	All lots	60 hectares	400 metres
Rural residential	2 hectare precinct		
	All lots	2 hectares	60 metres
	1 hectare precinct		
	All lots	1 hectare	40 metres
	4,000m ² precinct		
	All lots	4,000m ²	40 metres

Figure A – Examples of access to rear lots

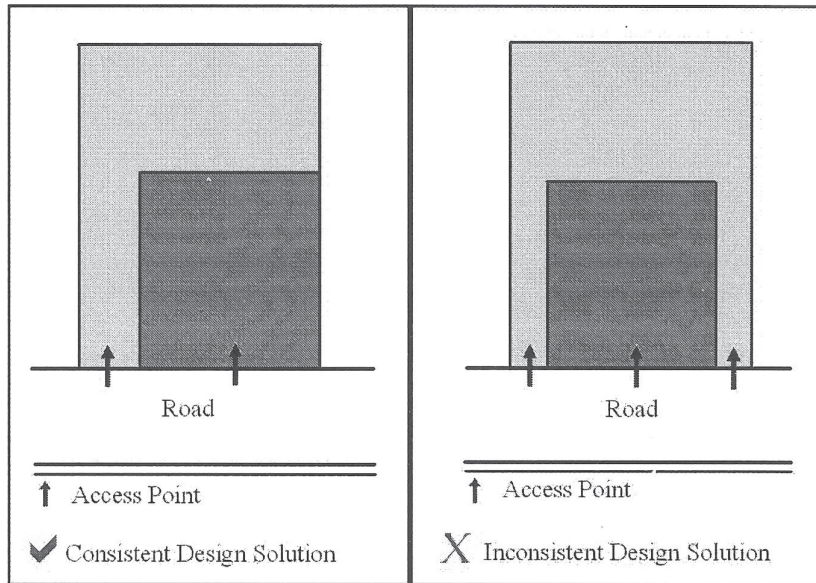
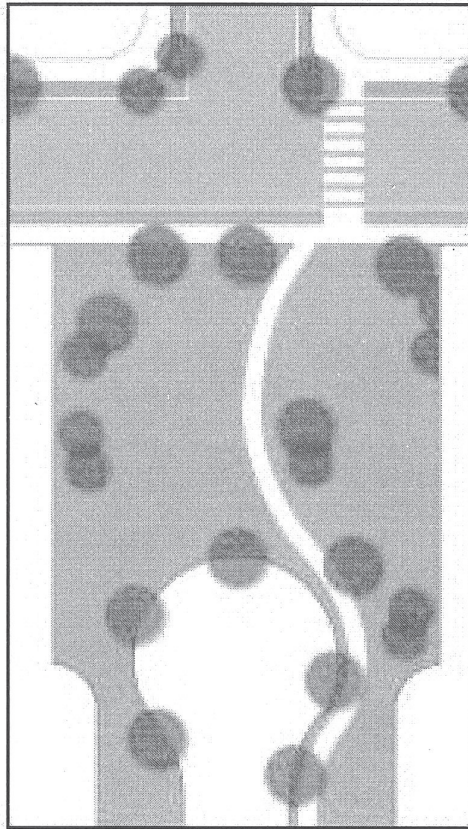

Figure B – Example of cul-de-sac design



9.4.5 Works, services and infrastructure code

9.4.5.1 Application

- (1) This code applies to assessing development where it is identified in the assessment benchmarks for assessable development and requirements for accepted development column of an assessment table in Part 5 of the planning scheme.

9.4.5.2 Purpose

- (1) The purpose of the Works, services and infrastructure code is to ensure that all development is appropriately serviced by physical infrastructure, public utilities and services and that work associated with development is carried out in a manner that does not adversely impact on the surrounding area.
- (2) The purpose of the code will be achieved through the following overall outcomes:
 - (a) Development provides an adequate, safe and reliable supply of potable, fire-fighting and general use water in accordance with relevant standards;
 - (b) Development provides for the treatment and disposal of wastewater and ensures there are no adverse impacts on water quality, public health, local amenity or ecological processes;
 - (c) Development provides for the disposal of stormwater and ensures that there are no adverse impacts on water quality or ecological processes;
 - (d) Development connects to the road network and any adjoining public transport, pedestrian and cycle networks while ensuring no adverse impacts on the safe, convenient and efficient operation of these networks;
 - (e) Development provides electricity and telecommunications services that meet its desired requirements;
 - (f) Development is connected to a nearby electricity network with adequate capacity without significant environment, social or amenity impact;
 - (g) Development does not affect the efficient functioning of public utility mains, services or installations;
 - (h) Infrastructure dedicated to Council is cost effective over its life cycle;
 - (i) Work associated with development does not cause adverse impacts on the surrounding area; and
 - (j) Development prevents the spread of weeds, seeds or other pests.

9.4.5.3 Criteria for assessment

Table 9.4.5.3 - Works, services and infrastructure code – For accepted development subject to requirements and assessable development

Performance outcomes	Acceptable outcomes	Complies	Comments
For accepted development subject to requirements and assessable development			
Water supply			

Performance outcomes	Acceptable outcomes	Complies	Comments
<p>PO1 Each lot has an adequate volume and supply of water that:</p> <ul style="list-style-type: none"> (a) meets the needs of users; (b) is adequate for fire-fighting purposes; (c) ensures the health, safety and convenience of the community; and (d) minimises adverse impacts on the receiving environment. 	<p>AO1.1 Development is connected to a reticulated water supply system in accordance with the Design Guidelines and Specifications set out in the Planning Scheme Policy 4 – FNQROC Regional Development Manual other than where located:</p> <ul style="list-style-type: none"> (a) in the Conservation zone, Rural zone or Rural residential zone; and (b) outside a reticulated water supply service area. 	✓	Complies
	<p>AO1.2 Development, where located outside a reticulated water supply service area and in the Conservation zone, Rural zone or Rural residential zone is provided with:</p> <ul style="list-style-type: none"> (a) a bore or bores are provided in accordance with the Design Guidelines set out in the Planning Scheme Policy 4 – FNQROC Regional Development Manual; or (b) on-site water storage tank/s: <ul style="list-style-type: none"> (i) with a minimum capacity of 90,000L; (ii) fitted with a 50mm ball valve with a camlock fitting; and (iii) which are installed and connected prior to the occupation or use of the development. 	NA	Not applicable
Wastewater disposal			

Performance outcomes	Acceptable outcomes	Complies	Comments
<p>PO2 Each lot provides for the treatment and disposal of effluent and other waste water that:</p> <ul style="list-style-type: none"> (a) meets the needs of users; (b) is adequate for fire-fighting purposes; (c) ensures the health, safety and convenience of the community; and (d) minimises adverse impacts on the receiving environment. 	<p>AO2.1 Development is connected to a reticulated sewerage system in accordance with the Design Guidelines and Specifications set out in the Planning Scheme Policy 4 – FNQROC Regional Development Manual other than where located:</p> <ul style="list-style-type: none"> (a) in the Conservation zone, Rural zone or Rural residential zone; and (b) outside a reticulated sewerage service area. 	NA	Not applicable
	<p>AO2.2 An effluent disposal system is provided in accordance with AS/NZS 1547 On-Site Domestic Wastewater Management (as amended) where development is located:</p> <ul style="list-style-type: none"> (a) in the Conservation zone, Rural zone or Rural residential zone; and (b) outside a reticulated sewerage service area. 	✓	Complies
Stormwater infrastructure			
<p>PO3 Stormwater infrastructure is designed and constructed to collect and convey the design storm event to a lawful point of discharge in a manner that mitigates impacts on life and property.</p>	<p>AO3.1 Where located within a Priority infrastructure area or where stormwater infrastructure is available, development is connected to Council's stormwater network in accordance with the Design Guidelines and Specifications set out in the Planning Scheme Policy 4 – FNQROC Regional Development Manual.</p>	✓	Complies. Stormwater infrastructure is existing.

Performance outcomes	Acceptable outcomes	Complies	Comments
	<p>AO3.2 On-site drainage systems are constructed:</p> <ul style="list-style-type: none"> (a) to convey stormwater from the premises to a lawful point of discharge; and (b) in accordance with the Design Guidelines and Specifications set out in the Planning Scheme Policy 4 – FNQROC Regional Development Manual. 	✓	Complies
Electricity supply			
<p>PO4 Each lot is provided with an adequate supply of electricity</p>	<p>AO4 The premises:</p> <ul style="list-style-type: none"> (a) is connected to the electricity supply network; or (b) has arranged a connection to the transmission grid; or (c) where not connected to the network, an independent energy system with sufficient capacity to service the development (at near average energy demands associated with the use) may be provided as an alternative to reticulated electricity where: <ul style="list-style-type: none"> (i) it is approved by the relevant regulatory authority; and (ii) it can be demonstrated that no air or noise emissions; and (iii) it can be demonstrated that no adverse impact on visual amenity will occur. 	✓	Complies. The property is connected to electricity.
Telecommunications infrastructure			

Performance outcomes	Acceptable outcomes	Complies	Comments
PO5 Each lot is provided with an adequate supply of telecommunication infrastructure	AO5 Development is provided with a connection to the national broadband network or telecommunication services.	✓	Complies. The property is connected.
Existing public utility services			
PO6 Development and associated works do not affect the efficient functioning of public utility mains, services or installations.	AO6 Public utility mains, services are relocated, altered or repaired in association with the works so that they continue to function and satisfy the relevant Design Guidelines and Specifications set out in the Planning Scheme Policy 4 – FNQROC Regional Development Manual.	✓	Complies. No works are required that would affect utility mains.
Excavation or filling			
PO7 Excavation or filling must not have an adverse impact on the: (a) streetscape; (b) scenic amenity; (c) environmental values; (d) slope stability; (e) accessibility; or (f) privacy of adjoining premises.	AO7.1 Excavation or filling does not occur within 1.5 metres of any site boundary.	✓	Complies. No significant earthworks are proposed.
	AO7.2 Excavation or filling at any point on a lot is to be no greater than 1.5 metres above or below natural ground level.	✓	Complies. A new house pad would be the extent of earthworks.
	AO7.3 Earthworks batters: (a) are no greater than 1.5 metres in height; (b) are stepped with a minimum width 2 metre berm; (c) do not exceed a maximum of two batters and two berms (not greater than 3.6 metres in total height) on any one lot; (d) have a slope no greater than 1 in 4; and (e) are retained.	✓	Complies

Performance outcomes	Acceptable outcomes	Complies	Comments
	<p>AO7.4 Soil used for filling or spoil from excavation is not stockpiled in locations that can be viewed from:</p> <ul style="list-style-type: none"> (a) adjoining premises; or (b) a road frontage, for a period exceeding 1 month from the commencement of the filling or excavation. 	NA	Not applicable
	<p>AO7.5 All batters and berms to be constructed in accordance with the Design Guidelines and Specifications set out in the Planning Scheme Policy 4 – FNQROC Regional Development Manual.</p>	NA	Not applicable
	<p>AO7.6 Retaining walls have a maximum height of 1.5 metres and are designed and constructed in accordance with the Design Guidelines and Specifications set out in the Planning Scheme Policy 4 – FNQROC Regional Development manual.</p>	NA	Not applicable
	<p>AO7.7 Excavation or filling at any point on a lot is to include measures that protect trees at the foot or top of cut or fill batters by the use of appropriate retaining methods and sensitive earth removal or placement and in accordance with the Design Guidelines and Specifications set out in the Planning Scheme Policy 4 – FNQROC Regional Development manual.</p>	NA	Not applicable
For assessable development			
Transport network			

Performance outcomes	Acceptable outcomes	Complies	Comments
PO8 The development has access to a transport network of adequate standard to provide for the safe and efficient movement of vehicles, pedestrians and cyclists.	AO8.1 Vehicle access, crossovers, road geometry, pavement, utilities and landscaping to the frontage/s of the site are designed and constructed in accordance with the Design Guidelines and Specifications set out in the Planning Scheme Policy 4 – FNQROC Regional Development manual.	✓	Complies
	AO8.2 Development provides footpath pavement treatments in accordance with Planning Scheme Policy 9 – Footpath Paving.	✓	No footpath is proposed given the rural residential nature of the development.
Public infrastructure			
PO9 The design, construction and provision of any infrastructure that is to be dedicated to Council is cost effective over its life cycle and incorporates provisions to minimise adverse impacts.	AO9 Development is in accordance with the Design Guidelines and Specifications set out in the Planning Scheme Policy 4 – FNQROC Regional Development Manual.	✓	Complies. No new public infrastructure is required.
Stormwater quality			

Performance outcomes	Acceptable outcomes	Complies	Comments
<p>PO10 Development has a non-worsening effect on the site and surrounding land and is designed to:</p> <ul style="list-style-type: none"> (a) optimise the interception, retention and removal of waterborne pollutants, prior to the discharge to receiving waters; (b) protect the environmental values of waterbodies affected by the development, including upstream, on-site and downstream waterbodies; (c) achieve specified water quality objectives; (d) minimise flooding; (e) maximise the use of natural channel design principles; (f) maximise community benefit; and (g) minimise risk to public safety. 	<p>AO10.1 The following reporting is prepared for all Material change of use or Reconfiguring a lot proposals:</p> <ul style="list-style-type: none"> (a) a Stormwater Management Plan and Report that meets or exceeds the standards of design and construction set out in the Queensland Urban Drainage Manual (QUDM) and the Design Guidelines and Specifications set out in the Planning Scheme Policy 4 – FNQROC Regional Development Manual; and (b) an Erosion and Sediment Control Plan that meets or exceeds the Soil Erosion and Sedimentation Control Guidelines (Institute of Engineers Australia), including: <ul style="list-style-type: none"> (i) drainage control; (ii) erosion control; (iii) sediment control; and (iv) water quality outcomes. 	<p>✓</p>	<p>Existing stormwater and drainage systems remain unaltered.</p>

Performance outcomes	Acceptable outcomes	Complies	Comments
	<p>AO10.2 For development on land greater than 2,500m² or that result in more than 5 lots or more than 5 dwellings or accommodation units, a Stormwater Quality Management Plan and Report prepared and certified by a suitably qualified design engineer (RPEQ) is prepared that demonstrates that the development:</p> <ul style="list-style-type: none"> (a) meets or exceeds the standards of design and construction set out in the Urban Stormwater Quality Planning Guideline and the Queensland Water Quality Guideline; (b) is consistent with any local area stormwater water management planning; (c) accounts for development type, construction phase, local climatic conditions and design objectives; and (d) provides for stormwater quality treatment measures reflecting land use constraints, such as soil type, landscape features (including landform), nutrient hazardous areas, acid sulfate soil and rainfall erosivity. 	NA	Not applicable

Performance outcomes	Acceptable outcomes	Complies	Comments
<p>PO11 Storage areas for stormwater detention and retention:</p> <p>(a) protect or enhance the environmental values of receiving waters;</p> <p>(b) achieve specified water quality objectives;</p> <p>(c) where possible, provide for recreational use;</p> <p>(d) maximise community benefit; and</p> <p>(e) minimise risk to public safety.</p>	<p>AO11 No acceptable outcome is provided.</p>	NA	Not applicable
Excavation or filling			
<p>PO12 Traffic generated by filling or excavation does not impact on the amenity of the surrounding area.</p>	<p>AO12.1 Haul routes used for transportation of fill to or from the site only use major roads and avoid residential areas.</p>	NA	Not applicable
	<p>AO12.2 Transportation of fill to or from the site does not occur:</p> <p>(a) within peak traffic times; and</p> <p>(b) before 7am or after 6pm Monday to Friday;</p> <p>(c) before 7am or after 1pm Saturdays; and</p> <p>(d) on Sundays or Public Holidays.</p>	NA	Not applicable

Performance outcomes	Acceptable outcomes	Complies	Comments
PO13 Air pollutants, dust and sediment particles from excavation or filling, do not cause significant environmental harm or nuisance impacts.	AO13.1 Dust emissions do not extend beyond the boundary of the site.	NA	Not applicable
	AO13.2 No other air pollutants, including odours, are detectable at the boundary of the site.	✓	Complies. The development will not generate air pollutants.
	AO13.3 A management plan for control of dust and air pollutants is prepared and implemented.	NA	Not applicable
PO14 Access to the premises (including driveways and paths) does not have an adverse impact on: (a) safety; (b) drainage; (c) visual amenity; and (d) privacy of adjoining premises.	AO14 Access to the premises (including all works associated with the access): (a) must follow as close as possible to the existing contours; (b) be contained within the premises and not the road reserve, and (c) are designed and constructed in accordance with the Design Guidelines and Specifications set out in the Planning Scheme Policy 4 – FNQROC Regional Development manual.	✓	Complies. The accesses will be constructed in accordance with the Design Guidelines.
Weed and pest management			
PO15 Development prevents the spread of weeds, seeds or other pests into clean areas or away from infested areas.	AO15 No acceptable outcome is provided.	✓	Complies. No works or clearing is required.
Contaminated land			

Performance outcomes	Acceptable outcomes	Complies	Comments
<p>PO16 Development is located and designed to ensure that users and nearby sensitive land uses are not exposed to unacceptable levels of contaminants</p>	<p>AO16 Development is located where: (a) soils are not contaminated by pollutants which represent a health or safety risk to users; or (b) contaminated soils are remediated prior to plan sealing, operational works permit, or issuing of building works permit.</p>	✓	Complies.
Fire services in developments accessed by common private title			
<p>PO17 Fire hydrants are located in positions that will enable fire services to access water safely, effectively and efficiently.</p>	<p>AO17.1 Fire hydrants are located in accessways or private roads held in common private title at a maximum spacing of: (a) 120 metres for residential development; and (b) 90 metres for any other development.</p>	✓	Complies. Hydrants are existing.
	<p>AO17.2 Fire hydrants are located at all intersections of accessways or private roads held in common private title.</p>	✓	Complies. Hydrants are existing.

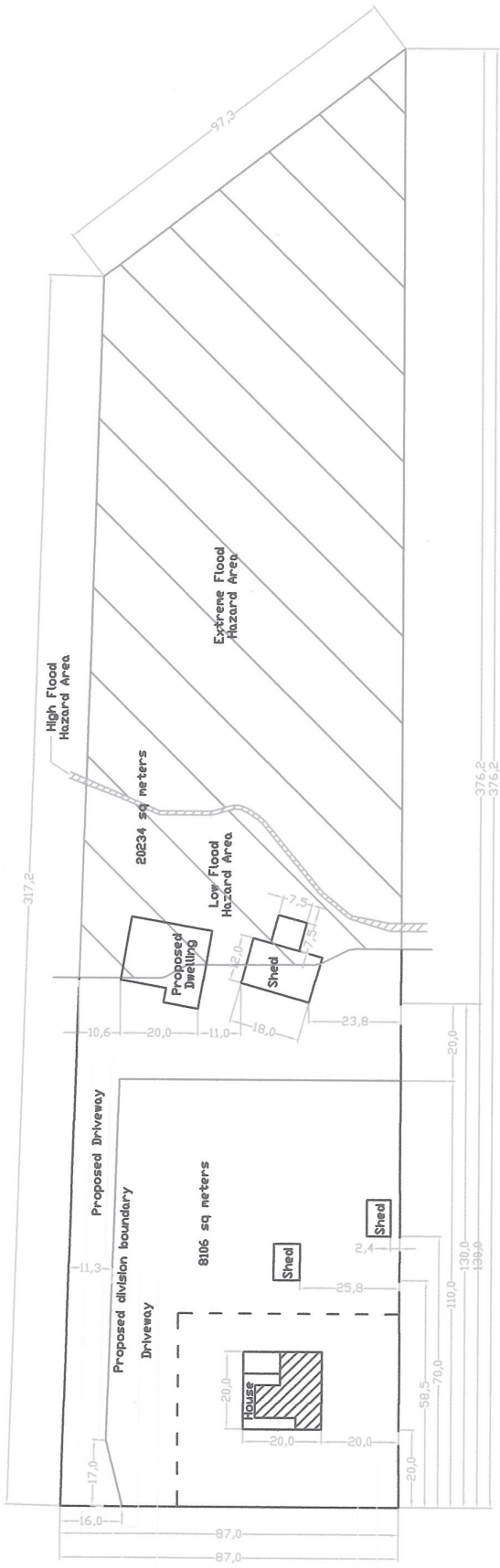

McGrath Road

Drawn S.P.B.	80 / 90 McGrath Road Lot 1PR736571
Date 24-10-2017	Proposed Property Building and Flood Area Details

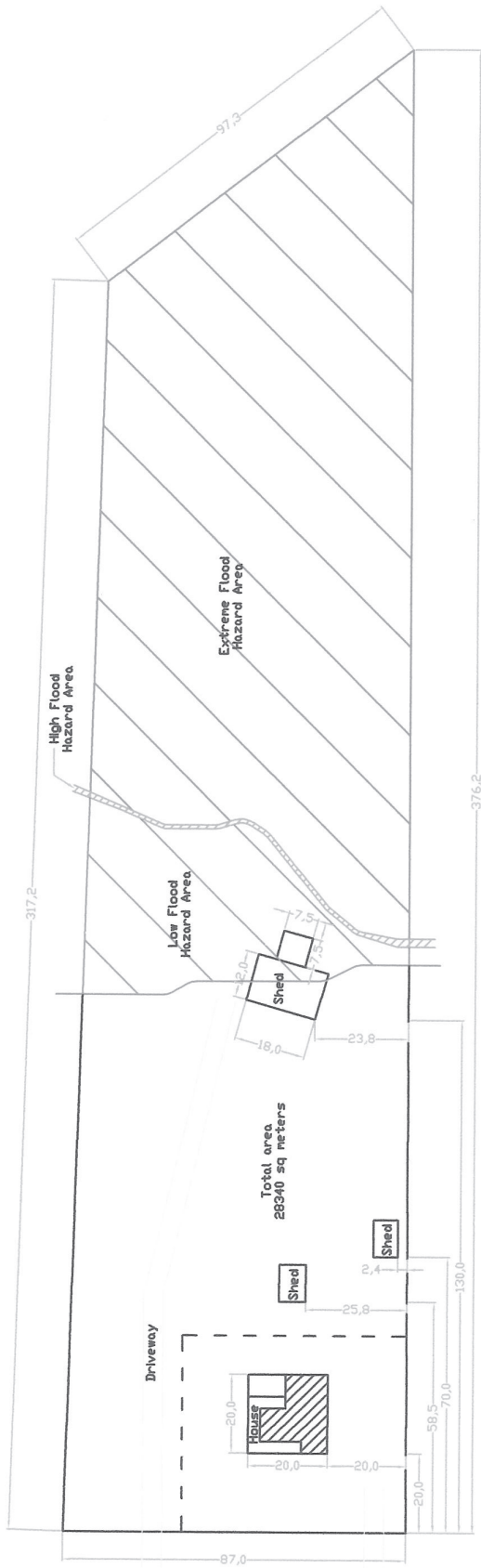

McGrath Road

Drawn S.P.B.	80 / 90 McGrath Road Lot 1PR736571
Date 24-10-2017	Existing Property Building and Flood Area Details