

Assessment of application against relevant Development Codes

APPLICATION DETAILS

APPLICATION		PREMISES	
FILE NO:	RAL/22/0015	ADDRESS:	7-9 Santowski Crescent, Mount Molloy
APPLICANT:	J Cunnington	RPD:	Lot 268 on DA403
LODGED BY:	J Cunnington	AREA:	3,665m ²
DATE LODGED:	29 August 2022	OWNER :	J Cunnington
TYPE OF APPROVAL:	Development Permit		
PROPOSED DEVELOPMENT:	Reconfiguring a Lot - Subdivision (1 into 2 Lots)		
PLANNING SCHEME:	Mareeba Shire Council Planning Scheme 2016		
ZONE:	Low density residential		
LEVEL OF ASSESSMENT:	Code Assessment		
SUBMISSIONS:	N/A - Code assessment only		

Relevant Development Codes

The following Development Codes are considered to be applicable to the assessment of the application:

- 6.2.6 Low density residential zone code
- 8.2.3 Bushfire hazard overlay code
- 8.2.6 Flood hazard overlay code
- 8.2.8 Hill and slope overlay code
- 9.4.2 Landscaping code
- 9.4.3 Parking and access code
- 9.4.4 Reconfiguring a lot code
- 9.4.5 Works, services and infrastructure code

6.2.6 Low density residential zone code

6.2.6.1 Application

- (1) This code applies to assessing development where:
 - (a) located in the Low density residential zone; and
 - (b) it is identified in the assessment benchmarks for assessable development and requirements for accepted development column of an assessment table in Part 5 of the planning scheme.

6.2.6.2 Purpose

- (1) The purpose of the Low density residential zone code is to provide for predominantly dwelling houses supported by community uses and small-scale services and facilities that cater for local residents.
- (2) Mareeba Shire Council's purpose of the Low density residential zone code is to:
 - (a) maintain the integrity of established residential areas, which are characterised primarily by Dwelling houses and Dual occupancy development;
 - (b) provide opportunities for other forms of residential development where existing character and amenity will not be compromised; and
 - (c) facilitate non-residential development that directly supports the day to day needs of the immediate residential community, in new residential areas.
- (3) The purpose of the code will be achieved through the following overall outcomes:
 - (a) The dominant form of development is detached dwelling houses, on a range of lot sizes;
 - (b) In greenfield areas, in proximity to activity centres, a wider range of higher density residential development may occur where existing low density residential amenity is not compromised;
 - (c) High quality Residential care facilities and Retirement facilities are located on larger sites;
 - (d) Development provides for an efficient land use pattern and is well connected to other developments;
 - (e) Development is designed to provide safe and walkable neighbourhoods that connect residents to desirable destinations including schools, parks, shops and community facilities;
 - (f) Development facilitates other small-scale uses that integrate personal employment and residential activities, provided they complement local residential amenity;
 - (g) Development maintains a high level of residential amenity avoiding uses that introduce impacts associated with noise, hours of operation, traffic, advertising devices, visual amenity, privacy, lighting, odour and emissions;
 - (h) Development reflects and enhances the existing low density scale and character of the area;
 - (i) Development is supported by necessary transport infrastructure which is designed to provide and promote safe and efficient public transport use, walking and cycling;
 - (j) Development is supported by necessary community facilities, open space and recreational areas and appropriate infrastructure to meet the needs of the local community;
 - (k) Non-residential development may be supported in new residential areas where such uses directly support the day to day needs of the immediate residential community;
 - (l) Development takes account of the environmental constraints of the land; and

- (m) Any unavoidable impacts are minimised through location, design, operation and management requirements.

6.2.6.3 Criteria for assessment

Table 6.2.6.3A—Low density residential zone code - For accepted development subject to requirements and assessable development

Performance outcomes	Acceptable outcomes	Complies	Comments
For accepted development subject to requirements and assessable development			
Height			
<p>PO1 Building height takes into consideration and respects the following:</p> <ul style="list-style-type: none"> (a) the height of existing buildings on adjoining premises; (b) the development potential, with respect to height, on adjoining premises; (c) the height of buildings in the vicinity of the site; (d) access to sunlight and daylight for the site and adjoining sites; (e) privacy and overlooking; and (f) site area and street frontage length. 	<p>AO1 Development has a maximum building height of:</p> <ul style="list-style-type: none"> (a) 8.5 metres; and (b) 2 storeys above ground level. 	n/a	Not applicable at reconfiguration stage.
Outbuildings and residential scale			
<p>PO2 Domestic outbuildings:</p> <ul style="list-style-type: none"> (a) do not dominate the lot on which they are located; and (b) are consistent with the scale and character of development in the Low-density residential zone. 	<p>AO2 Domestic outbuildings do not exceed:</p> <ul style="list-style-type: none"> (a) 100m² in gross floor area; and (b) 5.5 metres in height above natural ground level. 	n/a	Not applicable at reconfiguration stage.
Siting			

Performance outcomes	Acceptable outcomes	Complies	Comments
<p>PO3 Development is sited in a manner that considers and respects:</p> <ul style="list-style-type: none"> (a) the siting and use of adjoining premises; (b) access to sunlight and daylight for the site and adjoining sites; (c) privacy and overlooking; (d) opportunities for casual surveillance of adjoining public spaces; (e) air circulation and access to natural breezes; and (f) appearance of building bulk; and (g) relationship with road corridors. 	<p>AO3.1 Buildings and structures include a minimum setback of:</p> <ul style="list-style-type: none"> (a) 6 metres from the primary road frontage; and (b) 3 metres from any secondary road frontage. 	n/a	Not applicable at reconfiguration stage.
	<p>AO3.2 Buildings and structures include a minimum setback of 2 metres from side and rear boundaries.</p>	n/a	Not applicable at reconfiguration stage.
Accommodation density			
<p>PO4 The density of Accommodation activities:</p> <ul style="list-style-type: none"> (a) contributes to housing choice and affordability; (b) respects the nature and density of surrounding land use; (c) does not cause amenity impacts beyond the reasonable expectation of accommodation density for the zone; and (d) is commensurate to the scale and frontage of the site. 	<p>AO4 Development provides a maximum density for Accommodation activities in compliance with Table 6.2.6.3B.</p>	n/a	Not applicable at reconfiguration stage.
Gross floor area			

Performance outcomes	Acceptable outcomes	Complies	Comments
<p>PO5 Buildings and structures occupy the site in a manner that:</p> <ul style="list-style-type: none"> (a) makes efficient use of land; (b) is consistent with the bulk and scale of surrounding buildings; and (c) appropriately balances built and natural features. 	<p>AO5 Gross floor area does not exceed 600m².</p>	n/a	Not applicable at reconfiguration stage.
For assessable development			
Building design			
<p>PO6 Building facades are appropriately designed to:</p> <ul style="list-style-type: none"> (a) include visual interest and architectural variation; (b) maintain and enhance the character of the surrounds; (c) provide opportunities for casual surveillance; (d) include a human scale; and (e) encourage occupation of outdoor space. 	<p>AO6 Buildings include habitable space, pedestrian entrances and recreation space facing the primary road frontage.</p>	n/a	Not applicable at reconfiguration stage.
<p>PO7 Development complements and integrates with the established built character of the Low density residential zone, having regard to:</p>	<p>AO7 No acceptable outcome is provided.</p>	n/a	Not applicable at reconfiguration stage.

Performance outcomes	Acceptable outcomes	Complies	Comments
(a) roof form and pitch; (b) eaves and awnings; (c) building materials, colours and textures; and (d) window and door size and location.			
Non-residential development			
PO8 Non-residential development is only located in new residential areas and: (a) is consistent with the scale of existing development; (b) does not detract from the amenity of nearby residential uses; (c) directly supports the day to day needs of the immediate residential community; and (d) does not impact on the orderly provision of non-residential development in other locations in the shire.	AO8 No acceptable outcome is provided.	n/a	Not applicable
Amenity			
PO9 Development must not detract from the amenity of the local area, having regard to: (a) noise; (b) hours of operation; (c) traffic; (d) advertising devices; (e) visual amenity; (f) privacy; (g) lighting; (h) odour; and (i) emissions.	AO9 No acceptable outcome is provided.	n/a	Not applicable
PO10	AO10	n/a	Not applicable

Performance outcomes	Acceptable outcomes	Complies	Comments
Development must take into account and seek to ameliorate any existing negative environmental impacts, having regard to: (a) noise; (b) hours of operation; (c) traffic; (d) advertising devices; (e) visual amenity; (f) privacy; (g) lighting; (h) odour; and (i) emissions.	No acceptable outcome is provided.		

Table 6.2.6.3B—Maximum densities for Accommodation activities

Use	Maximum density
Dual occupancy	1 dwelling per 400m ² of site area
Multiple dwelling	(a) 1 dwelling per 400m ² of site area; and (b) 1 bedroom per 200m ² of site area.
Residential care facility	1 dwelling or accommodation unit per 250m ² of site area.
Retirement facility	1 dwelling or accommodation unit per 400m ² of site area

8.2.3 Bushfire hazard overlay code

8.2.3.1 Application

- (1) This code applies to assessing development where:
- land the subject of development is located within a Bushfire hazard area and Potential impact buffer (100 metres) identified on the **Bushfire hazard overlay maps (OM-003a-o)**; and
 - it is identified in the assessment benchmarks for assessable development and requirements for accepted development column of an assessment table in Part 5 of the planning scheme.

Note—Natural hazards are appropriately reflected in Overlay Maps 3, 6 and 8 and are required to be mapped by State Government in response to Hazard and Safety State Interests.

8.2.3.2 Purpose

- (1) The purpose of the Bushfire hazard overlay code is to minimise the threat of bushfire to people and property.
- (2) The purpose of the code will be achieved through the following overall outcomes:
- Development in a Bushfire hazard area is compatible with the nature of the hazard;
 - The number of people and properties subject to bushfire hazards are minimised through appropriate building design and location;
 - Development does not result in a material increase in the extent, duration or severity of bushfire hazard; and
 - Appropriate infrastructure is available to emergency services in the event of a bushfire.

8.2.3.3 Criteria for assessment

Table 8.2.3.3—Bushfire hazard overlay code — For accepted development subject to requirements and assessable development

Performance outcomes	Acceptable outcomes	Complies	Comments
For accepted development subject to requirements and assessable development			
Water supply for fire-fighting purposes			
PO1 Development where within a 'Bushfire hazard area' and 'Potential impact buffer (100 metres)' identified on the Bushfire hazard overlay maps (OM-003a-o) maintains the safety of people and property by providing an adequate, accessible and reliable water supply for fire-fighting purposes which is safely located and has sufficient flow and pressure characteristics. Note— A Bushfire hazard management plan must be prepared by suitably qualified persons in seeking to demonstrate compliance with the Performance outcome.	Where within a 'Bushfire hazard area' and 'Potential impact buffer (100 metres)' identified on the Bushfire hazard overlay maps (OM-003a-o) AO1.1 Where in a reticulated water service area, the on-site water supply has flow and pressure characteristics of 10 litres a second at 200 kPa. OR	✓	Will be conditioned to comply.
	AO1.2 Where access to the reticulated water network is not available, a minimum on site water storage of 5,000 litres is provided that must comprise:	n/a	Not applicable.

Performance outcomes	Acceptable outcomes	Complies	Comments
	(a) a separate tank; or (b) a reserve section in the bottom part of the main water supply tank; or (c) a dam; or (d) a swimming pool. Note—Where a water tank is provided for fire-fighting purposes it is fitted with standard rural fire brigade fittings and the tank is provided with a hardstand area for heavy vehicles.		
For assessable development			
Land use			
PO2 Development within a 'Bushfire hazard area' and 'Potential impact buffer (100 metres)' identified on the Bushfire hazard overlay maps (OM-003a-o) is appropriate to the bushfire hazard risk having regard to the: (a) the bushfire risk compatibility of development; (b) the vulnerability of and safety risk to persons associated with the use; and (c) consequences of bushfire in regard to impacts on essential infrastructure, buildings and structures. Note— A Bushfire hazard management plan must be prepared by suitably qualified persons in seeking to demonstrate compliance with the Performance outcome.	AO2 All buildings, structures, infrastructure and facilities associated with the following uses are located outside any area of the site located within a 'Bushfire hazard area' and a 'Potential impact buffer (100 metres)' identified on the Bushfire hazard overlay maps (OM-003a-o) : (a) child care centre; or (b) community care centre; or (c) correctional facility; or (d) educational establishment; or (e) emergency services; or (f) hospital; or (g) residential care facility; or (h) retirement facility; or (i) rooming accommodation; or (j) shopping centre; or (k) tourist park; or (l) tourist attraction.	n/a	Not applicable.
Lot design			
PO3 Reconfiguring a lot within a 'Bushfire hazard area' and 'Potential impact buffer (100 metres)' identified on the Bushfire hazard overlay maps (OM-003a-o) minimises the potential adverse impacts of bushfire on the safety of people,	Where within a 'Bushfire hazard area' and 'Potential impact buffer (100 metres)' identified on the Bushfire hazard overlay maps (OM-003a-o) AO3.1 No new lots are created. OR	✓	Proposed vacant lot 2 will contain sufficient area to site a future dwelling outside any hazard area.

Performance outcomes	Acceptable outcomes	Complies	Comments
<p>property and the environment through lot design that:</p> <p>(a) is responsive to the nature and extent of bushfire risk; and</p> <p>(b) allows efficient emergency access to buildings for fire-fighting appliances.</p> <p>Note— A Bushfire hazard management plan must be prepared by suitably qualified persons in seeking to demonstrate compliance with the Performance outcome.</p>	<p>AO3.2</p> <p>All lots include a building envelope that achieves a radiant heat flux level of 29kW/m² at the perimeter of the building envelope.</p> <p>Note—Where a radiant heat flux of 29kW/m² is achieved and this relies on cleared or maintained land external to the land the subject of the development application it must be demonstrated that land external to the site will be maintained to a standard that does not exceed the level of bushfire hazard identified in a Bushfire hazard management plan.</p>		
Firebreaks and access			
<p>PO4</p> <p>In a 'Bushfire hazard area' and 'Potential impact buffer (100 metres)' identified on the Bushfire hazard overlay maps (OM-003a-o), vehicular access is designed to mitigate against bushfire hazard by:</p> <p>(a) ensuring adequate access for fire-fighting and other emergency vehicles;</p> <p>(b) ensuring adequate access for the evacuation of residents and emergency personnel in an emergency situation, including alternative safe access routes should access in one direction be blocked in the event of a fire; and</p> <p>(c) providing for the separation of developed areas and adjacent bushland.</p> <p>Note—Where it is not practicable to provide firebreaks in accordance with A04.2 Fire Maintenance Trails are provided in accordance with the following:</p> <p>i. located as close as possible to the boundaries of the lot and the adjoining hazardous vegetation;</p>	<p>AO4.1</p> <p>In a 'Bushfire hazard area' and 'Potential impact buffer (100 metres)' identified on the Bushfire hazard overlay maps (OM-003a-o), roads are designed and constructed:</p> <p>(a) with a maximum gradient of 12.5%;</p> <p>(b) to not use cul-de-sacs; and</p> <p>(c) a constructed road width and weather standard complying with Planning Scheme Policy 4 - FNQROC Regional Development Manual.</p>	✓	Complies.
	<p>AO4.2</p> <p>In a 'Bushfire hazard area' and 'Potential impact buffer (100 metres)' identified on the Bushfire hazard overlay maps (OM-003a-o), firebreaks are provided:</p> <p>(a) consisting of a perimeter road that separates lots from areas of bushfire hazard;</p> <p>(b) a minimum cleared width of 20 metre;</p> <p>(c) a maximum gradient of 12.5%; and</p> <p>(d) a constructed road width and weather standard complying with Planning Scheme Policy 4 -</p>	n/a	Not applicable.

Performance outcomes	Acceptable outcomes	Complies	Comments
ii. the minimum cleared width not less than 6 metres; iii. the formed width is not less than 2.5 metres; iv. the formed gradient is not greater than 15%; v. vehicular access is provided at both ends; vi. passing bays and turning areas are provided for fire-fighting appliances located on public land. Note— A Bushfire hazard management plan must be prepared by suitably qualified persons in seeking to demonstrate compliance with the Performance outcome.	FNQROC Regional Development Manual.		
Hazardous materials			
PO5 Public safety and the environment are not adversely affected by the detrimental impacts of bushfire of hazardous materials manufactured or stored in bulk. Note— A Bushfire hazard management plan must be prepared by suitably qualified persons in seeking to demonstrate compliance with the Performance outcome.	AO5 The processing or storage of dangerous goods or hazardous materials is not undertaken in a 'Bushfire hazard area' and a 'Potential impact buffer (100 metres)' identified on the Bushfire hazard overlay maps (OM-003a-o) .	n/a	Not applicable.
Landscaping			
PO6 Landscaping within a 'Bushfire hazard area' and a 'Potential impact buffer (100 metres)' identified on the Bushfire hazard overlay maps (OM-003a-o) does not result in a material increase in the extent, duration or severity of bushfire hazard having regard to: (a) fire ecology; (b) slope of site; and (c) height and mix of plant species. Note—Frost hollows and the associated grass kill facilitates a rapid curing of fuel and exacerbates bushfire hazard.	AO6 No acceptable outcome is provided.	n/a	Not applicable.

Performance outcomes	Acceptable outcomes	Complies	Comments
Note— A Bushfire hazard management plan must be prepared by suitably qualified persons in seeking to demonstrate compliance with the Performance outcome.			
Infrastructure			
<p>PO7 Infrastructure services located in a 'Bushfire hazard area' and a 'Potential impact buffer (100 metres)' identified on the Bushfire hazard overlay maps (OM-003a-o) are protected from damage or destruction in the event of a bushfire.</p> <p>Note— A Bushfire hazard management plan must be prepared by suitably qualified persons in seeking to demonstrate compliance with the Performance outcome.</p>	<p>AO7 The following infrastructure services are located below ground:</p> <ul style="list-style-type: none"> (a) water supply; (b) sewer; (c) electricity; (d) gas; and (e) telecommunications 	n/a	Not applicable. Services locations are outside hazard area.
Private driveways			
<p>PO8 All premises located in a 'Bushfire hazard area' and a 'Potential impact buffer (100 metres)' identified on the Bushfire hazard overlay maps (OM-003a-o) are provided with vehicular access that enables safe evacuation for occupants and easy access by fire-fighting appliances.</p> <p>Note— A Bushfire hazard management plan must be prepared by suitably qualified persons in seeking to demonstrate compliance with the Performance outcome.</p>	<p>AO8 Private driveways:</p> <ul style="list-style-type: none"> (a) do not exceed a length of 60 metres from the street frontage; (b) do not exceed a gradient of 12.5%; (c) have a minimum width of 3.5 metres; (d) have a minimum vertical clearance of 4.8 metres; (e) accommodate turning areas for fire-fighting appliances in accordance with the Queensland Fire and Emergency Services' Fire Hydrant and Vehicle Access Guidelines; and (f) serve no more than three dwellings or buildings. 	n/a	Not applicable.

8.2.6 Flood hazard overlay code

8.2.6.1 Application

- (1) This code applies to assessing development where:
 - (a) land the subject of development is located within a Flood hazard area identified on the **Flood hazard overlay maps (OM-006a-o)**; and
 - (b) it is identified in the assessment benchmarks for assessable development and requirements for accepted development column of an assessment table in Part 5 of the planning scheme.

Note—Natural hazards are appropriately reflected in Overlay Maps 3, 6 and 8 and are required to be mapped by State Government in response to Hazard and Safety State Interests.

Note—where new information, including flood studies or flood modelling supersedes the Flood hazard overlay maps (OM-006a-o) Council may have regard to this new information in the application of the Flood hazard overlay code in the interests of the precautionary principle and the safety of persons and property.

8.2.6.2 Purpose

- (1) The purpose of the Flood hazard overlay code is to manage development outcomes in flood hazard areas identified on the **Flood hazard overlay maps (OM-006a-o)** so that risk to life, property, community and the environment during flood events is minimised, and to ensure that development does not increase the potential for flood damage on site or to other property.
- (2) The purpose of the code will be achieved through the following overall outcomes:
 - (a) Development in the 'Extreme flood hazard area':
 - i. maintains and enhances the hydrological function of the land;
 - ii. does not involve filling (earthworks) or changes to existing landform or drainage lines that results in a loss of the flood conveyance and flood storage capacity of the land;
 - iii. is limited to:
 - A. flood proofed Sport and recreation activities;
 - B. Rural activities where for Animal husbandry, Cropping or Permanent plantation;
 - C. flood proofed Utility installations, Substations or Major electricity infrastructure;
 - D. conservation and natural area management; and
 - E. replacement of existing lawful development, including Accommodation activities where habitable rooms are elevated above the defined flood level and include freeboard;Where there is no increase to the number of persons at risk of flood and where development reduces existing or potential risks to life and property.
 - (b) Development in the 'High flood hazard area':
 - i. maintains the hydrological function of the land;
 - ii. does not involve filling (earthworks) or changes to the existing landform or drainage lines that results in a loss of the flood conveyance and flood storage capacity of the land;
 - iii. is limited to:
 - A. flood proofed Sport and recreation activities and Club uses;
 - B. Non-resident workforce accommodation, Relocatable home park, Resort complex, Rooming accommodation, Short term accommodation and

- Tourist park uses where these uses comprise permanent on-site management and a flood evacuation management plan ensures the health and safety of persons during a flood event;
- C. a Dwelling house only where the lot existed or had a lawful reconfiguring a lot approval at the commencement of the planning scheme and the land is included in a Residential zone or the Centre zone or where for minor intensification of existing Dwelling houses;
- D. Rural activities where for Animal husbandry, Cropping or Permanent plantation;
- E. Industrial activities and Commercial activities where it is accepted development that flood damage is incurred as an operational cost and where flood sensitive elements of the development or use are elevated above the defined flood level, including freeboard;
- F. flood proofed Utility installations, Substations or Major electricity infrastructure;
- G. conservation and natural area management; and
- H. replacement of existing lawful development;

where there is no increase to the number of persons at risk of flood and where development reduces existing or potential risks to life and property.

- iv. protects surrounding land and land uses from increased flood hazard impacts;
 - v. elevates habitable rooms for all accommodation activities (including where for minor building work) above the defined flood level, including freeboard.
- (c) Development in the 'Significant flood hazard area':
- i. minimises risk to life and property from flood events;
 - ii. involves changes to the existing landform and drainage lines in this area only where detrimental impacts to the flood hazard risk of surrounding areas is avoided;
 - iii. is limited to:
 - A. Sport and recreation activities;
 - B. Industrial activities and Commercial activities where it is accepted development that flood damage is incurred as an operational cost and where flood sensitive elements of the development or use are elevated above the defined flood level, including freeboard;
 - C. Rural activities;
 - D. Accommodation activities, excluding Residential care facility and Retirement facility;
 - E. flood proofed Community activities, excluding Child care centre, Hospital and Community use where a flood emergency evacuation plan ensures the safety of people during a flood event;
 - F. flood proofed Utility installations, Substations or Major electricity infrastructure;
 - G. conservation and natural area management;
 - iv. locates habitable rooms for all accommodation activities above the defined flood level, including freeboard; and
 - v. locates the minimum floor level for all buildings other than accommodation activities, industrial activities and business activities above the defined flood level.

- (d) Development in the 'Low flood hazard area':
 - i. minimises risk to life and property from flood events;
 - ii. locates habitable rooms for all Accommodation activities above the defined flood level, including freeboard; and
 - iii. locates the minimum floor level for all buildings other than Accommodation activities above the defined flood level, including freeboard.

- (e) Development in the 'Potential flood hazard area':
 - i. maintains the safety of people on the development site from flood events and minimises the potential damage from flooding to property;
 - ii. does not result in adverse impacts on people's safety, the environment or the capacity to use land within the floodplain;
 - iii. locates habitable rooms for all Accommodation activities above a 1% Annual Exceedance Probability (AEP), including freeboard; and
 - iv. locates the minimum floor level for all building work other than Accommodation activities above the 1% AEP flood level, including freeboard.

8.2.6.3 Criteria for assessment

Table 8.2.6.3A - Flood hazard overlay code - For accepted development subject to requirements and assessable development

Performance outcomes	Acceptable outcomes	Complies	Comments
For accepted development subject to requirements and assessable development			
All flood hazard areas			
PO1 Development prevents the carriage or dispersal of contaminants or pollutants into the receiving environment.	AO1 The processing or storage of dangerous goods or hazardous materials is: (a) not undertaken in a flood hazard area identified on the Flood hazard overlay maps (OM-006a-o) ; or (b) is located above the defined flood level plus 0.3 metre freeboard.	n/a	Not applicable.
PO2 Essential community infrastructure is able to function effectively during and immediately after flood events.	AO2 Design levels for buildings must comply with the flood immunity standards specified in Table 8.2.6.3.B and Table 8.2.6.3.C where within a flood hazard area identified on the Flood hazard overlay maps (OM-006a-o) .	n/a	Not applicable.
Extreme flood hazard area			

Performance outcomes	Acceptable outcomes	Complies	Comments
<p>PO3 Development, where involving a Material change of use within an 'Extreme flood hazard area' on the Flood hazard overlay maps (OM006a-o), is appropriate to the flood hazard risk having regard to the:</p> <p>(a) likelihood and frequency of flooding;</p> <p>(b) flood risk acceptability of development;</p> <p>(c) vulnerability of and safety risk to persons associated with the use;</p> <p>(d) associated consequences of flooding in regard to impacts on proposed buildings, structures, and supporting infrastructure; and</p> <p>(e) associated consequences of flooding in respect to undue burden on disaster response recovery capacity and capabilities.</p>	<p>AO3.1 Uses within the following activity groups are not located within an 'Extreme flood hazard area identified' on the Flood hazard overlay maps (OM006a-o):</p> <p>(a) Accommodation activities;</p> <p>(b) Commercial activities;</p> <p>(c) Community activities except where for a Club with a maximum gross floor area of 100m²;</p> <p>(d) Industrial activities;</p> <p>(e) Rural activities, except where for Animal husbandry, Cropping, or Permanent plantation.</p>	n/a	Not applicable.
	<p>AO3.2 Sport and recreation activities are not located within an 'Extreme flood hazard area' identified on the Flood hazard overlay maps (OM006a-o) except where for:</p> <p>(a) Environment facility;</p> <p>(b) Park; or</p> <p>(c) Outdoor sport and recreation (excluding the provision of ancillary facilities or amenities conducted within a building).</p>	n/a	Not applicable.

Performance outcomes	Acceptable outcomes	Complies	Comments
<p>PO4 Development is located and designed to:</p> <p>(a) maintain and enhance the flood conveyance capacity of the premises;</p> <p>(b) not increase the number of people calculated to be at risk from flooding;</p> <p>(c) not increase the flood impact on adjoining premises;</p> <p>(d) ensure the safety of all persons by ensuring that development levels are set above the defined flood level;</p> <p>(e) reduce property damage; and</p> <p>(f) provide flood immune access to buildings.</p> <p>Note—Buildings may be constructed from flood resistant, waterproof materials below the defined flood level where certified by a qualified structural engineer to be flood proof (including the ability to withstand damage from floodwater and debris) and where an alternative outcome to AO4.1-AO4.4 is also demonstrated.</p> <p>Note—In the event that a lawful building or structure is destroyed by flood or other event the building may be replaced in situ where there is no increase in:</p> <p>i. gross floor area; or</p> <p>ii. the number of dwellings or bedrooms on the premises.</p>	<p>AO4.1 Buildings, including extensions to existing buildings, are:</p> <p>(a) not located within an 'Extreme flood hazard area' identified on the Flood hazard overlay maps (OM006a-o); or</p> <p>(b) elevated above the defined flood level, with 0.3 metres freeboard from the defined flood level provided for habitable rooms within a dwelling.</p>	n/a	Not applicable.
	<p>AO4.2 All building work must be high set and retains the flood storage and conveyance capacity of the premises.</p> <p>Note—Building work must be certified by a qualified structural engineer to be flood proof including the ability to withstand damage from floodwater and debris.</p>	n/a	Not applicable.
	<p>AO4.3 New buildings are provided with flood free pedestrian and vehicle evacuation access between the building and a flood safe accessible road.</p> <p>Note—A flood safe accessible road includes a road where identified as outside a flood hazard area or within a 'Low flood hazard area', 'Potential flood hazard area' or 'Significant flood hazard area' on the Flood hazard overlay maps (OM006a-o).</p>	n/a	Not applicable.
	<p>AO4.4 Development does not increase the number of lots in the 'Extreme flood hazard area' identified on the Flood hazard overlay maps (OM006a-o) except where for the purposes of public open space.</p>	n/a	Not applicable.

Performance outcomes	Acceptable outcomes	Complies	Comments
<p>PO5 Development involving earthworks in a Flood hazard area below the defined flood level must protect life and property on premises and off premises through maintaining:</p> <ul style="list-style-type: none"> (a) flood storage capacity of land; (b) flood conveyance function of land; (c) flood and drainage channels; (d) overland flow paths; and (e) flood warning times. 	<p>AO5 Filling above ground level is not undertaken in the 'Extreme flood hazard area' identified on the Flood hazard overlay maps (OM006a-o).</p>	n/a	Not applicable.
High flood hazard area			
<p>PO6 Development, where for a Material change of use within a 'High flood hazard area' identified on the Flood hazard overlay maps (OM-006a-o), is appropriate to the flood hazard risk having regard to the:</p> <ul style="list-style-type: none"> (a) likelihood and frequency of flooding; (b) flood risk acceptability of development; (c) vulnerability of and safety risk to persons associated with the use; (d) associated consequences of flooding in regard to impacts on proposed buildings, structures and supporting infrastructure; and 	<p>AO6.1 Uses within the following activity groups are not located within a 'High flood hazard area' identified on the Flood hazard overlay maps (OM006a-o):</p> <ul style="list-style-type: none"> (a) Accommodation activities, except where for Dwelling house and only where the lot existed or had a lawful reconfiguring a lot approval at the commencement of the planning scheme and the land is included in a Residential zone or the Centre zone; (b) Community activities except where for a Club with a maximum gross floor area of 100m²; (c) Rural activities, except where for Animal husbandry, Cropping or Permanent plantation. 	n/a	Not applicable.

Performance outcomes	Acceptable outcomes	Complies	Comments
<p>(e) associated consequences of flooding in respect to undue burden on disaster response recovery capacity and capabilities.</p>	<p>AO6.2 Sport and recreation activities are not located within a 'High flood hazard area' identified on the Flood hazard overlay maps (OM006a-o) except where for: (a) Environment facility; (b) Park; or (c) Outdoor sport and recreation (excluding the provision of ancillary facilities or amenities conducted within a building).</p>	<p>n/a</p>	<p>Not applicable.</p>
<p>PO7 Development is located and designed to: (a) maintain hydrological function of the premises; (b) not increase the number of people calculated to be at risk from flooding; (c) minimises the flood impact on adjoining premises; (d) ensure the safety of all persons by ensuring that an appropriate</p>	<p>AO7.1 Buildings, including extensions to existing buildings are: (a) not located within the 'High flood hazard area' identified on the Flood hazard overlay maps (OM006a-o); or (b) elevated above the defined flood level, with 0.3 metres freeboard from the defined flood level provided for habitable rooms within a dwelling. OR</p>	<p>n/a</p>	<p>Not applicable.</p>

Performance outcomes	Acceptable outcomes	Complies	Comments
<p>proportion of buildings are set above the defined flood level;</p> <p>(e) reduce the carriage of debris in flood waters;</p> <p>(f) reduce property damage; and</p> <p>(g) provide flood immune access to buildings.</p> <p>Note—Buildings may be constructed from flood resistant, waterproof materials below the defined flood level where certified by a qualified structural engineer to be flood proof (including the ability to withstand damage from floodwater and debris) and where an alternative outcome to AO8.1-AO8.9 is also demonstrated.</p>	<p>AO7.2</p> <p>Buildings used for Commercial activities or Industrial activities include a minimum floor level of 0.3 metres above the defined flood where for the following components of the use:</p> <p>(a) administrative areas; or</p> <p>(b) services, plant and equipment associated with the building.</p> <p>Note—AO8.2 accepts that the cost of flood impact is an operational cost of the Commercial activity or Industrial activity.</p> <p>Note—Building work must be certified by a qualified structural engineer to be flood proof including the ability to withstand damage from floodwater and debris.</p>	n/a	Not applicable.
	<p>AO7.3</p> <p>All building work below the defined flood level must be high set (comprising pier and beam construction) and retains the flood storage and conveyance capacity of the premises.</p>		
	<p>AO7.4</p> <p>New buildings are provided with flood free pedestrian and vehicle evacuation access between the building and a flood safe accessible road.</p> <p>Note—A flood safe accessible road includes a road where identified as outside a flood hazard area or within a 'Low flood hazard area', 'Potential flood hazard area' or 'Significant flood hazard area' on the Flood hazard overlay maps (OM006a-o).</p>	n/a	Not applicable.
	<p>AO7.5</p> <p>New temporary, relocatable or impermanent buildings and structures are to be anchored with the ability to withstand transportation by floodwater.</p> <p>Note—Building work must be certified by a qualified structural engineer.</p>	n/a	Not applicable.

Performance outcomes	Acceptable outcomes	Complies	Comments
	AO7.6 Dwellings do not exceed four bedrooms.	n/a	Not applicable.
	AO7.7 Building work on an existing dwelling does not comprise additional bedrooms.	n/a	Not applicable.
	AO7.8 Building work on an existing dwelling is limited to a maximum increase of 20 percent of the lawfully approved gross floor area of the existing dwelling.	n/a	Not applicable.
	AO7.9 Development does not increase the number of lots in the 'High flood hazard area; as identified on the Flood hazard overlay maps (OM006a-o) except where for the purposes of public open space.	n/a	Not applicable.
PO8 Development involving earthworks in a Flood hazard area below the defined flood level must protect life and property on premises and off premises through maintaining: (a) flood storage capacity of land; (b) flood conveyance function of land; (c) flood and drainage channels; (d) overland flow paths; and (e) flood warning times.	AO8 Filling above ground level is not undertaken in the 'High flood hazard area' identified on the Flood hazard overlay maps (OM006a-o) .	n/a	Not applicable.
Significant flood hazard area			

Performance outcomes	Acceptable outcomes	Complies	Comments
<p>PO9 Development, involving a Material change of use, within a 'Significant flood hazard area' on the Flood hazard overlay maps (OM006a-o) is appropriate to the flood hazard risk having regard to the:</p> <p>(a) likelihood and frequency of flooding;</p> <p>(b) flood risk acceptability of development;</p> <p>(c) vulnerability of and safety risk to persons associated with the use;</p> <p>(d) associated consequences of flooding in regard to impacts on proposed buildings, structures and supporting infrastructure; and</p> <p>(e) associated consequences of flooding in respect to undue burden on disaster response recovery capacity and capabilities.</p>	<p>AO9 The following uses are not located within a 'Significant flood hazard area' identified on the Flood hazard overlay maps (OM006a-o):</p> <p>(a) Residential care facility;</p> <p>(b) Retirement facility;</p> <p>(c) Child care centre;</p> <p>(d) Hospital; or</p> <p>(e) Community use.</p>	<p>n/a</p>	<p>Not applicable.</p>
<p>Significant flood hazard area, Low flood hazard area or Potential flood hazard area</p>			

Performance outcomes	Acceptable outcomes	Complies	Comments
<p>PO10 Development, where involving a Material change of use or Building work, is located and designed to:</p> <p>(a) maintain hydrological function of the premises;</p> <p>(b) not increase the number of people calculated to be at risk from flooding;</p> <p>(c) minimises the flood impact on adjoining premises;</p> <p>(d) ensure the safety of all persons by ensuring that a proportion of buildings are set above the defined flood level;</p> <p>(e) reduce the carriage of debris in flood waters;</p> <p>(f) reduce property damage; and</p> <p>(g) provide flood immune access to buildings.</p> <p>Note—Where the development is located in a 'Potential flood hazard area' identified on the Flood hazard overlay maps (OM006a-o) and there is no defined flood level a hydraulic (flood hazard assessment) report prepared by a RPEQ is required in substantiation of an alternative outcome is required or the defined flood level from the adjacent representative hazard zone is used.</p>	<p>AO10.1 Buildings, including extensions to existing buildings are:</p> <p>(a) elevated above the defined flood level; and</p> <p>(b) the defined flood event does not exceed a depth of 600mm; and</p> <p>(c) elevated above the defined flood level plus 0.3 metres freeboard where for habitable rooms within a dwelling.</p> <p>OR</p>	n/a	Not applicable - The site is within the potential flood hazard area, however this is considered to be a mapping error. The site, like most of the Mount Molloy Township is located on a hill and is unlikely to flood.
	<p>AO10.2 Buildings used for Commercial activities or Industrial activities include a minimum floor level of 0.3 metres above the defined flood where for the following components of the use:</p> <p>(a) administrative areas; or</p> <p>(b) services, plant and equipment associated with the building.</p> <p>Note—AO10.2 accepts that the cost of flood impact is an operational cost of the Commercial activity or Industrial activity.</p> <p>Note—Building work must be certified by a qualified structural engineer to be flood proof including the ability to withstand damage from floodwater and debris.</p>	n/a	Not applicable.
	<p>AO10.3 All building work below the defined flood level must be high set (comprising pier and beam construction) and retains the flood storage and conveyance capacity of the premises.</p> <p>Note—Building work must be certified by a qualified structural engineer to be flood proof including the ability to withstand damage from floodwater and debris.</p>	n/a	Not applicable.

Performance outcomes	Acceptable outcomes	Complies	Comments
<p>PO11 Development involving earthworks in a Flood hazard area below the defined flood level must protect life and property on premises and off premises through maintaining:</p> <ul style="list-style-type: none"> (a) flood storage capacity of land; (b) flood conveyance function of land; (c) flood and drainage channels; (d) overland flow paths; and (e) flood warning times. 	<p>AO11 Development does not involve in excess of 50m³ of fill above ground level per 1,000m² of site area.</p>	<p>n/a</p>	<p>Not applicable.</p>
<p>For assessable development</p>			
<p>Where for Material change of use or Reconfiguring a lot that involves new gross floor area or increases the number of persons living, working or residing in the Extreme flood hazard area, High flood hazard area or Significant flood hazard area other than a Dwelling house.</p>			

Performance outcomes	Acceptable outcomes	Complies	Comments
<p>PO12 Flood risk management minimises the impact on property and appropriately protects the health and safety of persons at risk of Extreme, high or significant flood hazard, and:</p> <ul style="list-style-type: none"> (a) indicates the position and path of all safe evacuation routes off the site; and (b) if the site contains or is within 100 metres of a flood hazard area, hazard warning signage and depth indicators are provided at key hazard points, such as at floodway crossings. <p>Note—A Material change of use or Reconfiguring a lot that involves new gross floor area or increases the number of persons living, working or residing in the 'Extreme flood hazard area' identified on the Flood hazard overlay map (OM006a-o) is supported by a Flood Emergency Evacuation Plan prepared by suitably qualified persons having regard to Floodplain Management in Australia: Best Practice Principles and Guidelines (2000), prepared by Standing Committee on Agriculture and Resource Management (SCARM), CSIRO.</p>	<p>AO12 No acceptable outcome is provided.</p>	<p>n/a</p>	<p>Not applicable.</p>

Performance outcomes	Acceptable outcomes	Complies	Comments
Significant flood hazard area, Low flood hazard area or Potential flood hazard area			
<p>PO13 Development, where involving Reconfiguring a lot, is located and designed to:</p> <ul style="list-style-type: none"> (a) maintain hydrological function of the premises; (b) not increase the number of people calculated to be at risk from flooding; (c) minimises the flood impact on adjoining premises; (d) ensure the safety of all persons by ensuring that a proportion of buildings are set above the defined flood level; (e) reduce the carriage of debris in flood waters; (f) reduce property damage; and (g) provide flood immune access to buildings. <p>Note—Where the development is located in a 'Potential flood hazard area' identified on the Flood hazard overlay maps (OM006a-o) and there is no defined flood level a hydraulic (flood hazard assessment) report prepared by a RPEQ is required in substantiation of an alternative outcome is required or the defined flood level from the adjacent representative hazard zone is used.</p>	<p>AO13 No acceptable outcome is provided.</p>	n/a	Not applicable.

Table 8.2.6.3B Flood immunity levels

Development Category	Minimum design floor or pavement levels (mAHD)
Category A	1% AEP + 0.5 metres
Category B	1% AEP + 0.3 metres
Category C	1% AEP

Category D	1% AEP
Category E	2% AEP

Note—Refer Table 8.2.6.3D for building classification by Category.

Table 8.2.6.3C Community infrastructure flood immunity levels

Development Type	Minimum design floor or pavement levels (mAHD)
Emergency services, where for:	
• Emergency Shelters	0.1% AEP
• Police facilities	0.5% AEP
• Other Emergency services	0.1% AEP + 0.5 metres
Hospital	0.1% AEP+ 0.5 metres
Community use (where for the storage of valuable records or items of historic or cultural significance including libraries and museums)	0.5% AEP
Special industry (where for power station)	0.5% AEP
Substations	0.5% AEP
Utility installation (where for a sewage treatment plant)	Defined flood level
Utility installation (where for a water treatment plant)	0.5% AEP
Utility installation (other)	Alternative outcome required.
Air services	Alternative outcome required.

Table 8.2.6.3D Development category

Building Code of Australia Building classification ⁽¹⁾	Development types and design levels, assigned design floor or pavement levels	Category – refer to Table 8.2.6.3B for flood planning levels
Class 1–4	Habitable room	Category A
	Non-habitable room including patio and courtyard	Category B
	Non-habitable part of a Class 2 or Class 3 building excluding the essential services ⁽²⁾ control room	Category B
	Parking located in the building undercroft of a multiple dwelling	Category C
	Carport, unroofed car park; vehicular manoeuvring area	Category D
	Essential electrical services ⁽²⁾ of a Class 2 or Class 3 building only	Category A
	Basement parking entry	Category C + 0.3 metres
Class 5, Class 6, or Class 8	Building floor level	Category C
	Garage or car park located in the building undercroft	Category C

Building Code of Australia Building classification ⁽¹⁾	Development types and design levels, assigned design floor or pavement levels	Category – refer to Table 8.2.6.3B for flood planning levels
	Carport or unroofed car park	Category D
	Vehicular access and manoeuvring areas	Category D
	Basement parking entry	Category C
	Essential electrical services ⁽²⁾	Class 8 – Category Class 5 & 6 – Category A
Class 7a	Refer to the relevant building class specified in this table	
Class 7b	Building floor level	Category C
	Vehicular access and manoeuvring area	Category D
	Essential electrical services ⁽²⁾	Category C
Class 9	Building floor level	Category A
	Building floor level for habitable rooms in Class 9a or 9c where for a Residential care facility	0.2% AEP flood
	Building floor level for habitable rooms in Class 9b where involving children, such as a child care centre	0.2% AEP flood
	Garage or car park located in the building undercroft	Category C
	Carport or unroofed car park	Category D
	Vehicular access and manoeuvring areas	Category D
	Essential electrical services ⁽²⁾	Category A
Class 10a	Car parking facility	Refer to the relevant building class specified in this table
	Shed or the like	Category D
Class 10b	Swimming pool	Category E
	Associated mechanical and electrical pool equipment	Category C
	Other structures	Flood planning levels do not apply

⁽¹⁾ Refer to the Building Code of Australia for definitions of building classifications.

⁽²⁾ Essential electrical services include any area or room used for fire control panel, telephone PABX, sensitive substation equipment including transformers, low voltage switch gear, high voltage switch gear, battery chargers, protection control and communication equipment, low voltage cables, high voltage cables, and lift or pump controls.

8.2.8 Hill and slope overlay code

8.2.8.1 Application

- (1) This code applies to assessing development where:
 - (a) land the subject of development is located within a 'Hill and slope area' identified on the **Hill and slope overlay maps (OM-008a-o)**; and
 - (b) it is identified in the assessment benchmarks for assessable development and requirements for accepted development column of an assessment table in Part 5 of the planning scheme.

Note—Natural hazards are appropriately reflected in Overlay Maps 3, 6 and 8 and are required to be mapped by State Government in response to Hazard and Safety State Interests.

8.2.8.2 Purpose

- (1) The purpose of the Hill and slope overlay code is to ensure the ongoing stability of land within a hill and slope area to prevent risk to people or property.
- (2) The purpose of the code will be achieved through the following overall outcomes:
 - (a) Development is located to avoid sloping land where practical; and
 - (b) Development on sloping land maintains slope stability and does not increase the potential for erosion or landslide.

8.2.8.3 Criteria for assessment

Table 8.2.8.3 – Hill and slope overlay code - For assessable development

Performance outcomes	Acceptable outcomes	Complies	Comment
For assessable development			
Slope stability			

Performance outcomes	Acceptable outcomes	Complies	Comment
<p>PO1 Where clearing of vegetation, building work or filling or excavation occurs on land within a 'Hill and slope area' identified on the Hill and slope overlay maps (OM-008a-o), a geotechnical report is prepared in accordance with Planning Scheme Policy 5 - Preparation of Geotechnical Reports that demonstrates:</p> <p>(a) the long term stability of the development site;</p> <p>(b) development will not be adversely affected by landslide activity originating on sloping land above the development site; and</p> <p>(c) development will not adversely affect other property outside the development site through landslide activity or alterations to surface or groundwater.</p>	<p>AO1 No acceptable outcome is provided.</p>	✓	Will be conditioned to comply for any future clearing, earthworks or building works.
<p>PO2 Development is designed and located to ensure that the use can appropriately function in the 'Hill and slope area' identified on the Hill and slope overlay maps (OM-008a-o) having regard to:</p> <p>(a) the nature and scale of the proposed use;</p> <p>(b) the gradient of the land;</p> <p>(c) the extent of land disturbance proposed;</p>	<p>AO2.1 Development for a Child care centre or Educational establishment is not located on land in a 'Hill and slope area' identified on the Hill and slope overlay maps (OM-008a-o).</p>	n/a	Not applicable.
	<p>AO2.2 Development is not located on land with a gradient of greater than 25%.</p>	✓	Complies.

Performance outcomes	Acceptable outcomes	Complies	Comment
<p>(d) stormwater discharge and its potential for erosion.</p>	<p>AO2.3 No lot less than 2,000m² is created in a 'Hill and slope area' identified on the Hill and slope overlay maps (OM-008a-o).</p> <p>Note – Where a minimum lot size of less than 2,000m² applies under the Reconfiguring a lot code, the lot size requirements of the Hill and slope overlay code prevail.</p>	<p>✓</p>	<p>Lot 2, despite being less than 2,000m² in area, contains adequate space outside the hill and slope area for the future siting of a dwelling.</p>
<p>Community infrastructure and essential services</p>			
<p>PO3 Community infrastructure and essential services located within a 'Hill and slope area' identified on the Hill and slope overlay maps (OM-008a-o) are able to function effectively during and immediately after landslide events.</p>	<p>AO3 No acceptable outcome is provided.</p>	<p>n/a</p>	<p>Not applicable.</p>

9.4.2 Landscaping code

9.4.2.1 Application

This code applies where it is identified in the assessment benchmarks for assessable development and requirements for accepted development column of an assessment table in Part 5 of the planning scheme.

9.4.2.2 Purpose

- (1) The purpose of the Landscaping code is to ensure all development is landscaped to a standard that:
 - (a) complements the scale and appearance of the development;
 - (b) protects and enhances the amenity and environmental values of the site;
 - (c) complements and enhances the streetscape and local landscape character; and
 - (d) ensures effective buffering of incompatible land uses to protect local amenity.

- (2) The purpose of the code will be achieved through the following overall outcomes:
 - (a) Landscaping is a functional part of development design and is commensurate with the intended use;
 - (b) Landscaping accommodates the retention of existing significant on site vegetation where appropriate and practical;
 - (c) Landscaping treatments complement the scale, appearance and function of the development;
 - (d) Landscaping contributes to an attractive streetscape;
 - (e) Landscaping enhances the amenity and character of the local area;
 - (f) Landscaping enhances natural environmental values of the site and the locality;
 - (g) Landscaping provides effective screening both on site, if required, and between incompatible land uses;
 - (h) Landscaping provides shade in appropriate circumstances;
 - (i) Landscape design enhances personal safety and reduces the potential for crime and vandalism; and
 - (j) Intensive land uses incorporate vegetated buffers to provide effective screening of buildings, structures and machinery associated with the use.

9.4.2.3 Criteria for assessment

Table 9.4.2.3A—Landscaping code - For accepted development subject to requirements and assessable development

Performance outcomes	Acceptable outcomes	Complies	Comments
For accepted development subject to requirements and assessable development			
<p>PO1 Development, other than in the Rural zone, includes landscaping that:</p> <ul style="list-style-type: none"> (a) contributes to the landscape character of the Shire; (b) compliments the character of the immediate surrounds; (c) provides an appropriate balance between built and natural elements; and (d) provides a source of visual interest. 	<p>AO1 Development, other than in the Rural zone, provides:</p> <ul style="list-style-type: none"> (a) a minimum of 10% of the site as landscaping; (b) planting in accordance with Planning Scheme Policy 6 - Landscaping and preferred plant species; (c) for the integration of retained significant vegetation into landscaping areas; (d) on-street landscaping works in accordance with the Design Guidelines set out in Section D9 Landscaping, of the Planning Scheme Policy 4 - FNQROC Regional Development Manual. <p>Note—Where development exceeds a site cover of 90%, areas of landscaping may be provided above ground level to achieve a total supply of landscaping equivalent to 10% of the site area.</p>	n/a	Not applicable - the proposed development is for a 1 into 2 Lot subdivision in a urban area. Landscaping is not considered necessary in this instance.

Performance outcomes	Acceptable outcomes	Complies	Comments
<p>PO2 Development, other than in the Rural zone, includes landscaping along site frontages that:</p> <ul style="list-style-type: none"> (a) creates an attractive streetscape; (b) compliments the character of the immediate surrounds; (c) assists to break up and soften elements of built form; (d) screen areas of limited visual interest or servicing; (e) provide shade for pedestrians; and (f) includes a range and variety of planting. 	<p>AO2 Development, other than in the Rural zone, includes a landscape strip along any site frontage:</p> <ul style="list-style-type: none"> (a) with a minimum width of 2 metres where adjoining a car parking area; (b) with a minimum width of 1.5 metres in all other locations; and (c) in accordance with Planning Scheme Policy 6 - Landscaping and preferred plant species. <p>Note—Where development is setback from a frontage less than 1.5 metres, the setback area is provided as a landscape strip</p>	n/a	Not applicable - refer to comment for AO1.
<p>PO3 Development includes landscaping and fencing along side and rear boundaries that:</p> <ul style="list-style-type: none"> (a) screens and buffer land uses; (b) assists to break up and soften elements of built form; (c) screens areas of limited visual interest; (d) preserves the amenity of sensitive land uses; and (e) includes a range and variety of planting. 	<p>AO3.1 Development provides landscape treatments along side and rear boundaries in accordance with Table 9.4.2.3B.</p>	n/a	Not applicable - refer to comment for AO1.
	<p>AO3.2 Shrubs and trees provided in landscape strips along side and rear boundaries:</p> <ul style="list-style-type: none"> (a) are planted at a maximum spacing of 1 metre; (b) will grow to a height of at least 2 metres; (c) will grow to form a screen of no less than 2 metres in height; and (d) are mulched to a minimum depth of 0.1 metres with organic mulch. 	n/a	Not applicable - refer to comment for AO1.

Performance outcomes	Acceptable outcomes	Complies	Comments
	<p>AO3.3 Any landscape strip provided along a side or rear boundary is designed in accordance with Planning Scheme Policy 6 - Landscaping and preferred plant species.</p>	n/a	Not applicable - refer to comment for AO1.
<p>PO4 Car parking areas are improved with a variety of landscaping that:</p> <ul style="list-style-type: none"> (a) provides visual interest; (b) provides a source of shade for pedestrians; (c) assists to break up and soften elements; and (d) improves legibility. 	<p>AO4.1 Landscaping is provided in car parking areas which provides:</p> <ul style="list-style-type: none"> (a) a minimum of 1 shade tree for every 4 parking spaces, or part thereof, where the car parking area includes 12 or more spaces; (b) a minimum of 1 shade tree for every 6 parking spaces, or part thereof, otherwise; and (c) where involving a car parking area in excess of 500m²: <ul style="list-style-type: none"> (i) shade structures are provided for 50% of parking spaces; and (ii) a minimum of 10% of the parking area as landscaping. <p>Note—Where a shade structure is provided over part of a car parking area, shade tree planting is not required in this area of the car parking area.</p>	n/a	Not applicable - refer to comment for AO1.
	<p>AO4.2 Landscaping in car parking areas is designed in accordance with Planning Scheme Policy 6 - Landscaping and preferred plant species.</p>	n/a	Not applicable - refer to comment for AO1.
<p>PO5 Landscaping areas include a range and variety of planting that:</p>	<p>AO5.1 Plant species are selected from the Plant Schedule in Planning Scheme Policy 6 - Landscaping and preferred plant species.</p>	n/a	Not applicable - refer to comment for AO1.

Performance outcomes	Acceptable outcomes	Complies	Comments
<p>(a) is suitable for the intended purpose and local conditions;</p> <p>(b) contributes to the natural character of the Shire;</p> <p>(c) includes native species;</p> <p>(d) includes locally endemic species, where practical; and</p> <p>(e) does not include invasive plants or weeds.</p>	<p>AO5.2 A minimum of 25% of (new and existing) plants is provided as larger, advanced stock with a minimum plant height of 0.7 metres and mulched to a minimum depth of 0.1 metres with organic mulch.</p>	n/a	Not applicable - refer to comment for AO1.
<p>PO6 Landscaping does not impact on the ongoing provision of infrastructure and services to the Shire.</p>	<p>AO6.1 Tree planting is a minimum of</p> <p>(a) 2 metres from any underground water, sewer, gas, electricity or telecommunications infrastructure; and</p> <p>(b) 4 metres from any inspection chamber.</p>	n/a	Not applicable - refer to comment for AO1.
	<p>AO6.2 Vegetation below or within 4 metres of overhead electricity lines and power poles has a maximum height of 3.5 metres at maturity.</p>	n/a	Not applicable - refer to comment for AO1.
	<p>AO6.3 Vegetation adjoining an electricity substation boundary, at maturity, will have:</p> <p>(a) a height of less than 4 metres; and</p> <p>(b) no foliage within 3 metres of the substation boundary, unless the substation has a solid wall along any boundary.</p>	n/a	Not applicable - refer to comment for AO1.
For assessable development			

Performance outcomes	Acceptable outcomes	Complies	Comments
<p>PO7 Landscaping areas are designed to:</p> <ul style="list-style-type: none"> (a) be easily maintained throughout the ongoing use of the site; (b) allow sufficient area and access to sunlight and water for plant growth; (c) not cause a nuisance to occupants of the site or members of the public; and (d) maintain or enhance the safety of pedestrians through the use of Crime Prevention Through Environmental Design principles. 	<p>AO7 No acceptable outcome is provided.</p>	<p>n/a</p>	<p>Not applicable - refer to comment for AO1.</p>

Table 9.4.2.3B—Side and rear boundary landscape treatments

Location or use	Landscape Strip Minimum Width	Screen Fencing Minimum Height	Extent of treatment
Where car parking, servicing or manoeuvring areas adjoin a side or rear boundary	1 metre	Not applicable	To the extent these areas adjoin the boundary
Where involving a use other than a dwelling house on a site with a common boundary with land in the Low density residential zone, the Medium density residential zone or the Rural residential zone:	1.5 metres	1.8 metres	Along the common boundary.
Development for an industrial activity which has a common boundary with land not within the Industry zone	2 metres	1.8 metres	Along the common boundary
Development involving (a) Tourist park not in the Rural zone (b) Sales office (c) Multiple dwelling (d) Residential care facility; or (e) Dual occupancy	Not applicable	1.8 metres	Along all side and rear boundaries and between dwellings for a Dual occupancy.
Development involving (a) Tourist park in the Rural zone (b) Service station (c) Car wash; or (d) Utility installation	2 metres	Not applicable	Along all side and rear boundaries
For: (a) waste storage; (b) equipment; (c) servicing areas; and (d) private open space and site facilities associated with Caretaker's accommodation.	Not applicable	1.8 metres	To prevent visibility

Note—Where more than one landscape treatment is applicable to a development in the above table, the development is to provide a landscape treatment that satisfies all applicable minimum specifications.

9.4.3 Parking and access code

9.4.3.1 Application

This code applies to assessing development where it is identified in the assessment benchmarks for assessable development and requirements for accepted development column of an assessment table in Part 5 of the planning scheme.

9.4.3.2 Purpose

- (1) The purpose of the Parking and access code is to ensure:
 - (a) parking areas are appropriately designed, constructed and maintained;
 - (b) the efficient functioning of the development and the local road network; and
 - (c) all development provides sufficient parking, loading/service and manoeuvring areas to meet the demand generated by the use.

- (2) The purpose of the code will be achieved through the following overall outcomes:
 - (a) Land uses have a sufficient number of parking and bicycle spaces designed in a manner to meet the requirements of the user;
 - (b) Parking spaces and associated manoeuvring areas are safe, functional and provide equitable access;
 - (c) Suitable access for all types of vehicles likely to utilise a parking area is provided in a way that does not compromise the safety and efficiency of the surrounding road network;
 - (d) Premises are adequately serviced to meet the reasonable requirements of the development; and
 - (e) End of trip facilities are provided by new major developments to facilitate alternative travel modes.

9.4.3.3 Criteria for assessment

Table 9.4.3.3A—Parking and access code – For accepted development subject to requirements and assessable development

Performance outcomes	Acceptable outcomes	Complies	Comments
For accepted development subject to requirements and assessable development			
Car parking spaces			

Performance outcomes	Acceptable outcomes	Complies	Comments
<p>PO1 Development provides sufficient car parking to accommodate the demand likely to be generated by the use, having regard to the:</p> <ul style="list-style-type: none"> (a) nature of the use; (b) location of the site; (c) proximity of the use to public transport services; (d) availability of active transport infrastructure; and (e) accessibility of the use to all members of the community. 	<p>AO1 The number of car parking spaces provided for the use is in accordance with Table 9.4.3.3B.</p> <p>Note—Car parking spaces provided for persons with a disability are to be considered in determining compliance with AO1.</p>	n/a	Not applicable - The proposed development is for a 1 into 2 lot subdivision within a urban area. Each vacant lot is large enough to accommodate a dwelling and that dwelling will be required to include 1 undercover car parking space in-line with this code.
Vehicle crossovers			
<p>PO2 Vehicle crossovers are provided to::</p> <ul style="list-style-type: none"> (a) ensure safe and efficient access between the road and premises; (b) minimize interference with the function and operation of roads; and (c) minimise pedestrian to vehicle conflict. 	<p>AO2.1 Vehicular access to/from Council roads is designed and constructed in accordance with the Standard drawings in Planning Scheme Policy 4 - FNQROC Regional Development Manual.</p>	✓	Will be conditioned to comply.
	<p>AO2.2 Development on a site with two or more road frontages provides vehicular access from:</p> <ul style="list-style-type: none"> (a) the primary frontage where involving Community activities or Sport and recreation activities, unless the primary road frontage is a State-controlled road; or (b) from the lowest order road in all other instances. 	n/a	Not applicable.

Performance outcomes	Acceptable outcomes	Complies	Comments
	AO2.3 Vehicular access for particular uses is provided in accordance with Table 9.4.3.3E .	✓	Will be conditioned to comply where relevant.
PO3 Access, manoeuvring and car parking areas include appropriate pavement treatments having regard to: (a) the intensity of anticipated vehicle movements; (b) the nature of the use that they service; and (c) the character of the surrounding locality.	AO3 Access, manoeuvring and car parking areas include pavements that are constructed in accordance with Table 9.4.3.3C .	n/a	Not applicable.
For assessable development			
Parking area location and design			
PO4 Car parking areas are located and designed to: (a) ensure safety and efficiency in operation; and (b) be consistent with the character of the surrounding locality.	AO4.1 Car parking spaces, access and circulation areas have dimensions in accordance with AS/NZS 2890.1 Off-street car parking.	n/a	Not applicable.
	AO4.2 Disabled access and car parking spaces are located and designed in accordance with AS/NZS 2890.6 Parking facilities - Off-street parking for people with disabilities.	n/a	Not applicable.
	AO4.3 The car parking area includes designated pedestrian routes that provide connections to building entrances.	n/a	Not applicable.

Performance outcomes	Acceptable outcomes	Complies	Comments
	<p>AO4.4 Parking and any set down areas are:</p> <p>(a) wholly contained within the site;</p> <p>(b) visible from the street where involving Commercial activities, Community activities, Industrial activities or a use in the Recreation and open space zone;</p> <p>(c) are set back behind the main building line where involving a Dual occupancy, Multiple dwelling, Residential care facility or Retirement facility; and</p> <p>(d) provided at the side or rear of a building in all other instances.</p>	n/a	Not applicable.
Site access and manoeuvring			

Performance outcomes	Acceptable outcomes	Complies	Comments
<p>PO5 Access to, and manoeuvring within, the site is designed and located to:</p> <p>(a) ensure the safety and efficiency of the external road network;</p> <p>(b) ensure the safety of pedestrians;</p> <p>(c) provide a functional and convenient layout; and</p> <p>(d) accommodate all vehicles intended to use the site.</p>	<p>AO5.1 Access and manoeuvrability is in accordance with :</p> <p>(a) AS28901 – Car Parking Facilities (Off Street Parking); and</p> <p>(b) AS2890.2 – Parking Facilities (Off-street Parking) Commercial Vehicle Facilities.</p> <p>Note—Proposal plans should include turning circles designed in accordance with AP34/95 (Austroads 1995) Design Vehicles and Turning Path Templates.</p>	n/a	Not applicable.
	<p>AO5.2 Vehicular access has a minimum sight distance in accordance with Part 5 of AUSTRROADS.</p>	✓	Will comply.
	<p>AO5.3 Vehicular access is located and designed so that all vehicles enter and exit the site in a forward gear.</p>	✓	Will comply.
	<p>AO5.4 Pedestrian and cyclist access to the site:</p> <p>(a) is clearly defined;</p> <p>(b) easily identifiable; and</p> <p>(c) provides a connection between the site frontage and the entrance to buildings and end of trip facilities (where provided).</p>	n/a	Not applicable.

Performance outcomes	Acceptable outcomes	Complies	Comments
<p>PO6 Development that involves an internal road network ensures that it's design:</p> <p>(a) ensure safety and efficiency in operation;</p> <p>(b) does not impact on the amenity of residential uses on the site and on adjoining sites, having regard to matters of:</p> <p>(i) hours of operation;</p> <p>(ii) noise</p> <p>(iii) light; and</p> <p>(iv) odour;</p> <p>(c) accommodates the nature and volume of vehicle movements anticipated to be generated by the use;</p> <p>(d) allows for convenient access to key on-site features by pedestrians, cyclists and motor vehicles; and</p> <p>(e) in the Rural zone, avoids environmental degradation.</p>	<p>AO6.1 Internal roads for a Tourist park have a minimum width of:</p> <p>(a) 4 metres if one way; or</p> <p>(b) 6 metres if two way.</p>	n/a	Not applicable.
	<p>AO6.2 For a Tourist park, internal road design avoids the use of cul-de-sacs in favour of circulating roads, where unavoidable, cul-de-sacs provide a full turning circle for vehicles towing caravans having:</p> <p>(a) a minimum approach and departure curve radius of 12 metres; and</p> <p>(b) a minimum turning circle radius of 8 metres.</p>	n/a	Not applicable.
	<p>AO6.3 Internal roads are imperviously sealed and drained, apart from those for an Energy and infrastructure activity or Rural activity.</p>	n/a	Not applicable.
	<p>AO6.4 Speed control devices are installed along all internal roads, apart from those for an Energy and infrastructure activity or Rural activity, in accordance with Complete Streets.</p>	n/a	Not applicable.

Performance outcomes	Acceptable outcomes	Complies	Comments
	<p>AO6.5 Internal roads, apart from those for an Energy and infrastructure activity or Rural activity, are illuminated in accordance with AS 4282 (as amended) - Control of Obtrusive effects of outdoor lighting.</p>	n/a	Not applicable.
	<p>AO6.6 Where involving an accommodation activity, internal roads facilitate unobstructed access to every dwelling, accommodation unit, accommodation site and building by emergency services vehicles.</p>	n/a	Not applicable.
	<p>AO6.7 For an Energy and infrastructure activity or Rural activity, internal road gradients: (a) are no steeper than 1:5; or (b) are steeper than 1:5 and are sealed.</p>	n/a	Not applicable.
Servicing			

Performance outcomes	Acceptable outcomes	Complies	Comments
<p>PO7 Development provides access, maneuvering and servicing areas on site that:</p> <p>(a) accommodate a service vehicle commensurate with the likely demand generated by the use;</p> <p>(b) do not impact on the safety or efficiency of internal car parking or maneuvering areas;</p> <p>(c) do not adversely impact on the safety or efficiency of the road network;</p> <p>(d) provide for all servicing functions associated with the use; and</p> <p>(e) are located and designed to minimise their impacts on adjoining sensitive land uses and streetscape quality.</p>	<p>AO7.1 All unloading, loading, service and waste disposal areas are located:</p> <p>(a) on the site;</p> <p>(b) to the side or rear of the building, behind the main building line;</p> <p>(c) not adjacent to a site boundary where the adjoining property is used for a sensitive use.</p>	n/a	Not applicable.
	<p>AO7.2 Unloading, loading, service and waste disposal areas allow service vehicles to enter and exit the site in a forward gear.</p>	n/a	Not applicable.
	<p>AO7.3 Development provides a servicing area, site access and maneuvering areas to accommodate the applicable minimum servicing vehicle specified in Table 9.4.3.3B.</p>	n/a	Not applicable.
Maintenance			
<p>PO8 Parking areas are used and maintained for their intended purpose.</p>	<p>AO8.1 Parking areas are kept and used exclusively for parking and are maintained in a suitable condition for parking and circulation of vehicles.</p>	n/a	Not applicable.

Performance outcomes	Acceptable outcomes	Complies	Comments
	<p>AO8.2 All parking areas will be compacted, sealed, drained, line marked and maintained until such time as the development ceases.</p>	n/a	Not applicable.
End of trip facilities			
<p>PO9 Development within the Centre zone; Industry zone or Emerging community zone provides facilities for active transport users that:</p> <p>(a) meet the anticipated demand generated from the use;</p> <p>(b) comprise secure and convenient bicycle parking and storage; and</p> <p>(c) provide end of trip facilities for all active transport users.</p>	<p>AO9.1 The number of bicycle parking spaces provided for the use is in accordance with Table 9.4.3.3D.</p>	n/a	Not applicable.
	<p>AO9.2 End of trip facilities are provided in accordance with Table 9.4.3.3D.</p>	n/a	Not applicable.
If for Educational establishment or Child care centre where involving more than 100 vehicle movements per day or Renewable energy facility, Sport and recreation activities or Tourist park			
<p>PO10 The level of traffic generated by the development on the surrounding local road network must not result in unacceptable impacts on adjacent land and local road users.</p>	<p>AO10 A traffic impact report is prepared by a suitably qualified person that identifies:</p> <p>(a) the expected traffic movements to be generated by the facility;</p> <p>(b) any associated impacts on the road network; and</p> <p>(c) any works that will be required to address the identified impacts.</p>	n/a	Not applicable.
If for Educational establishment or Child care centre where involving more than 100 vehicle movements per day or Renewable energy facility, Sport and recreation activities or Tourist park			

Performance outcomes	Acceptable outcomes	Complies	Comments
<p>PO11 The level of traffic generated by the development on the surrounding local road network must not result in unacceptable impacts on adjacent land and local road users.</p>	<p>AO11 A traffic impact report is prepared by a suitably qualified person that identifies:</p> <ul style="list-style-type: none"> (d) the expected traffic movements to be generated by the facility; (e) any associated impacts on the road network; and (f) any works that will be required to address the identified impacts. 	<p>n/a</p>	<p>Not applicable.</p>

Table 9.4.3.3C—Pavement Standards for Access, Manoeuvring and Car Parking areas

Zone	Compacted Gravel Base (minimum thickness)	Surfacing Options
All development other than dwelling house		
All zones other than the Conservation zone or the Rural zone	75mm	Reinforced concrete with a minimum thickness of: <ul style="list-style-type: none"> • 100mm for parking areas; and • 150mm for access ways.
	150mm	Asphalt with a minimum thickness of 25mm
	150mm	Two coat sprayed bitumen seal
	150mm	Concrete pavers
Conservation zone or Rural zone	Not applicable	Minimum 150mm thickness compacted gravel suitable for all weather and dust free
Dwelling house		
All zones	75mm	Reinforced concrete with a minimum thickness of: <ul style="list-style-type: none"> • 100mm for parking areas; and • 150mm for access ways.
	150mm	Asphalt with a minimum thickness of 25mm
	150mm	Two coat sprayed bitumen seal
	150mm	Concrete pavers
	Not applicable	Minimum 150mm thickness compacted gravel suitable for all weather and dust free

Note—Where more than one surfacing option is listed, any one of the treatments listed may be provided.

Table 9.4.3.3E—Vehicular Access for Specific Uses

Use	Design
Dwelling house	A secondary dwelling shares a vehicle crossover with the Dwelling house.
Car wash	Site access involves: (a) a maximum width of 9 metres of any vehicle crossover across a footpath;
Service station	(b) a minimum separation of 12 metres between any vehicle crossover and a road intersection; (c) a separate entrance and exit; and (d) a minimum separation between vehicle crossovers of 14 metres.
Industrial activities	Each lot is provided with no more than one access point every 15 metres.
Roadside stall	A single vehicular access point is provided to the site.
Tourist park	(a) a single vehicular access point is provided to the site; and (b) no accommodation site has individual vehicular access.

9.4.4 Reconfiguring a lot code

9.4.4.1 Application

- (1) This code applies to assessing development where:
 - (a) for Reconfiguring a lot; and
 - (b) it is identified in the assessment benchmarks for assessable development and requirements for accepted development column of an assessment table in Part 5 of the planning scheme.

9.4.4.2 Purpose

- (1) The purpose of the Reconfiguring a lot code is to ensure that land is:
 - (a) arranged in a manner which is consistent with the intended scale and intensity of development within the area;
 - (b) provided with access to appropriate movement and open space networks; and
 - (c) contributes to housing diversity and accommodates a range of land uses.
- (2) The purpose of the code will be achieved through the following overall outcomes:
 - (a) Subdivision of land achieves the efficient use of land and the efficient provision of infrastructure and transport services;
 - (b) Lots are of a suitable size and shape for the intended or potential use having regard to the purpose and overall outcomes of the relevant zone or precinct.
 - (c) Subdivision of land creates lots with sufficient area and dimensions to accommodate the ultimate use, meet user requirements, protect environmental features and account for site constraints;
 - (d) A range and mix of lot sizes is provided to facilitate a variety of industry and housing types;
 - (e) Subdivision design incorporates a road network that provides connectivity and circulation for vehicles and provide safe and efficient access for pedestrians, cyclists and public transport;
 - (f) Subdivision design provides opportunities for walking and cycling for recreation and as alternative methods of travel;
 - (g) Subdivision of land provides and integrates a range of functional parkland, including local and district parks and open space links for the use and enjoyment of the residents of the locality and the shire;
 - (h) Subdivision of land contributes to an open space network that achieves connectivity along riparian corridors and between areas with conservation values;
 - (i) Subdivision within the Rural zone maintains rural landholdings in viable parcels;
 - (j) Land in historical townships is not reconfigured to be used for urban purposes; and
 - (k) Residential subdivision and greenfield development is designed to consider and respect:
 - i. topography;
 - ii. climate responsive design and solar orientation;
 - iii. efficient and sustainable infrastructure provision;
 - iv. environmental values;
 - v. water sensitive urban design;
 - vi. good quality agricultural land; and
 - vii. the character and scale of surrounding development.

9.4.4.3 Criteria for assessment

Table 9.4.4.3A—Reconfiguring a lot code – For assessable development

Performance outcomes	Acceptable outcomes	Complies	Comments
Area and frontage of lots			
<p>PO1 Lots include an area and frontage that:</p> <ul style="list-style-type: none"> (a) is consistent with the design of lots in the surrounding area; (b) allows the desired amenity of the zone to be achieved; (c) is able to accommodate all buildings, structures and works associated with the intended land use; (d) allow the site to be provided with sufficient access; (e) considers the proximity of the land to: <ul style="list-style-type: none"> (i) centres; (ii) public transport services; and (iii) open space; and (f) allows for the protection of environmental features; and (g) accommodates site constraints. 	<p>AO1.1 Lots provide a minimum area and frontage in accordance with Table 9.4.4.3B.</p>	✓	Complies.
Existing buildings and easements			
<p>PO2 Reconfiguring a lot which contains existing land uses or existing buildings and structures ensures:</p> <ul style="list-style-type: none"> (a) new lots are of sufficient area and dimensions to accommodate existing land uses, buildings and structures; and (b) any continuing use is not compromised by the reconfiguration. 	<p>AO2.1 Each land use and associated infrastructure is contained within its individual lot.</p>	✓	Complies.
	<p>AO2.2 All lots containing existing buildings and structures achieve the setback requirements of the relevant zone.</p>	✓	Complies.

Performance outcomes	Acceptable outcomes	Complies	Comments
<p>PO3 Reconfiguring a lot which contains an existing easement ensures:</p> <p>(a) future buildings, structures and accessways are able to be sited to avoid the easement; and</p> <p>(b) the reconfiguration does not compromise the purpose of the easement or the continued operation of any infrastructure contained within the easement.</p>	<p>AO3 No acceptable outcome is provided.</p>	n/a	Not applicable.
Boundary realignment			
<p>PO4 The boundary realignment retains all attendant and existing infrastructure connections and potential connections.</p>	<p>AO4 No acceptable outcome is provided.</p>	n/a	Not applicable.
Access and road network			
<p>PO5 Access to a reconfigured lot (including driveways and paths) must not have an adverse impact on:</p> <p>(a) safety;</p> <p>(b) drainage;</p> <p>(c) visual amenity;</p> <p>(d) privacy of adjoining premises; and</p> <p>(e) service provision.</p>	<p>AO5 No acceptable outcome is provided.</p>	✓	Will be conditioned to comply.

Performance outcomes	Acceptable outcomes	Complies	Comments
<p>PO6 Reconfiguring a lot ensures that access to a lot can be provided that:</p> <ul style="list-style-type: none"> (a) is consistent with that provided in the surrounding area; (b) maximises efficiency and safety; and (c) is consistent with the nature of the intended use of the lot. <p>Note—The Parking and access code should be considered in demonstrating compliance with PO6.</p>	<p>AO6 Vehicle crossover and access is provided in accordance with the design guidelines and specifications set out in Planning Scheme Policy 4 – FNQROC Regional Development Manual.</p>	✓	Will be conditioned to comply.
<p>PO7 Roads in the Industry zone are designed having regard to:</p> <ul style="list-style-type: none"> (a) the intended use of the lots; (b) the existing use of surrounding land; (c) the vehicular servicing requirements of the intended use; (d) the movement and turning requirements of B-Double vehicles. <p>Note—The Parking and access code should be considered in demonstrating compliance with PO7.</p>	<p>AO7 No acceptable outcome is provided.</p>	n/a	Not applicable.
Rear lots			
<p>PO8 Rear lots are designed to:</p> <ul style="list-style-type: none"> (a) provide a high standard of amenity for residents and other users of the site; (b) provide a high standard of amenity for adjoining properties; and (c) not adversely affect the safety and efficiency of 	<p>AO8.1 Rear lots are designed to facilitate development that adjoins or overlooks a park or open space.</p>	n/a	Not applicable.
	<p>AO8.2 No more than two rear lots are created behind any lot with a road frontage.</p>	n/a	Not applicable.

Performance outcomes	Acceptable outcomes	Complies	Comments
the road from which access is gained.	<p>AO8.3 Access to lots is via an access strip with a minimum width of:</p> <p>(a) 4 metres where in the Low density residential zone or Medium density residential zone; or</p> <p>(b) 8 metres otherwise.</p>	n/a	Not applicable.
	<p>AO8.4 A single access strip is provided to a rear lot along one side of the lot with direct frontage to the street.</p> <p>Note—Figure A provides further guidance in relation to the desired outcome.</p>	n/a	Not applicable.
	<p>AO8.5 No more than 1 in 10 lots created in a new subdivision are rear lots.</p>	n/a	Not applicable.
	<p>AO8.6 Rear lots are not created in the Centre zone or the Industry zone.</p>	n/a	Not applicable.
Crime prevention and community safety			

Performance outcomes	Acceptable outcomes	Complies	Comments
<p>PO9 Development includes design features which enhance public safety and seek to prevent opportunities for crime, having regard to:</p> <ul style="list-style-type: none"> (a) sightlines; (b) the existing and intended pedestrian movement network; (c) the existing and intended land use pattern; and (d) potential entrapment locations. 	<p>AO9 No acceptable outcome is provided.</p>	n/a	Not applicable.
Pedestrian and cycle movement network			
<p>PO10 Reconfiguring a lot must assist in the implementation of a Pedestrian and cycle movement network to achieve safe, attractive and efficient pedestrian and cycle networks.</p>	<p>AO10 No acceptable outcome is provided.</p>	n/a	Not applicable.
Public transport network			
<p>PO11 Where a site includes or adjoins a future public transport corridor or future public transport site identified through a structure planning process, development:</p> <ul style="list-style-type: none"> (a) does not prejudice the future provision of the identified infrastructure; (b) appropriately treats the common boundary with the future corridor; and (c) provides opportunities to integrate with the adjoining corridor where a it will include an element which will attract pedestrian movement. 	<p>AO11 No acceptable outcome is provided.</p>	n/a	Not applicable.
Residential subdivision			

Performance outcomes	Acceptable outcomes	Complies	Comments
<p>PO12 Residential lots are:</p> <p>(a) provided in a variety of sizes to accommodate housing choice and diversity; and</p> <p>(b) located to increase variety and avoid large areas of similar lot sizes.</p>	<p>AO12 No acceptable outcome is provided.</p>	n/a	Not applicable.
Rural residential zone			
<p>PO13 New lots are only created in the Rural residential zone where land is located within the 4,000m² precinct, the 1 hectare precinct or the 2 hectare precinct.</p>	<p>AO13 No acceptable outcome is provided.</p>	n/a	Not applicable.
Additional provisions for greenfield development only			
<p>PO14 The subdivision design provides the new community with a local identity by responding to:</p> <p>(a) site context</p> <p>(b) site characteristics</p> <p>(c) setting</p> <p>(d) landmarks</p> <p>(e) natural features; and</p> <p>(f) views.</p>	<p>AO14 No acceptable outcome provided.</p>	n/a	Not applicable.
<p>PO15 The road network is designed to provide a high level of connectivity, permeability and circulation for local vehicles, public transport, pedestrians and cyclists.</p>	<p>AO15 No acceptable outcome provided.</p>	n/a	Not applicable.

Performance outcomes	Acceptable outcomes	Complies	Comments
<p>PO16 The road network is designed to:</p> <ul style="list-style-type: none"> (a) minimise the number of cul-de-sacs; (b) provide walkable catchments for all residents in cul-de-sacs; and (c) include open cul-de-sacs heads. <p>Note—Figure B provides further guidance in relation to the desired outcome.</p>	<p>AO16 No acceptable outcome provided.</p>	n/a	Not applicable.
<p>PO17 Reconfiguring a lot provides safe and convenient access to the existing or future public transport network.</p>	<p>AO17 The subdivision locates 90% of lots within 400 metres walking distance of a future public transport route.</p>	n/a	Not applicable.
<p>PO18 The staging of the lot reconfiguration prioritises delivery of link roads to facilitate efficient bus routes.</p>	<p>AO18 No acceptable outcome provided.</p>	n/a	Not applicable.
<p>PO19 Provision is made for sufficient open space to:</p> <ul style="list-style-type: none"> (a) meet the needs of the occupiers of the lots and to ensure that the environmental and scenic values of the area are protected; (b) retain riparian corridors, significant vegetation and habitat areas and provides linkages between those areas; and (c) meet regional, district and neighbourhood open space requirements. 	<p>AO19.1 A minimum of 10% of the site area is dedicated as open space.</p>	n/a	Not applicable.
	<p>AO19.2 A maximum of 30% of the proposed open space can consist of land identified as significant vegetation or riparian corridor buffer.</p>	n/a	Not applicable.

Performance outcomes	Acceptable outcomes	Complies	Comments
<p>PO20 A network of parks and community land is provided:</p> <p>(a) to support a full range of recreational and sporting activities;</p> <p>(b) to ensure adequate pedestrian, cycle and vehicle access;</p> <p>(c) which is supported by appropriate infrastructure and embellishments;</p> <p>(d) to facilitate links between public open spaces;</p> <p>(e) which is co-located with other existing or proposed community infrastructure;</p> <p>(f) which is consistent with the preferred open space network; and</p> <p>(g) which includes a diversity of settings;</p>	<p>AO20 No acceptable outcome is provided.</p>	n/a	Not applicable.

Table 9.4.4.3B—Minimum area and dimensions for Reconfiguring a lot

Zone	Type	Minimum area	Minimum frontage
Centre	All lots	800m ²	20 metres
Community facilities	All lots	Not specified	Not specified
Conservation	All lots	Not specified	Not specified
Emerging community	All lots	10 hectares	100 metres
Low density residential	Where greenfield development and connected to reticulated water and sewerage		
	Rear lot	800m ²	5 metres
	All other lots	350m ²	10 metres
	Where connected to reticulated water and sewerage		
	Rear lot	800m ²	5 metres
	All other lots	600m ²	16 metres
	Where connected to reticulated water		
	Rear lot	1,000m ²	5 metres
	All other lots	800m ²	16 metres
Medium density residential	Rear lot	600m ²	5 metres
	All other lots	400m ²	10 metres
Industry	All lots	1,500m ²	45 metres

Zone	Type	Minimum area	Minimum frontage
Recreation and open space	All lots	Not specified	Not specified
Rural	All lots	60 hectares	400 metres
Rural residential	2 hectare precinct		
	All lots	2 hectares	60 metres
	1 hectare precinct		
	All lots	1 hectare	40 metres
	4,000m ² precinct		
	All lots	4,000m ²	40 metres

Figure A – Examples of access to rear lots

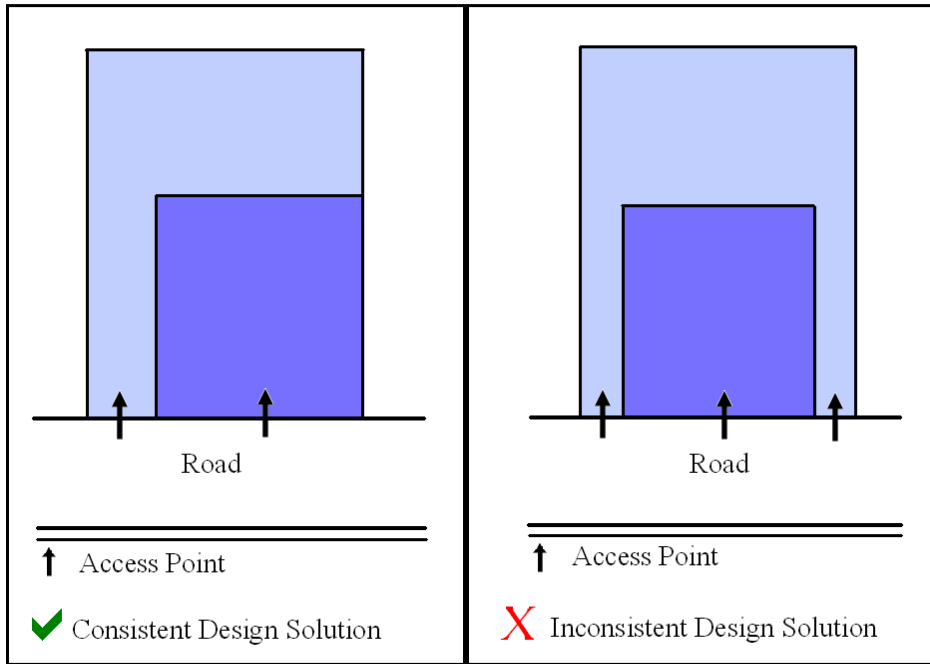
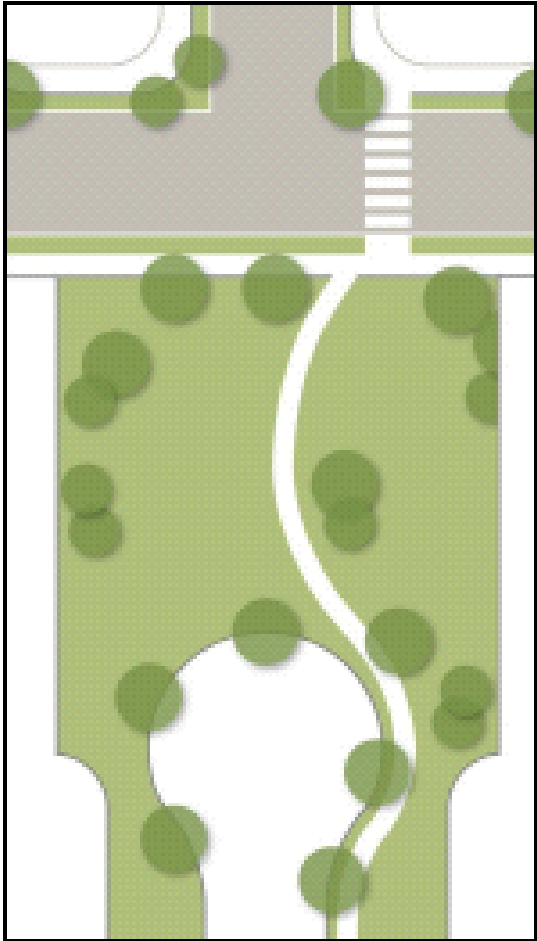

Figure B – Example of cul-de-sac design



9.4.5 Works, services and infrastructure code

9.4.5.1 Application

- (1) This code applies to assessing development where it is identified in the assessment benchmarks for assessable development and requirements for accepted development column of an assessment table in Part 5 of the planning scheme.

9.4.5.2 Purpose

- (1) The purpose of the Works, services and infrastructure code is to ensure that all development is appropriately serviced by physical infrastructure, public utilities and services and that work associated with development is carried out in a manner that does not adversely impact on the surrounding area.
- (2) The purpose of the code will be achieved through the following overall outcomes:
 - (a) Development provides an adequate, safe and reliable supply of potable, fire-fighting and general use water in accordance with relevant standards;
 - (b) Development provides for the treatment and disposal of wastewater and ensures there are no adverse impacts on water quality, public health, local amenity or ecological processes;
 - (c) Development provides for the disposal of stormwater and ensures that there are no adverse impacts on water quality or ecological processes;
 - (d) Development connects to the road network and any adjoining public transport, pedestrian and cycle networks while ensuring no adverse impacts on the safe, convenient and efficient operation of these networks;
 - (e) Development provides electricity and telecommunications services that meet its desired requirements;
 - (f) Development is connected to a nearby electricity network with adequate capacity without significant environment, social or amenity impact;
 - (g) Development does not affect the efficient functioning of public utility mains, services or installations;
 - (h) Infrastructure dedicated to Council is cost effective over its life cycle;
 - (i) Work associated with development does not cause adverse impacts on the surrounding area; and
 - (j) Development prevents the spread of weeds, seeds or other pests.

9.4.5.3 Criteria for assessment

Table 9.4.5.3 - Works, services and infrastructure code – For accepted development subject to requirements and assessable development

Performance outcomes	Acceptable outcomes	Complies	Comments
For accepted development subject to requirements and assessable development			
Water supply			

Performance outcomes	Acceptable outcomes	Complies	Comments
<p>PO1 Each lot has an adequate volume and supply of water that:</p> <ul style="list-style-type: none"> (a) meets the needs of users; (b) is adequate for fire-fighting purposes; (c) ensures the health, safety and convenience of the community; and (d) minimises adverse impacts on the receiving environment. 	<p>AO1.1 Development is connected to a reticulated water supply system in accordance with the Design Guidelines and Specifications set out in the Planning Scheme Policy 4 – FNQROC Regional Development Manual other than where located:</p> <ul style="list-style-type: none"> (a) in the Conservation zone, Rural zone or Rural residential zone; and (b) outside a reticulated water supply service area. 	✓	Will be conditioned to comply.
	<p>AO1.2 Development, where located outside a reticulated water supply service area and in the Conservation zone, Rural zone or Rural residential zone is provided with:</p> <ul style="list-style-type: none"> (a) a bore or bores are provided in accordance with the Design Guidelines set out in the Planning Scheme Policy 4 – FNQROC Regional Development Manual; or (b) on-site water storage tank/s: <ul style="list-style-type: none"> (i) with a minimum capacity of 90,000L; (ii) fitted with a 50mm ball valve with a camlock fitting; and (iii) which are installed and connected prior to the occupation or use of the development. 	n/a	Not applicable.
Wastewater disposal			

Performance outcomes	Acceptable outcomes	Complies	Comments
<p>PO2 Each lot provides for the treatment and disposal of effluent and other waste water that:</p> <ul style="list-style-type: none"> (a) meets the needs of users; (b) is adequate for fire-fighting purposes; (c) ensures the health, safety and convenience of the community; and (d) minimises adverse impacts on the receiving environment. 	<p>AO2.1 Development is connected to a reticulated sewerage system in accordance with the Design Guidelines and Specifications set out in the Planning Scheme Policy 4 – FNQROC Regional Development Manual other than where located:</p> <ul style="list-style-type: none"> (a) in the Conservation zone, Rural zone or Rural residential zone; and (b) outside a reticulated sewerage service area. 	n/a	Not applicable.
	<p>AO2.2 An effluent disposal system is provided in accordance with ASNZ 1547 On-Site Domestic Wastewater Management (as amended) where development is located:</p> <ul style="list-style-type: none"> (a) in the Conservation zone, Rural zone or Rural residential zone; and (b) outside a reticulated sewerage service area. 	✓	Will be conditioned to comply at dwelling construction stage.
Stormwater infrastructure			
<p>PO3 Stormwater infrastructure is designed and constructed to collect and convey the design storm event to a lawful point of discharge in a manner that mitigates impacts on life and property.</p>	<p>AO3.1 Where located within a Priority infrastructure area or where stormwater infrastructure is available, development is connected to Council's stormwater network in accordance with the Design Guidelines and Specifications set out in the Planning Scheme Policy 4 – FNQROC Regional Development Manual.</p>	n/a	Not applicable.

Performance outcomes	Acceptable outcomes	Complies	Comments
	<p>AO3.2 On-site drainage systems are constructed:</p> <p>(a) to convey stormwater from the premises to a lawful point of discharge; and</p> <p>(b) in accordance with the Design Guidelines and Specifications set out in the Planning Scheme Policy 4 – FNQROC Regional Development Manual.</p>	✓	Will be conditioned to comply.
Electricity supply			
<p>PO4 Each lot is provided with an adequate supply of electricity</p>	<p>AO4 The premises:</p> <p>(a) is connected to the electricity supply network; or</p> <p>(b) has arranged a connection to the transmission grid; or</p> <p>(c) where not connected to the network, an independent energy system with sufficient capacity to service the development (at near average energy demands associated with the use) may be provided as an alternative to reticulated electricity where:</p> <p>(i) it is approved by the relevant regulatory authority; and</p> <p>(ii) it can be demonstrated that no air or noise emissions; and</p> <p>(iii) it can be demonstrated that no adverse impact on visual amenity will occur.</p>	✓	Will be conditioned to comply.
Telecommunications infrastructure			

Performance outcomes	Acceptable outcomes	Complies	Comments
PO5 Each lot is provided with an adequate supply of telecommunication infrastructure	A05 Development is provided with a connection to the national broadband network or telecommunication services.	✓	Will be conditioned to comply.
Existing public utility services			
PO6 Development and associated works do not affect the efficient functioning of public utility mains, services or installations.	A06 Public utility mains, services are relocated, altered or repaired in association with the works so that they continue to function and satisfy the relevant Design Guidelines and Specifications set out in the Planning Scheme Policy 4 – FNQROC Regional Development Manual.	✓	Can be conditioned to comply.
Excavation or filling			
PO7 Excavation or filling must not have an adverse impact on the: (a) streetscape; (b) scenic amenity; (c) environmental values; (d) slope stability; (e) accessibility; or (f) privacy of adjoining premises.	A07.1 Excavation or filling does not occur within 1.5 metres of any site boundary.	n/a	Not applicable.
	A07.2 Excavation or filling at any point on a lot is to be no greater than 1.5 metres above or below natural ground level.	n/a	Not applicable.
	A07.3 Earthworks batters: (a) are no greater than 1.5 metres in height; (b) are stepped with a minimum width 2 metre berm; (c) do not exceed a maximum of two batters and two berms (not greater than 3.6 metres in total height) on any one lot; (d) have a slope no greater than 1 in 4; and (e) are retained.	n/a	Not applicable.

Performance outcomes	Acceptable outcomes	Complies	Comments
	<p>AO7.4 Soil used for filling or spoil from excavation is not stockpiled in locations that can be viewed from:</p> <p>(a) adjoining premises; or (b) a road frontage, for a period exceeding 1 month from the commencement of the filling or excavation.</p>	n/a	Not applicable.
	<p>AO7.5 All batters and berms to be constructed in accordance with the Design Guidelines and Specifications set out in the Planning Scheme Policy 4 – FNQROC Regional Development Manual.</p>	n/a	Not applicable.
	<p>AO7.6 Retaining walls have a maximum height of 1.5 metres and are designed and constructed in accordance with the Design Guidelines and Specifications set out in the Planning Scheme Policy 4 – FNQROC Regional Development manual.</p>	n/a	Not applicable.
	<p>AO7.7 Excavation or filling at any point on a lot is to include measures that protect trees at the foot or top of cut or fill batters by the use of appropriate retaining methods and sensitive earth removal or placement and in accordance with the Design Guidelines and Specifications set out in the Planning Scheme Policy 4 – FNQROC Regional Development manual.</p>	n/a	Not applicable.
For assessable development			
Transport network			

Performance outcomes	Acceptable outcomes	Complies	Comments
PO8 The development has access to a transport network of adequate standard to provide for the safe and efficient movement of vehicles, pedestrians and cyclists.	A08.1 Vehicle access, crossovers, road geometry, pavement, utilities and landscaping to the frontage/s of the site are designed and constructed in accordance with the Design Guidelines and Specifications set out in the Planning Scheme Policy 4 – FNQROC Regional Development manual.	n/a	Not applicable.
	A08.2 Development provides footpath pavement treatments in accordance with Planning Scheme Policy 9 – Footpath Paving.	n/a	Not applicable.
Public infrastructure			
PO9 The design, construction and provision of any infrastructure that is to be dedicated to Council is cost effective over its life cycle and incorporates provisions to minimise adverse impacts.	A09 Development is in accordance with the Design Guidelines and Specifications set out in the Planning Scheme Policy 4 – FNQROC Regional Development Manual.	n/a	Not applicable.
Stormwater quality			

Performance outcomes	Acceptable outcomes	Complies	Comments
<p>PO10 Development has a non-worsening effect on the site and surrounding land and is designed to:</p> <ul style="list-style-type: none"> (a) optimise the interception, retention and removal of waterborne pollutants, prior to the discharge to receiving waters; (b) protect the environmental values of waterbodies affected by the development, including upstream, on-site and downstream waterbodies; (c) achieve specified water quality objectives; (d) minimise flooding; (e) maximise the use of natural channel design principles; (f) maximise community benefit; and (g) minimise risk to public safety. 	<p>AO10.1 The following reporting is prepared for all Material change of use or Reconfiguring a lot proposals:</p> <ul style="list-style-type: none"> (a) a Stormwater Management Plan and Report that meets or exceeds the standards of design and construction set out in the Queensland Urban Drainage Manual (QUDM) and the Design Guidelines and Specifications set out in the Planning Scheme Policy 4 – FNQROC Regional Development Manual; and (b) an Erosion and Sediment Control Plan that meets or exceeds the Soil Erosion and Sedimentation Control Guidelines (Institute of Engineers Australia), including: <ul style="list-style-type: none"> (i) drainage control; (ii) erosion control; (iii) sediment control; and (iv) water quality outcomes. 	<p>n/a</p>	<p>Not applicable for the scale of development proposed.</p>

Performance outcomes	Acceptable outcomes	Complies	Comments
	<p>AO10.2 For development on land greater than 2,500m² or that result in more than 5 lots or more than 5 dwellings or accommodation units, a Stormwater Quality Management Plan and Report prepared and certified by a suitably qualified design engineer (RPEQ) is prepared that demonstrates that the development:</p> <ul style="list-style-type: none"> (a) meets or exceeds the standards of design and construction set out in the Urban Stormwater Quality Planning Guideline and the Queensland Water Quality Guideline; (b) is consistent with any local area stormwater water management planning; (c) accounts for development type, construction phase, local climatic conditions and design objectives; and (d) provides for stormwater quality treatment measures reflecting land use constraints, such as soil type, landscape features (including landform), nutrient hazardous areas, acid sulfate soil and rainfall erosivity. 	n/a	Not applicable for the scale of development proposed.

Performance outcomes	Acceptable outcomes	Complies	Comments
<p>PO11 Storage areas for stormwater detention and retention:</p> <ul style="list-style-type: none"> (a) protect or enhance the environmental values of receiving waters; (b) achieve specified water quality objectives; (c) where possible, provide for recreational use; (d) maximise community benefit; and (e) minimise risk to public safety. 	<p>AO11 No acceptable outcome is provided.</p>	n/a	Not applicable.
Excavation or filling			
<p>PO12 Traffic generated by filling or excavation does not impact on the amenity of the surrounding area.</p>	<p>AO12.1 Haul routes used for transportation of fill to or from the site only use major roads and avoid residential areas.</p>	n/a	Not applicable.
	<p>AO12.2 Transportation of fill to or from the site does not occur:</p> <ul style="list-style-type: none"> (a) within peak traffic times; and (b) before 7am or after 6pm Monday to Friday; (c) before 7am or after 1pm Saturdays; and (d) on Sundays or Public Holidays. 	n/a	Not applicable.

Performance outcomes	Acceptable outcomes	Complies	Comments
PO13 Air pollutants, dust and sediment particles from excavation or filling, do not cause significant environmental harm or nuisance impacts.	AO13.1 Dust emissions do not extend beyond the boundary of the site.	n/a	Not applicable.
	AO13.2 No other air pollutants, including odours, are detectable at the boundary of the site.	n/a	Not applicable.
	AO13.3 A management plan for control of dust and air pollutants is prepared and implemented.	n/a	Not applicable.
PO14 Access to the premises (including driveways and paths) does not have an adverse impact on: <ul style="list-style-type: none"> (a) safety; (b) drainage; (c) visual amenity; and (d) privacy of adjoining premises. 	AO14 Access to the premises (including all works associated with the access): <ul style="list-style-type: none"> (a) must follow as close as possible to the existing contours; (b) be contained within the premises and not the road reserve, and (c) are designed and constructed in accordance with the Design Guidelines and Specifications set out in the Planning Scheme Policy 4 – FNQROC Regional Development manual. 	n/a	Not applicable.
Weed and pest management			
PO15 Development prevents the spread of weeds, seeds or other pests into clean areas or away from infested areas.	AO15 No acceptable outcome is provided.	n/a	Not applicable.
Contaminated land			

Performance outcomes	Acceptable outcomes	Complies	Comments
<p>PO16 Development is located and designed to ensure that users and nearby sensitive land uses are not exposed to unacceptable levels of contaminants</p>	<p>AO16 Development is located where: (a) soils are not contaminated by pollutants which represent a health or safety risk to users; or (b) contaminated soils are remediated prior to plan sealing, operational works permit, or issuing of building works permit.</p>	n/a	Not applicable.
Fire services in developments accessed by common private title			
<p>PO17 Fire hydrants are located in positions that will enable fire services to access water safely, effectively and efficiently.</p>	<p>AO17.1 Fire hydrants are located in accessways or private roads held in common private title at a maximum spacing of: (a) 120 metres for residential development; and (b) 90 metres for any other development.</p>	n/a	Not applicable.
	<p>AO17.2 Fire hydrants are located at all intersections of accessways or private roads held in common private title.</p>	n/a	Not applicable.