



24 February 2022

Council Officer: Carl Ewin
Direct Telephone: (07) 4086 4656
Our Reference: OPW/21/0001
Your Reference: 137-001-002L

Conmat No 2 Pty Ltd
C/- Benchmark Survey & Design
PO Box 1285
INNISFAIL QLD 4860

Dear Applicants,

Confirmation Notice

Planning Act 2016

Council acknowledges receipt of your application, which was properly made on 12 February 2022.

This Confirmation Notice has been prepared in accordance with the Development Assessment Rules and contains information relevant to the processing and assessment of the application. The following details are confirmed:

APPLICATION DETAILS

Application No:	OPW/21/0001
Proposal:	Application for Development Permit for Operational Works (Roadworks, Earthworks, Stormwater and Water Reticulation) for Stage 3 (11 lots) of Development Permit RAL/21/0012
Street Address:	Emerald End Road and Country Road, Mareeba
Real Property Description:	Lot 200 on SP323217
Planning Scheme:	Mareeba Shire Council Planning Scheme 2016

TYPE OF DEVELOPMENT

The application seeks development approval for:

- Operational Works (Roadworks, Earthworks, Stormwater and Water Reticulation) for Stage 3 (11 lots) of Development Permit REC/08/0096

SUPERSEDED PLANNING SCHEME

Is the application for development under the Superseded Planning Scheme? **No**

CODE ASSESSMENT

Will Code Assessment be required? Yes

The application will be assessed against the following development codes:

- Rural residential zone code
- Reconfiguring a lot code
- Works, services and infrastructure code

IMPACT ASSESSMENT

Will Impact Assessment be required? No

PUBLIC NOTIFICATION DETAILS

Is Public Notification Required? No

REFERRAL AGENCIES

Nil

INFORMATION REQUEST

Has the applicant advised on the approved form that the applicant does not agree to accept an Information Request? No

A further Information Request is made by the assessment manager, as detailed below:

1. Road A

- Confirm the proposed width of Road A as 7.5m.
- Provide further details about how stormwater will be managed at the temporary turnaround areas at the end of Country Road and Road A.

2. Intersection

Provide swept paths showing design vehicle (school bus 12.5 or 14m) for Country Road and Road A.

3. Proposed drainage easement within Lot 57

Council requires further treatment from the pipe outlet to creek/gully. This could possibly be in the form of a concrete invert to the gully with protection.

4. Emerald End Road Widening

- Drawing CRE17-018-C66 shows the Typical Cross Sections for the widening on Emerald End Road. Add a dimension on the sections that show the width between

the existing centreline on Emerald End Road and the Layback Kerb and Channel Invert/Edge of Bitumen Seal.

Emerald End Road is classed as a Rural Road Collector Major and therefore requires a 10m formation, so from the existing centreline to the Layback Kerb and Channel Invert/Edge of Bitumen Seal, should be 5.0m

- (ii) Detail how temporary arrangements will prevent drainage issues in this area with the table drain being lower than the new Kerb and Channel and therefore not being able to drain.

5. Water

To ensure that the 63mm return line can be isolated at the areas indicated below in orange, Council requires an addition sluice valve to be placed at both locations:

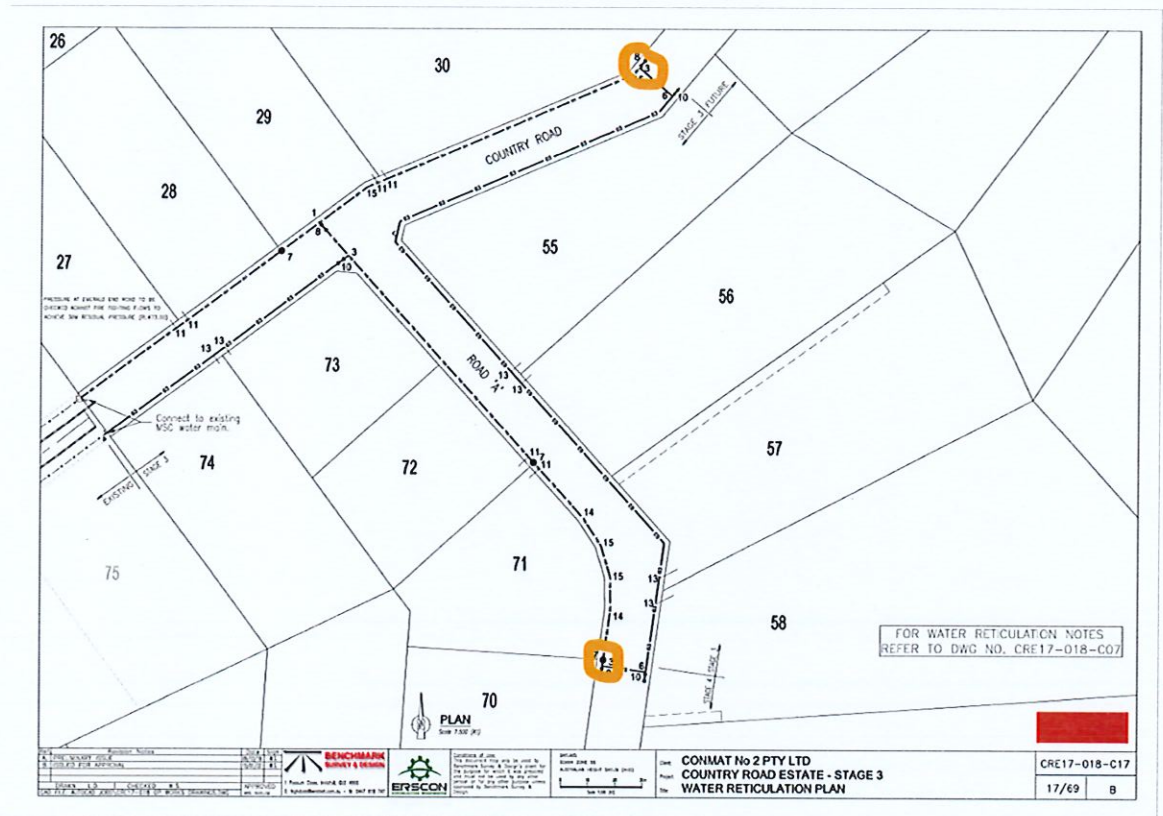

End of Information Request

In responding to the Information Request, *Development Assessment Rule 13* states: -

"13. Applicants Response

13.1 *The period for the applicant to respond to an information request is 3 months from the date the information request was made or a further period agreed between the applicant and the assessing authority that made the information request.*

13.2 *The applicant may respond by giving the assessing authority that made the information request, within the period stated under section 13.1 -*

- (a) *all of the information requested; or*
- (b) *part of the information requested; or*
- (c) *a notice that none of the information will be provided.*

13.3 *For any response given in accordance with sections 13.2(b) or (c), the applicant may also advise the assessing authority that it must proceed with its assessment of the application.*

13.4 *An applicant must provide a copy of any response to an information request made by a referral agency to the assessment manager."*

PROJECT TEAM

The contact details of the project team for your application are provided below. Your primary point of contact for any general enquires regarding this application is the project manager.

Project Manager (Planning)

Carl Ewin

(07) 4086 4656

OTHER DETAILS

You can follow the progress of this application online at www.msc.qld.gov.au

Should you have any further queries in relation to the above, please do not hesitate to contact Council's Planning Officer, Carl Ewin on the above number.

Yours faithfully



**BRIAN MILLARD
SENIOR PLANNER**